

MAIN GROUP

4

	Illustration
01 Front axle beam	15
05 Front suspension	15
11 Torsion springs	15
13 Shock absorber	15
15 Steering	16

- (1)
- | | |
|---------------|--|
| 113 401 025 | Front axle beam |
| 114 401 025 | Front axle beam (RHD) |
| 111 401 301 | Needle bearing - Torsion arm |
| 111 401 303 | Needle bearing, oversize - Torsion arm |
| 111 405 105 D | Torsion arm upper |
| 111 405 151 C | Torsion arm lower |
- (see Workshop Bulletin V/15 - V/20)

VG Front axle

- | | | |
|---------------|---|---|
| 111 401 303 | Needle bearing oversize - Torsion arm from chassis No. | X |
| 111 405 105 B | Torsion arm upper from chassis No. 1 117 054 up to | 2 |
| 111 405 105 D | Torsion arm upper from chassis No. | 2 |
| 111 405 151 A | Torsion arm lower from chassis No. 1 - 117 054 up to | 2 |

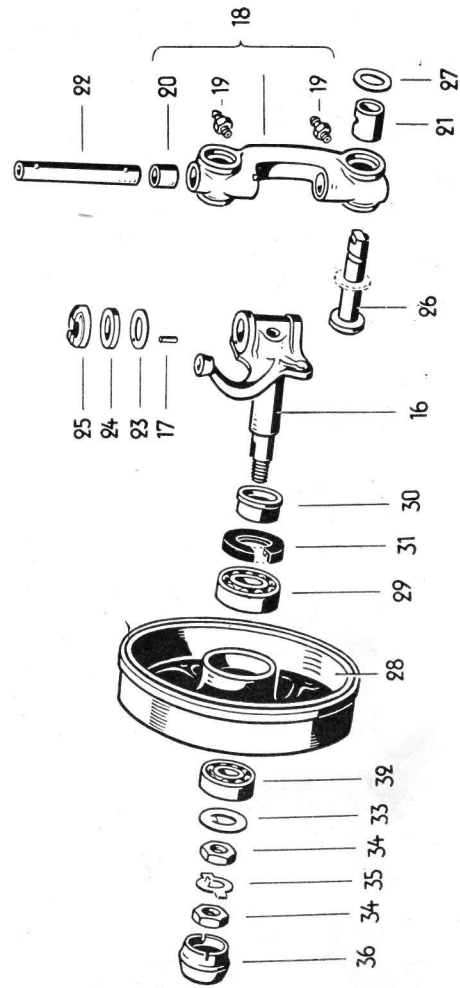
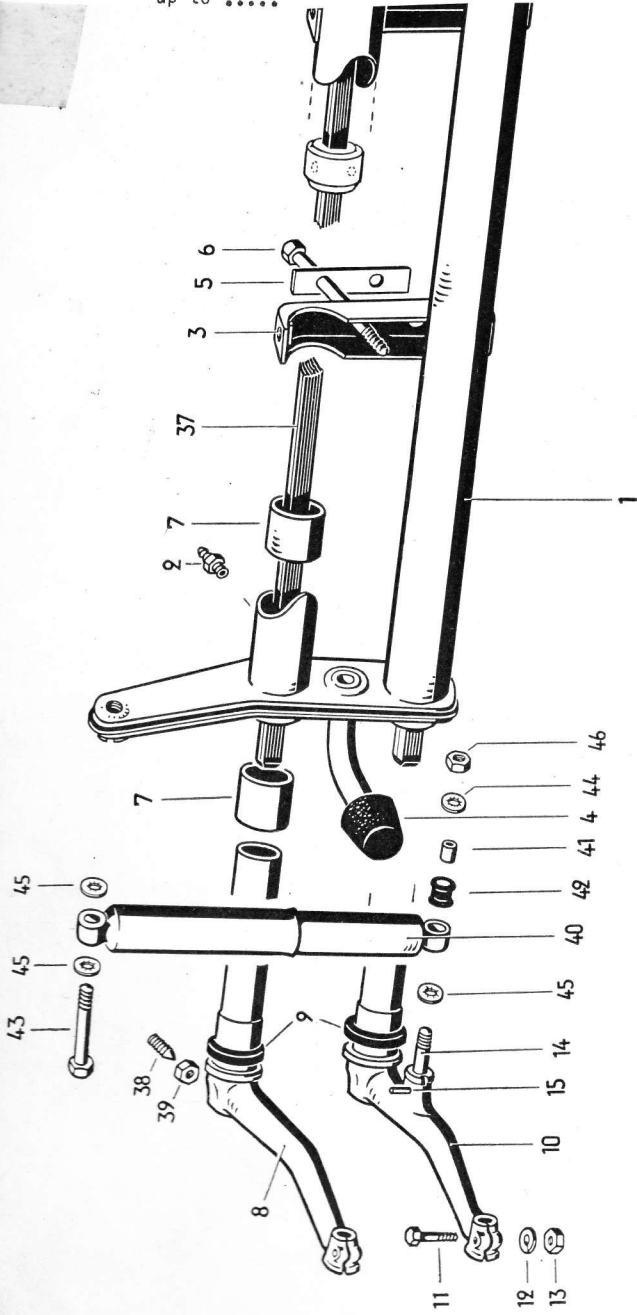

401 025	Front axle beam from chassis No. 1 - 397 023 up to	1	
401 025	Front axle beam from chassis No. <i>UP TO CHASSIS NO</i>	1	111, 113, 115, 117, 141, 143, 151
401 025	Front axle beam (RHD) from chassis No.	1	112, 114, 116, 118, 142, 144, 152
401 301	Needle bearing - Torsion arm from chassis No. <i>See underneath</i>	4	

111 401 303	Needle bearing oversize - Torsion arm from chassis No.	X
111 405 105 B	Torsion arm upper from chassis No. 1 117 054 up to	2
111 405 105 D	Torsion arm upper from chassis No.	2
111 405 151 A	Torsion arm lower from chassis No. 1 - 117 054 up to	2

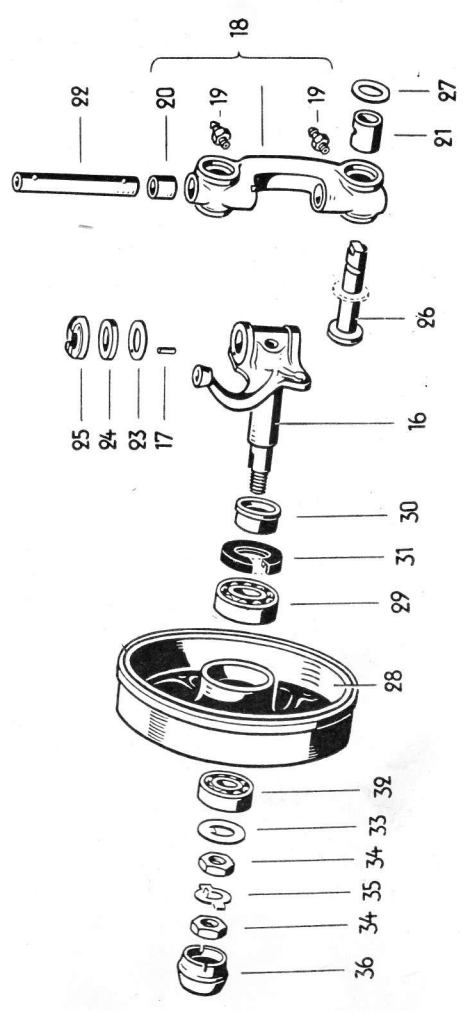
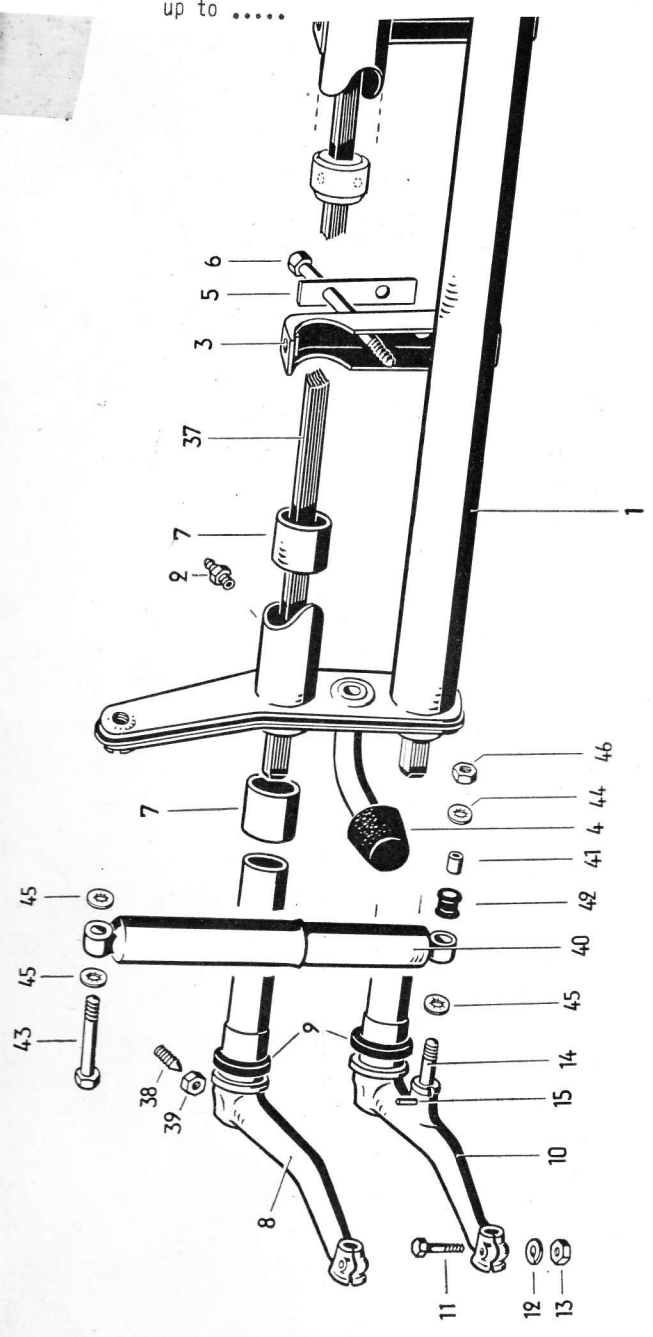

Supplied with cleaning bumper & stabilizer

MA	113 400 025 D	Front axle assy. (hydraulic brake) <i>ORDER 113 400 025 1E</i> up to chassis No.	1	113, 117, 151
	113 400 025 E	Front axle assy. (hydraulic brake) from chassis No.	1	113, 117, 151
	114 400 025 D	Front axle assy. (hydraulic brake, RHD) <i>ORDER 114 400 025 1E</i> up to chassis No.	1	114, 118, 152
	114 400 025 E	Front axle assy. (hydraulic brake, RHD) from chassis No.	1	114, 118, 152

-	111 400 025 C	Front axle assy. from chassis No. 1 - 397 023	1	111, 115
-	112 400 025 A	Front axle assy. (RHD) from chassis No. 1 - 397 023	1	112, 116
<i>Order</i>	113 400 025 C 113 400 025 D	Front axle assy. (hydraulic brake) from chassis No. 1 673 411 <i>UP TO CHASSIS No.</i>	1	113, 117, 151
<i>Order</i>	114 400 025 C 114 400 025 E	Front axle assy. (hydraulic brake, RHD) from chassis No. 1 673 411	1	114, 118, 152
	<i>114 400 025 A Superseded by single parts</i>			

FRONT AXLE BEAM

-	111 401 021	Front axle beam <i>NOT AVAILABLE</i> up to chassis No. 1 - 117 053	1	111, 112
-	111 401 021 A	Front axle beam from chassis No. 1 - 117 054 up to 1 - 397 022	1	
1	111 401 025	Front axle beam from chassis No. 1 - 397 023	1	
2	N 18 530 1	Grease nipple - Beam	4	
-	111 401 161	Threaded bush - Front axle beam support up to chassis No. 1 - 397 022	2	
3	111 401 161 A	Threaded bush - Front axle beam support from chassis No. 1 - 397 023	2	
-	111 401 239	Caster wedge	2	
4	*111 401 273	Stop (rubber) - Torsion arm	2	
5	111 401 281	Lock plate - Front axle	2	
6	N 10 190 1	Bolt, hex. head, M 12x1.5x90 DIN 960	4	
7	111 401 315	Bush - Torsion arm	8	

FRONT SUSPENSION

-	111 405 105 A	Torsion arm, upper up to chassis No. 1 - 117 053	2	111, 112
---	----------------------	--	---	----------

Key No.	Part No.	Description	Quantity	Type and model
8	111 405 105 B	Torsion arm, upper from chassis No. 1 - 117 054 <i>w/ TO CHASSIS NO</i>	2	
9	111 405 129	Dust excluder - Torsion arm	4	
10	111 405 151 A	Torsion arm, lower from chassis No. 1 - 117 054 <i>w/ TO CHASSIS NO</i>	2	
-	111 405 155 A	Torsion arm, lower up to chassis No. 1 - 117 053	2	111, 112
11	<i>Order</i> → N 10 440 1 → N 10 445 1	Bolt, hex. head, M 10×40 <i>5</i> DIN 931 <i>9.31</i>	4	
12	N 12 010 2	Lock washer B 10 DIN 127 galvanized	4	
13	N 11 010 2	Nut, hex., M 10 DIN 934 galvanized	4	
-	111 405 175	Mounting bolt, lower - Shock absorber up to chassis No. 1 - 117 053	2	111, 112
14	*111 405 175 A	Mounting bolt, lower - Shock absorber (oversize) . from chassis No. 1 - 117 054	×	
15	N 12 825 1	Dowel pin grooved 4×25 DIN 1473	×	
16	111 405 301	Steering knuckle, left	1	
-	111 405 302	Steering knuckle, right	1	
17	N 13 206 1	Dowel pin 3×6 DIN 7	2	
18	111 405 351	Link - Torsion arm (left)	1	
-	111 405 352	Link - Torsion arm (right)	1	
19	N 18 530 1	Grease nipple - Torsion arm link	4	
20	111 405 391	Bush - King pin	4	
21	111 405 395 A	Bush - Torsion arm link pin	4	
-	111 405 397	Dust cover - Torsion arm link	4	
22	111 405 411	King pin	2	
23	111 405 481	Thrust washer 3.30 mm - King pin	×	
	<i>Order</i> → 111 405 483 → 111 405 486 A	Thrust washer 3.40 mm - King pin	×	

- Insert:
- 111 405 486 A Thrust washer 3.56 mm
 - 111 405 487 A Thrust washer 3.63 mm
 - 111 405 488 A Thrust washer 3.68 mm
 - 111 405 489 A Thrust washer 3.73 mm
 - 111 405 490 A Thrust washer 3.78 mm
 - 111 405 491 A Thrust washer 3.83 mm
 - 111 405 492 A Thrust washer 3.88 mm
 - 111 405 493 A Thrust washer 3.93 mm
 - 111 405 494 A Thrust washer 3.98 mm
 - 111 405 495 A Thrust washer 4.03 mm
 - 111 405 496 A Thrust washer 4.08 mm

(see Workshop Bulletin V/1)

AXLE, STEERING

**Front axle beam,
Front suspension**

	tion	Quantity	Type and model
	King pin	×	
	King pin <i>Order 111 405 487 17</i>		
-	111 405 489 Thrust washer 3.70 mm - King pin	×	
-	111 405 491 Thrust washer 3.80 mm - King pin <i>ORDER 111 405 491</i>	×	
-	111 405 493 Thrust washer 3.90 mm - King pin	×	
-	111 405 495 Thrust washer 4.10 mm - King pin	×	
-	111 405 497 Thrust washer 4.30 mm - King pin	×	
24	111 405 501 Thrust washer (pressed fiber) - King pin	2	
25	111 405 511 Cover - King pin thrust washer	2	
26	111 405 521 Pin - Torsion arm link	4	
27	111 405 527 Shim - Torsion arm link pin	40	
-	111 405 615 Brake drum, front up to chassis No. 1 673 410	2	
-	111 405 615 Brake drum, front from chassis No. 1 673 411	2	111, 112, 115, 116
28	113 405 615 A Brake drum, front from chassis No. 1 673 411	2	113, 114, 117, 118, 151, 152
-	111 405 619 Tapped insert - Brake drum	×	
-	111 405 625 Ball bearing, 59 mm dia. - Front wheel	2	111, 112
	(inner) up to front axle No. 69 100		
29	111 405 625 A Ball bearing, 62 mm dia. - Front wheel	2	
	(inner) from front axle No. 69 101		
-	*111 405 627 Taper roller bearing 62 mm dia. - Front wheel ...	2	
	(inner) from front axle No. 69 101		
	(may be used instead of 111 405 625 A)		
30	111 405 631 B Spacer 40 mm dia. - Front wheel bearing, inner ..	2	
	from front axle No. 69 101		
-	111 405 641 Oil seal 59 mm dia. - Front wheel bearing, inner..	2	111, 112
	up to front axle No. 69 100		
31	111 405 641 A Oil seal 62 mm dia. - Front wheel bearing, inner..	2	
	from front axle No. 69 101		
-	111 405 645 Ball bearing 48 mm dia. - Front wheel	2	
	(outer) up to front axle No. 69 100		

Illustrat

- 111 405 517 Dust excluder - Torsion arm link pin
- 111 405 537 Retainer - Dust excluder

See 1/5 Bulletin 4
V15-6/20 4

Key No.	Part No.	Description	Quantity	Type and model
32	111 405 645 A	Ball bearing 52 mm dia. – Front wheel (outer) from front axle No. 69 101	2	
-	111 405 647	Taper roller bearing 52 mm dia. – Front wheel ... (outer) from front axle No. 69 101 (may be used instead of 111 405 645 A)	2	
-	111 405 649	Extractor ring (for use with taper roller bearing only)	2	
33	111 405 661	Thrust washer – Front wheel bearing (outer)	2	
34	111 405 671	Nut, hex. – Steering knuckle, left	2	
-	111 405 672	Nut, hex. – Steering knuckle, right	2	
35	111 405 681	Lock plate – Steering knuckle nut	2	
36	111 405 691	Grease cap – Front wheel, left	1	
-	111 405 692	Grease cap – Front wheel, right	1	
TORSION SPRING				
-	111 411 021	Torsion spring, lower (five leaves) up to chassis No. 1 – 117 053	1	111, 112
-	111 411 021 A	Torsion spring (five leaves) from chassis No. 1 – 117 054 up to 1 – 138 834 (lower only)	1	
-	111 411 021 A	Torsion spring (five leaves) from chassis No. 1 – 138 835 up to 1 – 397 022 (upper and lower)	2	
-	111 411 023	Torsion spring, upper (four leaves) up to chassis No. 1 – 117 053	1	111, 112
-	111 411 023 A	Torsion spring, upper (four leaves) from chassis No. 1 – 117 054 up to 1 – 138 834	1	
37	111 411 027	Torsion spring (eight leaves) from chassis No. 1 – 397 023	2	
38	*111 411 151	Grub screw – Torsion spring mounting	6	
39	*111 411 155	Nut – Grub screw	6	
SHOCK ABSORBER				
-	111 413 031	Shock absorber, front up to chassis No. 1 – 117 053	2	111, 112
-	111 413 031 A	Shock absorber, front from chassis No. 1 – 117 054 up to 1 – 397 022	2	

Key No.	Part No.	Description	Quantity	Type and model
-	111 413 031 E	Shock absorber, front from chassis No. 1 – 117 054 up to 1 – 397 022	2	
40	*111 413 031 F	Shock absorber, front from chassis No. 1 – 397 023	2	
-	*111 413 031 G	Shock absorber, front from chassis No. 1 – 397 023	2	
-	111 413 371	Bush – Rubber grommet (for shock absorber 111 413 031)	4	111, 112
41	*111 413 371 A	Bush – Rubber grommet (for shock absorbers 111 413 031 A/E/F/G)	4	
-	111 413 381	Grommet (rubber) – Shock absorber 111 413 031 ..	4	111, 112
42	*111 413 381 A	Grommet (rubber) – Shock absorbers 111 413 031 A/F	4	
-	*111 413 381 B	Grommet (rubber) – Shock absorbers 111 413 031 E/G	4	
-	111 413 401	Bolt – Shock absorber 111 413 031	2	111, 112
43	*111 413 401 A	Bolt – Shock absorbers 111 413 031 A/E/F/G	2	
-	111 413 403	Bolt (oversize) Shock absorber 111 413 031	2	111, 112
-	*111 413 403 A	Bolt (oversize) Shock absorbers 111 413 031 A/E/F/G	2	
44	N 12 111 1	Spring washer J 10.5 DIN 6798	2	
45	N 12 112 1	Spring washer J 12.5 DIN 6798	6	
-	111 413 419	Spring washer – Shock absorber bolt (for shock absorber 111 413 031)	4	111, 112
-	N 11 211 1	Nut, slotted, M 10 DIN 937	2	111, 112
-	N 12 522 1	Split pin 2×22 DIN 94	2	111, 112
46	N 11 010 2	Nut, hex., M 10 DIN 934 galvanized	2	

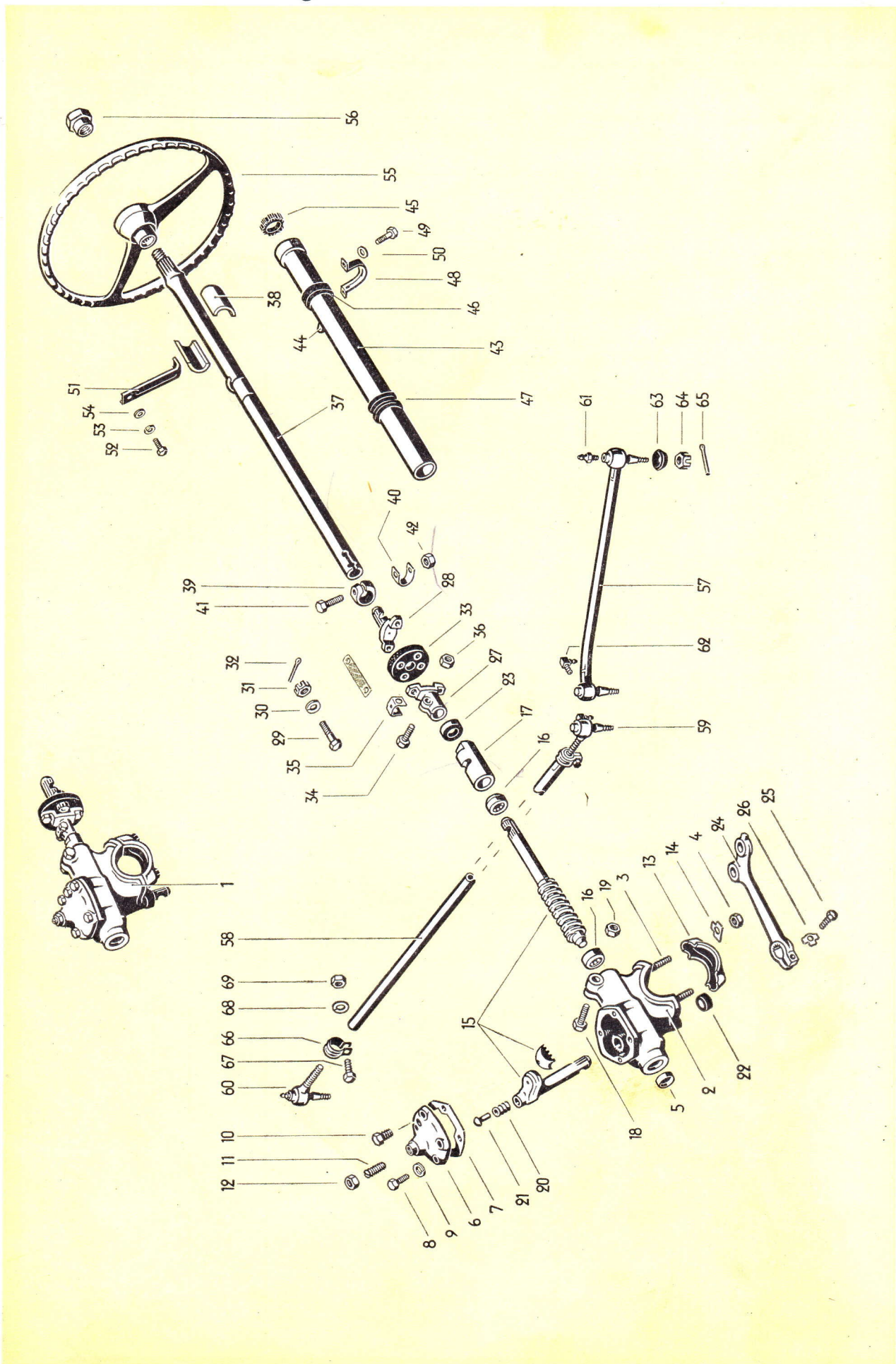

Illustration 16

Key No.	Part No.	Description	Quantity	Type and model
STEERING				
1	111 415 035	Steering gear assy. without steering drop arm	1	
2	111 415 105	Case – Steering gear	1	
3	N 14 461 1	Stud BM 10 B×58	2	
4	N 11 010 2	Nut, hex., M 10 DIN 934 galvanized	2	
5	111 415 115	Cap – Steering gear case	1	
6	111 415 131	Cover – Steering gear case	1	
7	111 415 135	Gasket – Steering gear case cover	1	
8	N 10 325 1	Bolt, hex. head, BM 8×25 DIN 931	4	
9	N 12 228 2	Spring washer B 8 DIN 137 galvanized	4	
10	111 101 193	Plug M 18×1.5	1	
-	111 415 139	Plug M 9×1	1	111, 112
11	111 415 143	Adjusting screw – Sector shaft,	1	
12	N 11 162 1	Nut, hex., M 12×1.5 DIN 936	1	
13	111 415 155	Mounting clamp – Steering gear	1	
14	111 415 159	Lock plate – Mounting clamp	2	
-	111 415 201	Steering gear set, comprising: Steering worm, sector, sector shaft 22 mm dia.	1	
15	111 415 201 A	Steering gear set, comprising: Steering worm, sector, sector shaft 28 mm dia.	1	
16	111 415 227	Thrust bearing – Steering worm	2	
17	111 415 251	Adjusting sleeve – Steering worm	1	
18	N 10 450 1	Bolt, hex. head, M 10×50 DIN 931	1	
19	N 11 010 2	Nut, hex., M 10 DIN 934 galvanized	1	

Key No.	Part No.	Description	Quantity	Type and model
33	111 415 417	Jointing disc (rubber)	1	
34	*111 415 421	Bolt – Steering worm flange	1	
35	111 415 425	Lock plate	1	
36	N 11 008 3	Nut, hex., M 8 DIN 934 galvanized	1	
37	113 415 505	Steering column	1	
-	111 415 521	Locking sleeve – Steering lock 111 905 851 A	1	
38	111 415 521 B	Locking shell	2	
39	111 415 539	Clamp – Steering column	1	
40	111 415 543	Lock plate	1	
41	N 10 340 1	Bolt, hex. head, M 8×40 DIN 931	1	
42	N 11 008 3	Nut, hex., M 8 DIN 934 galvanized	1	
43	111 415 555 B	Tube – Steering column	1	
44	111 415 571	Socket on steering column tube	1	
45	111 415 581 A	Bush 11 mm – Steering column tube	1	
46	111 415 603	Grommet (rubber), upper – Steering column tube	1	
47	111 415 607	Grommet (rubber), lower – Steering column tube..	1	
48	111 415 611	Clamp – Steering column tube	1	
49	N 10 215 2	Bolt, hex. head, M 6×15 DIN 933 galvanized	2	
50	N 11 652 1	Washer 7 galvanized	2	
-	111 415 621	Support – Steering column	1	111, 113, 115, 117, 151
		up to chassis No. 1 600 439		
51	111 415 621 A	Support – Steering column	1	
		from chassis No. 1 600 440		
52	N 10 210 1	Bolt, hex. head, M 6×10 DIN 933 galvanized	1	

Key No.	Part No.	Description	Quantity	Type and model
53	N 12 006 2	Lockwasher B 6 DIN 127 galvanized	1	
54	N 11 695 2	Washer 6.1 galvanized	1	
-	111 415 651 A	Steering wheel, black	1	111, 112, 115, 116
55	113 415 651 A	Steering wheel, stone-beige	1	113, 114, 117, 118, 151, 152
-	113 415 651 A	Steering wheel, ivory	1	113, 114, 117, 118, 151, 152
-	113 415 651-C <i>Order → 113 415 651 A</i>	Steering wheel, stone-beige, <i>Ivory and</i> with self-cancelling ring <i>113 415 651 and</i>	1	113, 114, 117, 118, 151, 152
-	113 415 651 C <i>Order → 113 415 651 A</i>	Steering wheel, ivory, with self-cancelling ring .. <i>Stone Beige</i>	1	113, 114, 117, 118, 151, 152
-	113 415 657	Self-cancelling ring on steering wheel	1	113, 114, 117, 118, 151, 152
-	N 10 901 1	Screw, countersunk head, AM 3×8 DIN 63	2	
-	111 415 661	Rubber nipple – Steering column <i>NOT AVAILABLE</i> up to chassis No. 1 – 072 904	1	111, 112
56	111 415 691	Nut – Steering wheel	1	
57	111 415 801	Tie rod, left	1	111, 113, 115, 117, 151
-	112 415 801 A	Tie rod, left, adjustable (RHD)	1	112, 114, 116, 118, 152
58	111 415 802	Tie rod, right, adjustable	1	111, 113, 115, 117, 151
-	112 415 802 A	Tie rod, right (RHD)	1	112, 114, 116, 118, 152
59	111 415 811	Tie rod end, with left-hand thread –	1	111, 113, 115, 117, 151
-	*111 415 811 A	Tie rod end (flat head), with left-hand thread	1	111, 113, 115, 117, 151
-	112 415 811	Tie rod end (round head), with left-hand thread ..	1	112, 114, 116, 118, 152
-	112 415 811 A	Tie rod end, with left-hand thread –	1	112, 114, 116, 118, 152
60	111 415 812	Tie rod end (round head)	1	
-	111 415 812 A	Tie rod end (flat head)	1	111, 113, 115, 117, 151
-	112 415 812 A	Tie rod end – Tie rod 112 415 801 A	1	112, 114, 116, 118, 152

114 415 801 A	Tie rod, left (adjustable RHD) - Steering damper	1	114, 118, 152	nd model
113 415 802	Tie rod, adjustable - Steering damper(right)	1	113, 117, 151	
113 415 811	Tie rod end (round head) with left-hand thread - Tie rod - Steering damper	1	113, 117, 151	
114 415 811	Tie rod end with left-hand thread - Tie rod - Steering damper	1	114, 118, 142, 144, 152	
113 415 812	Tie rod end - Tie rod for steering damper	1	113, 114, 117, 118, 142, 144, 151, 152	
113 415 812 A	Tie rod end (flat head) - Tie rod for steering damper	1	113, 117, 141, 143, 151	

141 415 855 A TAPER RING.
 N 11 163 1 Hex nut M14 x 1.5 DIN 936
 N 11 163 2 " " M14 x 1.5 DIN 936 LEFT HAND THREAD
 113 415 901 STEERING DAMPER.
 N 10 440 1 BOLT HEX HEAD M 10 x 40 DIN 931

SEE W/SHOP BULLETIN V/15-V/20

65	N 12 522 1	Split pin 2x22 DIN 94	1	
66	111 415 841 A	Clamp 18 mm dia. - Tie rod 111 415 802	2	

141 415 855 A	Taper ring	2	113, 114, 117, 118, 141-152	
N 11 163 1	Nut, hex. M 14 x 1.5 DIN 936	1	113, 114, 117, 118, 141-152	
N 11 163 2	Nut, hex. M-14 x 1.5 DIN 936, left-hand thread	1	113, 114, 117, 118, 141-152	
113 415 901	Steering damper	1	113, 114, 117, 118, 151, 152	
N 10 440 1	Bolt, hex. head M 10 x 40 DIN 931	1	113, 114, 117, 118, 151, 152	
113 415 905 113 415 907	Rubber grommet with bush - Tie rod end	1	113, 114, 117, 118, 141-152	
211 415 907	Grommet (rubber) - Steering damper	1	113, 114, 117, 118, 141-152	
211 415 909 A	Bush - Rubber grommet TIE ROD END STEERING DAMPER MOUNTING IN	1	113, 114, 117, 118, 141-152	115, 117,
111 415 921	Clip - Steering damper (service installation)	1		116, 118,
-	112 415 911	Mounting bracket - Steering damper		152
-	N 10 140 1	Bolt, hex. head, M 12x1.5x40 DIN 960	1	
-	N 11 020 1	Nut, hex., M 12x1.5 DIN 934	2	
-	N 12 232 1	Spring washer B 12 DIN 137	4	
-	N 10 155 1	Bolt, hex. head, M 12x1.5x55 S DIN 960	1	
-	*111 513 479	Washer	1	112, 114, 116, 118, 152

SEE W/SHOP BULLETIN V/15-V/20



If you think

something could be done better than it is in the parts stockroom, thoroughly consider all the factors involved. If you are still sure your idea will benefit the stockroom (and thus yourself), there is just one thing to do: take it to the boss.

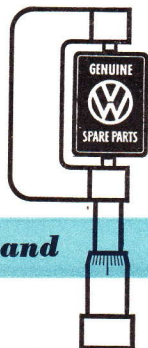

Each part is Factory Engineered and Inspected