

MAIN GROUP

6

	Illustration
01 Road wheels	19
05 Brakes (mech.)	19
09 Hydraulic brake	20
11 Brake cylinders and lines	21

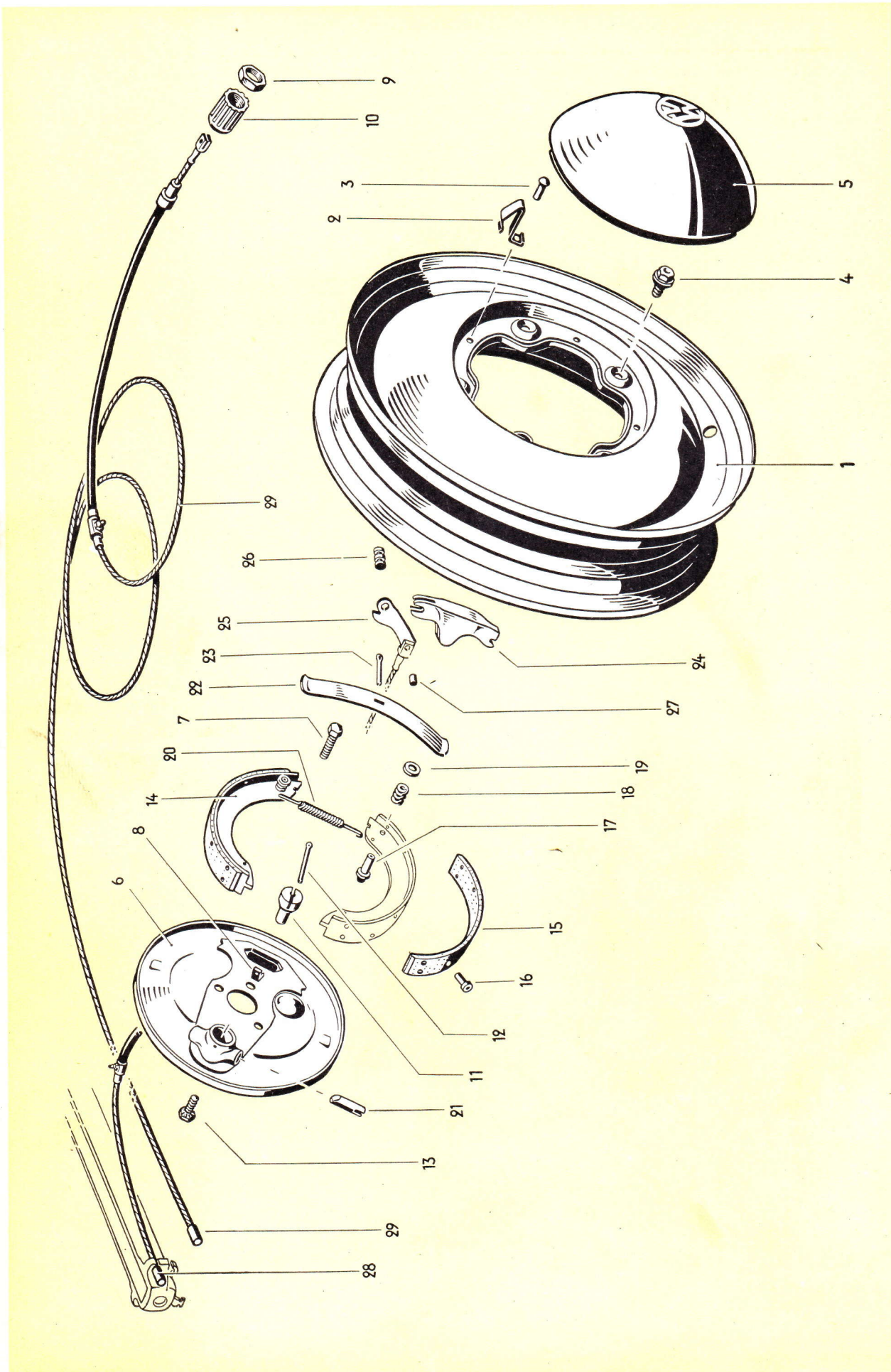

Illustration 19

Key No.	Part No.	Description	Quantity	Type and model
ROAD WHEELS				
-	111 601 021	Wheel disc 3.00×D-16 up to chassis No. 1 – 397 022	5	
-	N 20 102 1	Screw-type valve DIN 7779 – Tubeless tires	5	
1	111 601 025 C	Wheel disc 4 J×15 from chassis No. 1 – 397 023	5	
2	*111 601 131	Spring – Hub cap	25	
3	N 13 407 1	Rivet, button head, 4.5×7	25	
4	111 601 139	Bolt M 12×1.5 – Wheel disc	20	
-	111 601 141	Bolt M 14×1.5 (oversize) – Wheel disc	×	
-	*111 601 151	Hub cap	4	111, 112, 115, 116
5	*113 601 151	Hub cap (chromium plated)	4	113, 114, 117, 118, 151, 152
-	*241 601 155	Rim embellisher – Road wheel 111 601 021	×	NOT AVAILABLE
-	*241 601 155 A	Rim embellisher – Road wheel 111 601 025 C	×	111 – 118 151, 152
-	*111 601 161	Ferrule – Hub cap	16	
-	111 601 361	Rubber-type valve – Tubeless tires	5	
BRAKES				
6	111 605 139	Back plate – Front brake, left	1	111, 112, 115, 116
-	111 605 140	Back plate – Front brake, right	1	111, 112, 115, 116
7	<i>113 609 381</i> <i>N 12 541 1</i> *211 609 391	Mounting bolt – Back plate	6	111, 112, 115, 116
8	111 605 173	Bracket – Brake shoe leaf spring	4	111, 112, 115, 116
9	111 605 187	Lock nut – Brake cable adjusting sleeve	4	111, 112, 115, 116
10	111 605 191	Adjusting sleeve – Brake cable	4	111, 112, 115, 116
11	111 605 195	Cone – Brake shoe adjuster	4	111, 112, 115, 116
12	N 12 540 1	Split pin 3×40 DIN 94	4	111, 112, 115, 116
	113 609 381	Mounting bolt – Back plate from chassis No.....	6	111, 112, 115, 116
Illustratic	N 12 011 1	Lock washer A 10 DIN 127	6	111, 112, 115, 116

ORDER

113 608 237 C

Key N	Description	Quantity	Notes
113 609 237 D	Brake shoe 40, front and lining from chassis No. 1 673 411	4	Chance IN PRODUCTION 113, 114, 117, 151, 152 del
13	111 605 199 Screw – Brake shoe adjuster cone	4	111, 112, 115, 116
14	111 605 237 Brake shoe and lining	4	111, 112, 115, 116
-	111 605 238 Brake shoe and lining	4	111, 112, 115, 116
15	111 605 265 Brake lining (standard) (Jurid)	8	Order in sets 111, 112, 115, 116
-	111 605 265 A Brake lining (standard) (Energit)	8	111, 112, 115, 116
-	111 605 269 Brake lining 0.5 mm oversize (Jurid)	x	111, 112, 115, 116
-	111 605 269 A Brake lining 0.5 mm oversize (Energit)	x	111, 112, 115, 116
16	N 13 634 1 Rivet C 4x7.5 DIN 7338 galvanized	64	111, 112, 115, 116
17	111 605 277 Retainer bolt – Brake shoe	8	111, 112, 115, 116
18	111 605 283 Pressure spring – Brake shoe	8	111, 112, 115, 116
19	111 605 289 Washer – Pressure spring	8	111, 112, 115, 116
20	111 605 301 Return spring – Brake shoe	8	111, 112, 115, 116
21	111 605 321 Locating pin – Brake shoe	8	111, 112, 115, 116
22	111 605 325 Leaf spring – Brake shoe	4	111, 112, 115, 116
23	N 12 530 1 Split pin 3x15 DIN 94	4	111, 112, 115, 116
24	111 605 331 Expander – Brake shoe	4	111, 112, 115, 116
25	111 605 335 A Operating lever – Brake shoe	4	111, 112, 115, 116
26	111 605 341 Pin – Expander and operating lever	4	111, 112, 115, 116
27	111 605 347 Pin – Brake cable	4	111, 112, 115, 116
-	111 605 439 Back plate – Rear brake	2	111, 112, 115, 116
28	111 605 701 Cable – Front brake (length 892 mm)	2	111, 112, 115, 116
29	111 605 721 Cable – Rear brake (length 2946 mm)	2	111, 112, 115, 116
-	111 605 737 Distance piece – Brake cable (front and rear)	x	111, 112, 115, 116

At part-Nos.:

- 111 605 265
- 111 605 265 A
- 111 605 269
- 111 605 269 A
- 113 609 265 A
- 113 609 265 B
- 113 609 269 A
- 113 609 269 B

delete in text:
"(available only as SP...)"



What would you say

if the back of the counter or the stockroom of an auto supply shop looked like this?

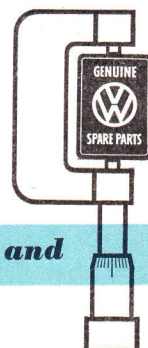

Each part is Factory Engineered and Inspected

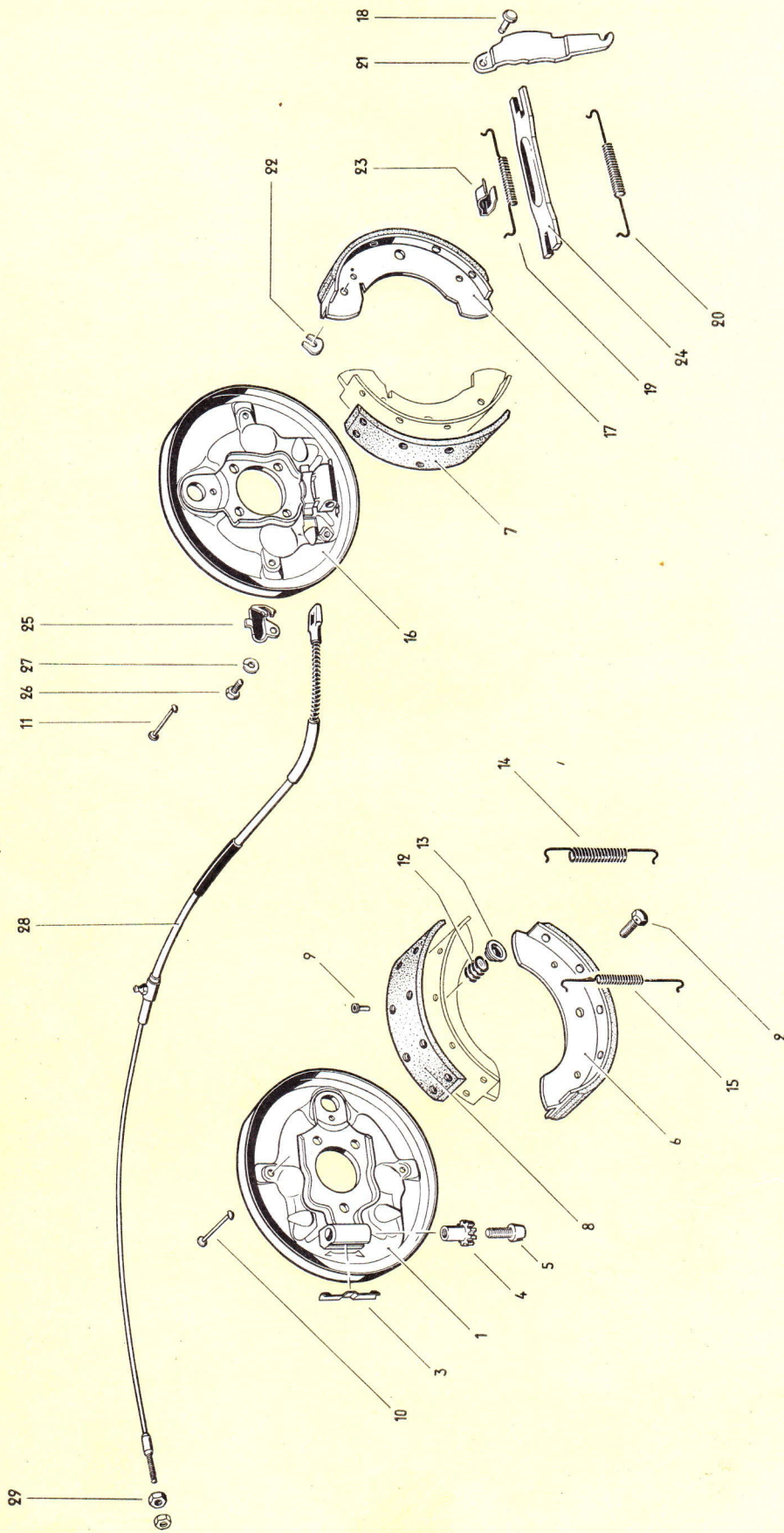

Key No.	Part No.	Description	Quantity	Type and model
HYDRAULIC BRAKE				
-	113 609 139	Back plate – Front brake, left up to chassis No. 1 673 410	1	113, 114, 117, 118, 151, 152
1	113 609 139 A	Back plate – Front brake from chassis No. 1 673 411	2	113, 114, 117, 118, 151, 152
2	N 10 250 1	Bolt, hex. head, M 10×15 SK DIN 933	6	113, 114, 117, 118, 151, 152
-	N 10 255 1	Bolt, hex. head, M 10×22 SK DIN 933	×	113, 114, 117, 118, 151, 152
-	113 609 140	Back plate– Front brake, right up to chassis No. 1 673 410	1	113, 114, 117, 118, 151, 152
-	*211 609 185	Leaf spring – Adjusting device (screwed)	4	113, 114, 117, 118, 151, 152
-	N 11 225 1	Screw, button head, AM 3×4 DIN 86	8	113, 114, 117, 118, 151, 152
-	N 12 003 1	Lock washer B 3 DIN 127	8	113, 114, 117, 118, 151, 152
3	*211 609 185 A	Leaf spring – Adjusting device (caulked)	4	113, 114, 117, 118, 151, 152
4	*211 609 205	Adjusting nut – Brake shoe	8	113, 114, 117, 118, 151, 152
5	*211 609 209	Adjusting screw – Brake shoe 113 609 237/C/537 A	8	113, 114, 117, 118, 151, 152
-	*113 609 209	Adjusting screw – Brake shoe 113 609 237 A	8	113, 114, 117, 118, 151, 152
-	*113 609 211	Spacer	4	113, 114, 117, 118, 151, 152
-	113 609 213	Washer (to eliminate brake knocking)	×	113, 114, 117, 118, 151, 152
-	113 609 237	Brake shoe 30 and lining up to chassis No. 1 – 575 414	8	113, 114, 117, 118, 151, 152
-	113 609 237 A	Brake shoe 30 and lining from chassis No. 1 – 575 415 up to 1 673 410	8	113, 114, 117, 118, 151, 152
6	113 609 237 C	Brake shoe 40, front, and lining from chassis No. 1 673 411	4	113, 114, 117, 118, 151, 152
7	111 605 265	Brake lining 30 – Brake shoe 113 609 237/A/537 A (Jurid)	4	113, 114, 117, 118, 151, 152
-	111 605 265 A	Brake lining 30 – Brake shoe 113 609 237/A/537 A (Energif)	4	113, 114, 117, 118, 151, 152
8	113 609 265 A	Brake lining 40 – Brake shoe 113 609 237 C (Jurid)	4	113, 114, 117, 118, 151, 152
-	113 609 265 B	Brake lining 40 – Brake shoe 113 609 237 C (Energif)	4	113, 114, 117, 118, 151, 152

Key No.	Part No.	Description	Quantity	Type and model
	<i>N12011</i>	<i>Lock washer A 10 DIN 127</i>		
-	111 605 269	Brake lining 30 (0.5 mm oversize) - Brake shoe 113 609 237/A/537 A (Jurid)	×	113, 114, 117, 118, 151, 152
-	111 605 269 A	Brake lining 30 (0.5 mm oversize) - Brake shoe 113 609 237/A/537 A (Energif)	×	113, 114, 117, 118, 151, 152
-	113 609 269 A	Brake lining 40 (0.5 mm oversize) - Brake shoe 113 609 237 C (Jurid)	×	113, 114, 117, 118, 151, 152
-	113 609 269 B	Brake lining 40 (0.5 mm oversize) - Brake shoe 113 609 237 C (Energif)	×	113, 114, 117, 118, 151, 152
9	N 13 634 1	Rivet C 4×7.5 DIN 7338 galvanized	72	113, 114, 117, 118, 151, 152
10	*113 609 279	Retaining pin 35 mm - Brake shoe	4	113, 114, 117, 118, 151, 152
11	113 609 279 A	Retaining pin 30 mm - Brake shoe 113 609 537 A	4	113, 114, 117, 118, 151, 152
12	*113 609 283	Spring - Retaining pin	8	113, 114, 117, 118, 151, 152
13	*113 609 289	Spring seat - Retaining pin	8	113, 114, 117, 118, 151, 152
-	*113 609 301	Return spring (lower) - Brake shoe 113 609 237/A	4	113, 114, 117, 118, 151, 152
14	113 609 301 B	Return spring (upper) - Brake shoe 113 609 237 C	2	113, 114, 117, 118, 151, 152
-	*113 609 309	Return spring (upper) - Brake shoe 113 609 237 A	8	113, 114, 117, 118, 151, 152
15	113 609 309 B	Return spring (lower) - Brake shoe 113 609 237 C	2	113, 114, 117, 118, 151, 152
-	*211 609 313	Return spring (upper) - Brake shoe 113 609 237 ..	4	113, 114, 117, 118, 151, 152
-	113 609 439	Back plate - Rear brake, left	1	113, 114, 117, 118, 151, 152
		up to chassis No. 1 673 410		
16	113 609 439 B	Back plate - Rear brake, left	1	113, 114, 117, 118, 151, 152
		from chassis No. 1 673 411		
-	113 609 440	Back plate - Rear brake, right	1	113, 114, 117, 118, 151, 152
		up to chassis No. 1 673 410		
-	113 609 440 B	Back plate - Rear brake, right	1	113, 114, 117, 118, 151, 152
		from chassis No. 1 673 411		
17	113 609 537 A	Brake shoe 30, rear	4	113, 114, 117, 118, 151, 152
		from chassis No. 1 673 411		
18	*211 609 601 A	Anchor pin - Brake lever	2	113, 114, 117, 118, 151, 152
19	113 609 605 A	Return spring (upper) - Brake shoe 113 609 537 A	2	113, 114, 117, 118, 151, 152
20	113 609 309 B	Return spring (lower) - Brake shoe 113 609 537 A	2	113, 114, 117, 118,
	113 609 381	Mounting bolt M 10 x 18 - Back plate from chassis No. <i>2.835 922</i>	6	113, 114, 117, 118, 151, 152
	113 609 385	Mounting bolt M 10 x 22 - Back plate from chassis No. <i>2.835 922</i>	X	113, 114, 117, 118, 151, 152
illus	N 12 011 1	Lock washer A 10 DIN 127	6	113, 114, 117, 118, 151, 152

*see w/s Bulletin
13/7*

Key No.	Part No.	Description	Quantity	Type and model
-	*211 609 613	Brake lever – Brake shoe 113 609 237/A	1	113, 114, 117, 118, 151, 152
21	113 609 613 A	Brake lever, left – Brake shoe 113 609 537 A	1	113, 114, 117, 118, 151, 152
-	*211 609 614	Brake lever – Brake shoe 113 609 237/A	1	113, 114, 117, 118, 151, 152
-	113 609 614 A	Brake lever, right – Brake shoe 113 609 537 A	1	113, 114, 117, 118, 151, 152
22	*211 609 619	C-Washer – Brake lever anchor pin	2	113, 114, 117, 118, 151, 152
23	113 609 625	Spring clip – Push bar	2	113, 114, 117, 118, 151, 152
-	*211 609 631	Push bar – Brake shoe	1	113, 114, 117, 118, 151, 152
		up to chassis No. 1 673 410		
24	113 609 631 A	Push bar – Brake shoe	2	113, 114, 117, 118, 151, 152
		from chassis No. 1 673 411		
-	*211 609 632	Push bar – Brake shoe	1	113, 114, 117, 118, 151, 152
		up to chassis No. 1 673 410		
25	*113 609 637	Bracket – Brake cable	1	113, 114, 117, 118, 151, 152
-	*113 609 638	Bracket – Brake cable	1	113, 114, 117, 118, 151, 152
26	N 10 237 1	Bolt, hex. head, M 8×12 DIN 933	2	113, 114, 117, 118, 151, 152
27	N 12 008 2	Lock washer B 8 DIN 127 galvanized	2	113, 114, 117, 118, 151, 152
-	113 609 721	Cable – Rear brake (length 3031 mm)	2	113, 114, 117, 118, 151, 152
-	113 609 721 A	Cable – Rear brake (length 3131 mm)	2	113, 114, 117, 118, 151, 152
-	113 609 721 B	Cable – Rear brake (length 1920 mm)	2	113, 114, 117, 118, 151, 152
		from chassis No. 1 – 929 746 up to 1 600 439		
28	113 609 721 E	Cable – Rear brake (length 1740 mm)	2	113, 114, 117, 118, 151, 152
		from chassis No. 1 600 440		
29	N 11 006 2	Nut, hex., M 6 DIN 934 galvanized	4	113, 114, 117, 118, 151, 152

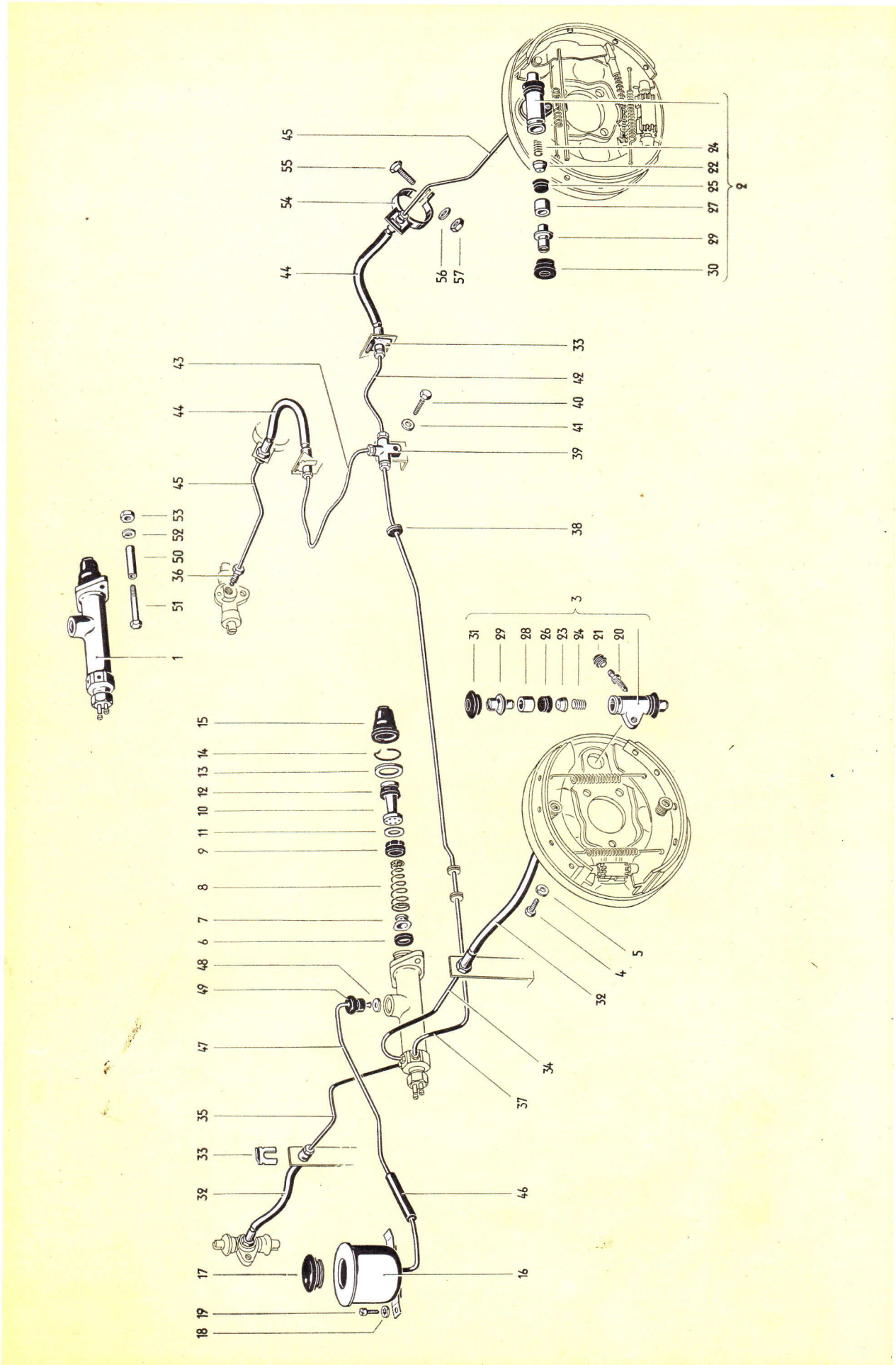

Illustration 21

*211 611 127 A Check valve - Brake master cylinder 22

*113 611 127 B Check valve - Brake master cylinder 19

*See W/S
Bulletin
B41*

1 113, 114, 117, 118,
151, 152
1 113, 114, 117, 118,
151, 152

ines

Key No.	Part No.	Description	Quantity	Notes
	*113 611 127 B	Check valve - Brake master cylinder 19	1	<i>See above</i>
	*211 611 127 A	Check valve - Brake master cylinder 22.2	1	<i>See in W/S Bulletin</i>
BRAKE CYLINDERS AND LINES				
-	*211 611 011	Brake master cylinder 19 with reservoir up to chassis No. 1 - 575 414	1	113, 114, 117, 118, 151, 152
1	113 611 021	Brake master cylinder 19 from chassis No. 1 - 575 415	1	113, 114, 117, 118, 151, 152
-	113 611 051	Cylinder 16 - Rear wheel brake from chassis No. 1 - 167 890 up to 1 - 397 022	2	113, 114, 117, 118, 151, 152
-	113 611 053	Cylinder 17.5 - Rear wheel brake from chassis No. 1 - 397 023 up to 1 673 410	2	113, 114, 117, 118, 151, 152
-	*113 611 055	Cylinder 19 - Front wheel brake up to chassis No. 1 673 410 (at rear only up to chassis No. 1 - 167 889)	2	113, 114, 117, 118, 151, 152
2	113 611 055 B	Cylinder 19 - Rear wheel brake from chassis No. 1 673 411	2	113, 114, 117, 118, 151, 152
3	113 611 057 A	Cylinder 22 - Rear wheel brake from chassis No. 1 673 411	2	113, 114, 117, 118, 151, 152
4	N 10 043 1	Bolt, hex. head, M 8x15 DIN 70 614	4	113, 114, 117, 118, 151, 152
5	N 12 008 2	Lock washer B 8 DIN 127 galvanized	4	113, 114, 117, 118, 151, 152
-	*211 611 121 <i>113 611 127 A</i>	Valve seat ring - Brake master cylinder 22	1	113, 114, 117, 118, 151, 152
6	*113 611 121 <i>113 611 127 B</i>	Valve seat ring - Brake master cylinder 19	1	113, 114, 117, 118, 151, 152
-	*211 611 127	Check valve - Brake master cylinder 22	1	113, 114, 117, 118, 151, 152
7	*113 611 127 <i>113 611 127 A</i>	Check valve - Brake master cylinder 19	1	113, 114, 117, 118, 151, 152
-	*211 611 143	Piston return spring - Brake master cylinder 22	1	113, 114, 117, 118, 151, 152
8	*113 611 143	Piston return spring - Brake master cylinder 19	1	113, 114, 117, 118, 151, 152
-	*211 611 155	Main cup - Brake master cylinder 22	1	113, 114, 117, 118, 151, 152
9	*113 611 155	Main cup - Brake master cylinder 19	1	113, 114, 117, 118, 151, 152
-	*211 611 165	Piston - Brake master cylinder 22	1	113, 114, 117, 118, 151, 152
10	*113 611 165	Piston - Brake master cylinder 19	1	113, 114, 117, 118, 151, 152
-	*211 611 167	Washer - Brake master cylinder 22	1	113, 114, 117, 118, 151, 152

Key No.	Part No.	Description	Quantity	Type and model
11	*113 611 167	Washer – Brake master cylinder 19	1	113, 114, 117, 118, 151, 152
-	*211 611 173	Secondary cup – Brake master cylinder 22	1	113, 114, 117, 118, 151, 152
12	*113 611 173	Secondary cup – Brake master cylinder 19	1	113, 114, 117, 118, 151, 152
13	*113 611 179	Stop washer – Brake master cylinder	1	113, 114, 117, 118, 151, 152
14	*113 611 185	Lock ring	1	113, 114, 117, 118, 151, 152
15	*113 611 195	Boot	1	113, 114, 117, 118, 151, 152
-	*211 611 301	Reservoir – Brake master cylinder 211 611 011	1	113, 114, 117, 118, 151, 152
16	113 611 301 A	Reservoir – Brake master cylinder 113 611 021	1	113, 114, 117, 118, 151, 152
-	*211 611 351	Cover with gasket – Reservoir 211 611 301	1	113, 114, 117, 118, 151, 152
-	*211 611 363	Gasket – Reservoir cover 211 611 301	1	113, 114, 117, 118, 151, 152
17	*113 611 373	Plug – Reservoir 113 611 301/A	1	113, 114, 117, 118, 151, 152
-	*211 611 381 A	Gland nut with strainer – Reservoir 211 611 301 ...	1	113, 114, 117, 118, 151, 152
-	N 13 827 1	Sealing washer A 22×27 DIN 7603	1	113, 114, 117, 118, 151, 152
-	113 611 399	Anti squeak – Reservoir 113 611 301	1	113, 114, 117, 118, 151, 152
18	N 12 106 1	Spring washer J 6.4 DIN 6798 galvanized	1	113, 114, 117, 118, 151, 152
19	N 11 393 1	Metal screw, cheese head, S 5.5×13 DIN 7971 ...	1	113, 114, 117, 118, 151, 152
-	*113 611 475	Bleeder screw with rubber cap –	4	113, 114, 117, 118, 151, 152
20	*211 611 477	Bleeder screw –	4	113, 114, 117, 118, 151, 152
21	*211 611 483	Rubber cap	4	113, 114, 117, 118, 151, 152
-	113 611 601	Center piece half – Wheel brake cylinder 16	4	113, 114, 117, 118, 151, 152
-	113 611 603	Center piece half – Wheel brake cylinder 17.5 ..	4	113, 114, 117, 118, 151, 152
22	*113 611 605	Center piece half – Wheel brake cylinder 19	4	113, 114, 117, 118, 151, 152

Key No.	Part No.	Description	Quantity	Type and model
23	*211 611 607	Center piece half – Wheel brake cylinder 22	4	113, 114, 117, 118, 151, 152
24	*113 611 615	Pressure spring – Center piece halves	4	113, 114, 117, 118, 151, 152
-	113 611 621	Cup – Wheel brake cylinder 16	4	113, 114, 117, 118, 151, 152
-	113 611 623	Cup – Wheel brake cylinder 17.5	4	113, 114, 117, 118, 151, 152
25	*113 611 625	Cup – Wheel brake cylinder 19	4	113, 114, 117, 118, 151, 152
26	*211 611 627	Cup – Wheel brake cylinder 22	4	113, 114, 117, 118, 151, 152
-	113 611 661	Piston – Wheel brake cylinder 16	4	113, 114, 117, 118, 151, 152
-	113 611 663	Piston – Wheel brake cylinder 17.5	4	113, 114, 117, 118, 151, 152
27	*113 611 665	Piston – Wheel brake cylinder 19	4	113, 114, 117, 118, 151, 152
28	*211 611 667	Piston – Wheel brake cylinder 22	4	113, 114, 117, 118, 151, 152
-	113 611 683	Push rod – Wheel brake cylinder 16	4	113, 114, 117, 118, 151, 152
29	*113 611 687	Push rod – Wheel brake cylinder 17.5/19/22	4	113, 114, 117, 118, 151, 152
30	*113 611 695	Boot – Wheel brake cylinder 16/17.5/19	8	113, 114, 117, 118, 151, 152
31	113 611 695 C	Boot – Wheel brake cylinder 22	4	113, 114, 117, 118, 151, 152
32	*113 611 701	Hose – Front brake (length 476 mm)	2	113, 114, 117, 118, 151, 152
33	*113 611 715	Bracket – Brake hose	6	113, 114, 117, 118, 151, 152
	<i>ORDER 113 611 715 A. CHANGE IN PRODUCTION</i>			
9	*113 611 715 A	Bracket – Brake hose <i>CHANGE IN PRODUCTION</i>	6	113, 114, 117, 118, 151, 152
35	113 611 724	Line – front brake (length 400 mm)	113, 114, 117, 118, 151, 152
36	*113 611 731	Union nut	x	113, 114, 117, 118, 151, 152
37	113 611 741	Brake line from master cylinder to T-piece	1	113, 117, 151
-	114 611 741	Brake line from master cylinder to T-piece (RHD)	1	114, 118, 152
38	*211 611 751	Grommet (rubber) – Brake line	3	113, 114, 117, 118, 151, 152

Key No.	Part No.	Description	Quantity	Type and model
39	*113 611 755	T-piece – Brake lines	1	113, 114, 117, 118, 151, 152
40	N 10 343 1	Bolt, hex. head, BM 6×25 DIN 931	1	113, 114, 117, 118, 151, 152
41	N 12 226 2	Spring washer B 6 DIN 137 galvanized	1	113, 114, 117, 118, 151, 152
42	113 611 763 A	Brake line between T-piece and brake hose, rear, left (length 190 mm)	1	113, 114, 117, 118, 151, 152
43	113 611 764 B	Brake line between T-piece and brake hose, rear, right (length 645 mm)	1	113, 117, 151
-	114 611 764 B	Brake line between T-piece and brake hose, rear, left (length 645 mm) (RHD)	1	114, 118, 152
44	*113 611 775	Hose – Rear brake (length 265 mm)	2	113, 114, 117, 118, 151, 152
-	113 611 781	Line (length 390 mm) – Rear brake, left	1	113, 114, 117, 118, 151, 152
45	113 611 781 A	Line (length 302 mm) – Rear brake, left	2	113, 114, 117, 118, 151, 152
-	113 611 782	Line (length 390 mm) – Rear brake, right	1	113, 114, 117, 118, 151, 152
46	113 611 801	Connecting hose –	1	113, 114, 117, 118, 151, 152
		Brake master cylinder 113 611 021		
47	113 611 805 A	Line between reservoir and brake master cylinder	1	113, 117, 151
-	114 611 805	Line between reservoir and brake master cylinder (RHD)	1	114, 118, 152
48	113 611 811	Washer – Plug	1	113, 114, 117, 118, 151, 152
49	113 611 817	Plug – Brake master cylinder 113 611 021	1	113, 114, 117, 118, 151, 152
50	113 611 829	Distance tube	2	113, 114, 117, 118, 151, 152
51	N 10 350 1	Bolt, hex. head, BM 8×50 DIN 931	2	113, 114, 117, 118, 151, 152
52	N 12 008 2	Lock washer B 8 DIN 127 galvanized	2	113, 114, 117, 118, 151, 152
53	N 11 008 3	Nut, hex., M 8 DIN 934 galvanized	2	113, 114, 117, 118, 151, 152
54	*211 611 841	Clip – Brake hose (rear axle)	2	113, 114, 117, 118, 151, 152
55	N 10 325 1	Bolt, hex. head, BM 8×25 DIN 931	2	113, 114, 117, 118, 151, 152
56	N 12 008 2	Lock washer B 8 DIN 127 galvanized	2	113, 114, 117, 118, 151, 152
57	N 11 008 3	Nut, hex., M 8 DIN 934 galvanized	2	113, 114, 117, 118, 151, 152

113 611 843 Clamp - Brake hose on frame head

2 113, 114, 117, 118, 141-152