

MAIN GROUP

9

	Illustration
03 Generator	36
05 Ignition	37
11 Starting motor	38
15 Battery mounting	38
19 Instruments	39
25 Instrument panel	—
37 Fuse box	39
41 Headlamp	39
43 Licence plate light	39
45 Tail light	39
47 Interior light	39
51 Horn	39
53 Direction indicator	40
55 Windshield wiper	40
57 Speedometer	41
71 Electric wiring	41

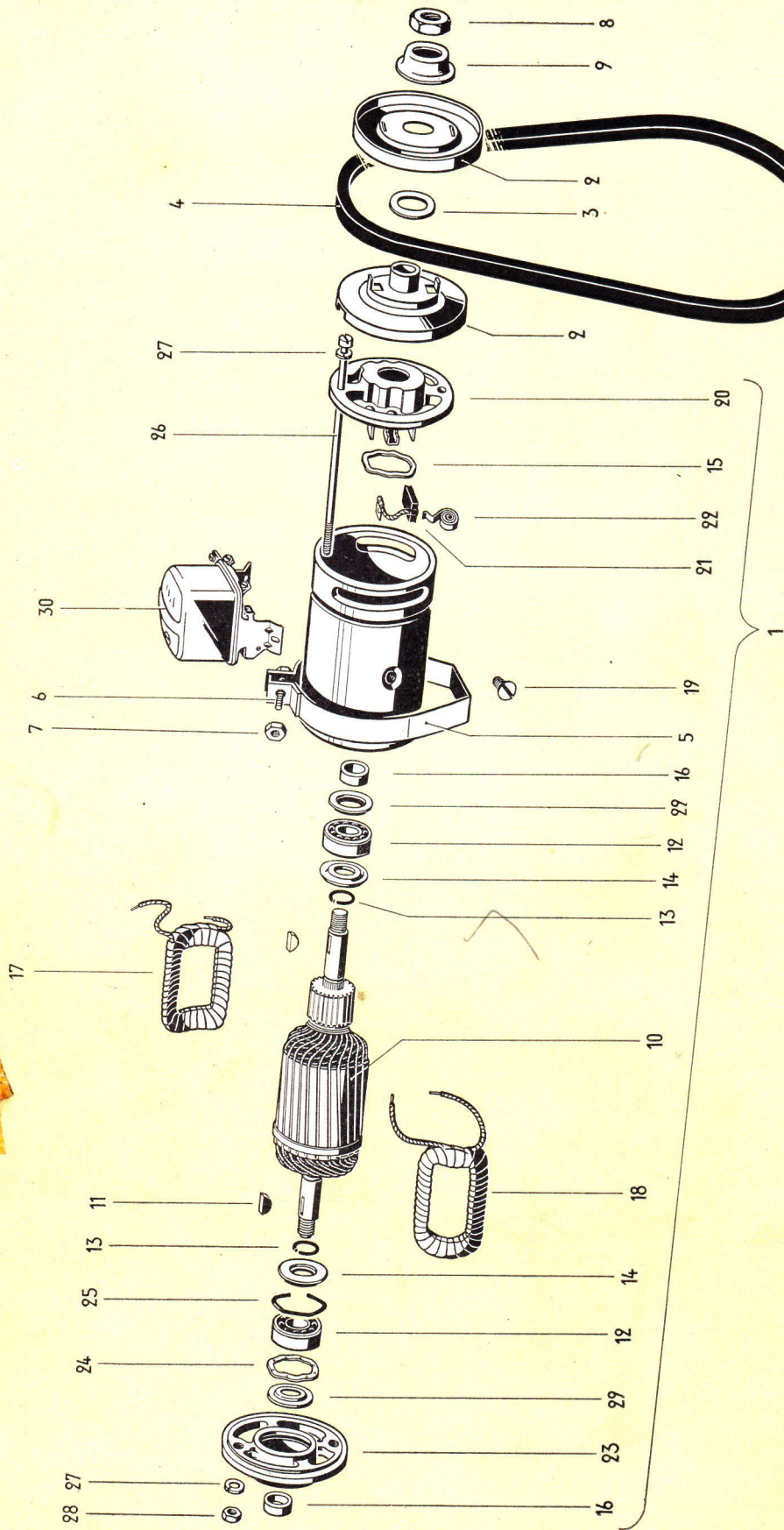
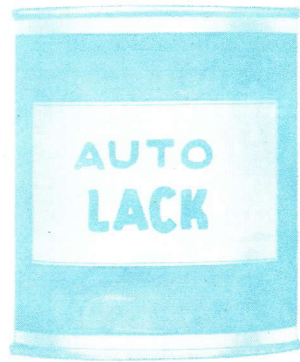

Illustration 36

Key No.	Part No.	Description	Quantity	Type and model
	<i>111 903 109C</i>	<i>GENERATOR Pulley outside Diameter 103 mm</i>		<i>4/25 4.25"</i>
		GENERATOR		
1	*111 903 021 E	Generator <i>Order 113 903 021 Generator</i>	1	<i>180 WATT</i>
-	*111 903 109	Pulley - Generator (13 mm. belt)	1	
-	*111 903 109 A	Pulley - Generator (9.5 mm. belt) up to engine No. 1 - 1 120 614	1	
2	*111 903 109 B	Pulley with hub <i>OUTSIDE DIAMETER 99.5 mm</i> from engine No. 1 - 1 120 615	1	
-	*111 903 115	Hub - Pulley up to engine No. 1 - 1 120 614 ...	1	
-	*111 903 123	Distance washer 1.5 mm. - Pulley	6	
3	*111 903 131 A	Distance washer 0.5 mm. - Pulley	x	
-	*111 903 137	Belt, width 13 mm. up to engine No. 1 - 695 281 ..	1	
4	*111 903 137 A	Belt, width 9.5 mm. from engine No. 1 - 695 282	1	
5	*111 903 141	Strap - Generator	1	
	<i>Order 113 903 141</i>			
6	N 10 325 1	Bolt, hex. head, BM 8×25 DIN 931	1	
7	N 11 008 3	Nut, hex., M 8 DIN 934 galvanized	1	
-	*111 119 141	Nut - Pulley mounting up to engine No. 1 - 1 120 614	1	
8	*111 903 181	Nut - Pulley mounting from engine No. 1 - 1 120 615	1	
9	*111 903 183	Tub wheel for small pulley from engine No. 1 - 1 120 615	1	
-	*111 903 213 B	Armature with radiax type ball bearing - Generator	1	
10	*111 903 213 C	Armature with radiax type ball bearing - Generator 111 903 021 E (with ring)	1	
11	N 12 705 1	Woodruff key 3×5 DIN 6888	2	
12	*111 903 221	Ball bearing - Armature	2	
13	*111 903 223	Lockring for generator	2	
14	*111 903 225	Oil slinger for generator	2	

Key No.	Part No.	Description	Quantity	Type and model
15	*111 903 235	Spring washer – Generator	1	
16	*111 903 237	Spacer washer for generator	2	
17	*111 903 351 A	Field coil I for generator	1	
-	*111 903 353	Field coil II for generator 130 Watt	1	
18	*111 903 353 B	Field coil II for generator 160 Watt	1	
19	N 10 999 1	Screw, countersunk head, AM 10×13.5 DIN 63 ...	2	
-	*111 903 505	End plate with carbon brushes	1	
		for generator 130 Watt		
20	*111 903 505 A	End plate with carbon brushes	1	
		for generator 160 Watt		
21	*111 903 515	Carbon brush – Generator	2	
22	*111 903 519 A	Spring – Brush (generator 160 Watt)	2	
-	*111 903 537	End plate, fan side for generator 130 Watt	1	
23	*111 903 537 A	End plate, fan side for generator 160 Watt	1	
24	*111 903 541	Spring washer – Generator	1	
25	*111 903 545	Snap ring for generator	1	
26	*211 903 555	Bolt – Housing for generator	2	
27	N 12 006 2	Lockwasher B 6 DIN 127 galvanized	4	
28	N 11 006 2	Nut, hex., M 6 DIN 934 galvanized	2	
29	*111 903 565	Oil slinger for generator	2	
30	*111 903 801 C	Voltage regulator for generator	1	



Lacquer - a matter of confidence

The lacquer used by us had to undergo countless tests before it was deemed suitable and worthy to embellish and protect the Volkswagen.

Lacquers, too, are "spare parts".

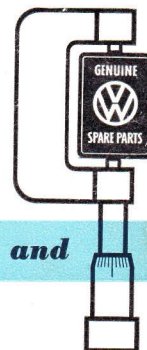

Each part is Factory Engineered and Inspected

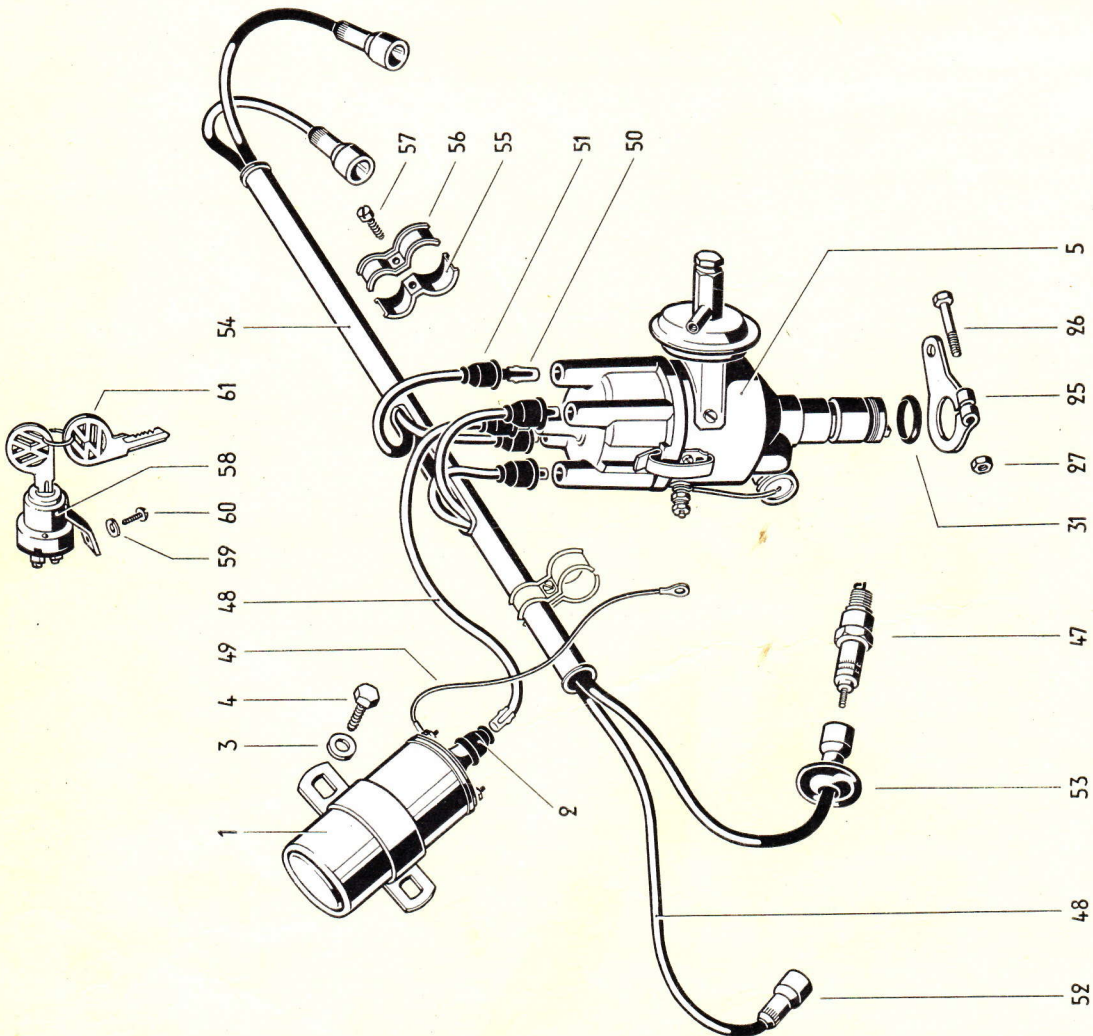
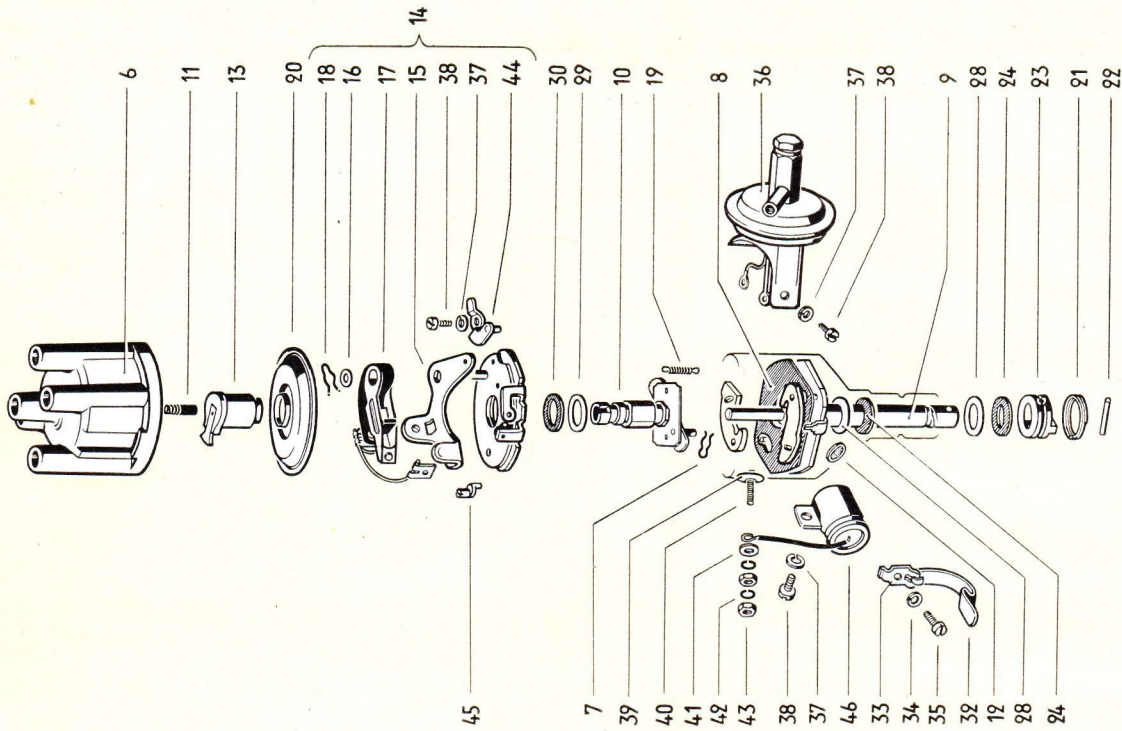

Illustration 37

Key No.	Part No.	Description	Quantity	Type and model
IGNITION				
1	*111 905 105 C	Coil	1	
2	*111 905 429	Cap (rubber) – Coil	1	
3	*111 605 289	Washer	2	
4	N 10 210 1	Bolt, hex. head, M 6×10 DIN 933 galvanized	2	
–	*211 905 205 C	Distributor up to engine No. 1 – 695 281	1	
5	111 905 205 C	Distributor from engine No. 1 – 695 282	1	
–	*111 905 207	Distributor cap with cover	1	
		(for distributor VE 4 BRS 383)		
–	*111 905 207 A	Distributor cap for screening	1	
		of distributor VE 4 BRS 383		
		(for use with 111 905 225 A only)		
6	*111 905 207 B	Distributor cap	1	
		(for distributors 211/111 905 205 C)		
7	*111 905 211	Spring clip for centrifugal weights	2	
8	*111 905 213	Damping plate	1	
		(for distributors 211/111 905 205 C)		
9	*111 905 217	Distributor shaft	1	
		(for distributors 211/111 905 205 C)		
10	111 905 219	Distributor cam	1	
		(for distributor 111 905 205 C)		
–	*211 905 219	Distributor cam	1	
		(for distributor 211 905 205 C)		
11	*111 905 221 A	Carbon brush with spring	1	
12	*111 905 223	Safety screen	1	
–	*111 905 225	Rotor (for distributor VE 4 BRS 383)	1	
–	*111 905 225 A	Rotor (screened) (for distributor VE 4 BRS 383) ..	1	
		(for use with 111 905 207 A only)		
13	*111 905 225 B	Rotor (for distributors 211/111 905 205 C)	1	
–	*111 905 225 C	Rotor (screened)	1	
		(for distributors 211/111 905 205 C)		

Key No.	Part No.	Description	Quantity	Type and model
-	*111 905 227	Contact breaker plate with distributor contacts ... (for distributors VE 4 BRS 383/211 905 205 C)	1	
14	*111 905 227 A	Contact breaker plate with distributor contacts ... (for distributor 111 905 205 C)	1	
-	*211 905 229 A	Point - Contact breaker (for distributors VE 4 BRS 383/211 905 205 C)	1	
15	111 905 229 A	Point - Contact breaker (for distributor 111 905 205 C)	1	
16	*111 905 231	Shim 0.2 mm. - Contact breaker arm	x	
-	*211 905 233 A	Arm - Contact breaker (for distributors VE 4 BRS 383/211 905 205 C)	1	<i>Function pointer</i>
17	111 905 233 A	Arm - Contact breaker (for distributor 111 905 205 C)	1	<i>Order in Detail</i>
18	*111 905 235	Spring clip - Contact breaker arm 111 905 233 A ..	1	<i>Old SP 181</i>
19	*111 905 237 A	Tension spring (for distributors 211/111 905 205 C)	2	<i>now SP 183</i>
-	*111 905 241	Sealing disc (for distributor VE 4 BRS 383)	1	
20	*111 905 241 A	Sealing disc (for distributors 211/111 905 205 C) ..	1	
21	*111 905 243	Lockring - Dog	1	
22	*111 905 245	Pin - Dog	1	
23	*111 905 247	Engaging dog	1	
24	*111 905 249	Distance washer - Dog	2	
25	*111 905 251	Retainer - Distributor	1	
26	N 10 344 1	Bolt, hex. head, M 6x28 DIN 931	1	
27	N 11 006 2	Nut, hex., M 6 DIN 934 galvanized	1	
28	*111 905 255	Shim plate on shaft	2	
29	*111 905 257	Shim plate (0.3 mm.) on cam	x	
30	*111 905 259	Plastic shim on cam	1	
31	*111 905 261	Sealing ring - Distributor	1	

Key No.	Part No.	Description	Quantity	Type and model
32	*111 905 265	Spring – Retainer for distributor cap	2	
-	*111 905 269	Clip – Retainer spring mounting	1	
33	*111 905 270	Clip (with lug) – Retainer spring mounting	1	
34	N 12 004 1	Lock washer B 4 DIN 127	2	
35	N 10 703 2	Screw, cheese head, AM 4×8 DIN 84 galvanized	2	
36	111 905 271 A	Vacuum unit – Distributor	1	
37	N 12 004 1	Lock washer B 4 DIN 127	3	
38	N 10 701 1	Screw, cheese head, AM 4×5 DIN 84 galvanized	3	
39	*111 905 273	Insulating washer for condenser connection	2	
40	N 10 262 1	Bolt, hex. head, M 4×20 DIN 933 galvanized	1	
41	N 11 555 1	Washer 4.3 DIN 433	4	
42	N 12 004 1	Lock washer B 4 DIN 127	2	
43	N 11 004 2	Nut, hex., M 4 DIN 934 galvanized	2	
44	111 905 279	Bracket for distributor dial	1	
		(for distributor 111 905 205 C)		
45	111 905 281	Eccentric bolt – Contact breaker	1	
		(for distributor 111 905 205 C)		
46	*111 905 295	Condenser – Distributor	1	
-	N 17 801 1	Sparking plug 175 (Bosch)	4	
47	N 17 801 3	Sparking plug 225 (Bosch)	4	
-	N 17 802 1	Sparking plug 175 (Beru)	4	
-	N 17 802 3	Sparking plug 225 (Beru)	4	
48	N 17 571 1	Ignition cable from coil via distributor to cylinder	*	
49	*111 905 421	Cable – Coil to distributor	1	
	<i>order</i> 113 905 421			

111 905 427 A Connector - Resistor type ignition cable 6
 N 18 387 1 Resistor type ignition cable from coil to distributor *
 and cylinder
 111 905 445 A Spark plug connector - Resistor type ignition cable 4

Ignition

			Quantity	Type and model
	*111 905 451	Holder for ignition cable		
50	*111 905 425	Connector - Ignition cable	6	
51	*111 905 429 <i>111 905 451</i>	Cap (rubber) - Distributor	5	
52	*111 905 445	Connector - Sparking plug	4	
53	*111 905 449 <i>111 905 451</i>	Rubber cap - Sparking plug	4	
54	*111 905 455	Conduit - Sparking plug cables	1	<i>HOLDER FOR IGNITION CABLE</i>
55	*111 905 471	Clamp, front - Conduit	2	
56	*111 905 475	Clamp, rear - Conduit	2	
57	N 11 389 1	Metal screw, cheese head, S 4.8x13 DIN 7971 ...	2	
-	*111 905 801	Ignition lock with key	1	up to chassis No. 1 - 397 022
-	111 905 801 A	Ignition lock with key	1	from chassis No. 1 - 397 023 up to 1 - 575 414
-	111 905 803	Ignition/starter lock with key	1	from chassis No. 1 - 575 415 up to 1 600 439
58	111 905 803 A	Ignition/starter lock with key	1	from chassis No. 1 600 440
59	N 11 523 1	Washer A 5.3 DIN 125	1	
60	N 10 810 1	Screw, fillister head, AM 5x6 DIN 85	1	
-	*111 905 815	Bakelite coupling - Ignition lock 111 905 801	1	
-	*111 905 817	Spring - Ignition lock 111 905 801	1	
-	*111 905 819	Contact piece - Ignition lock 111 905 801	1	
61	*111 837 219 A	Key - Ignition (specify key number)	2	
-	*111 905 851 A	Combined steering and ignition lock (quote color) up to chassis No. 1 - 575 414	1	
-	111 905 851 B	Lock, combined (steering, ignition, starter) (quote color) from chassis No. 1 - 575 415	1	
-	111 905 859	Fuse box with cover - Lock, combined	1	
-	111 905 861	Cover - Fuse box 111 905 859	1	
-	*111 905 881	Bolt - Steering lock	2	
	111 905 879	Insulating washer between combined ignition/ steering lock and steering column tube <i>See 10/shop Bulletin</i>	1	113, 114, 117, 118, 141-152

111 905 805 B Insert:
Ignition/starter lock with cylinder
lock for door handle
(to enable the customer to keep the
one key system)



They're all in the same boat,
and each one must do his best to steer it safe and sound through
the breakers of competition.

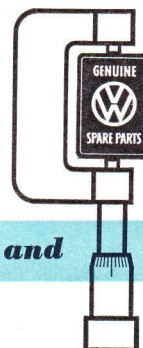

Each part is Factory Engineered and Inspected

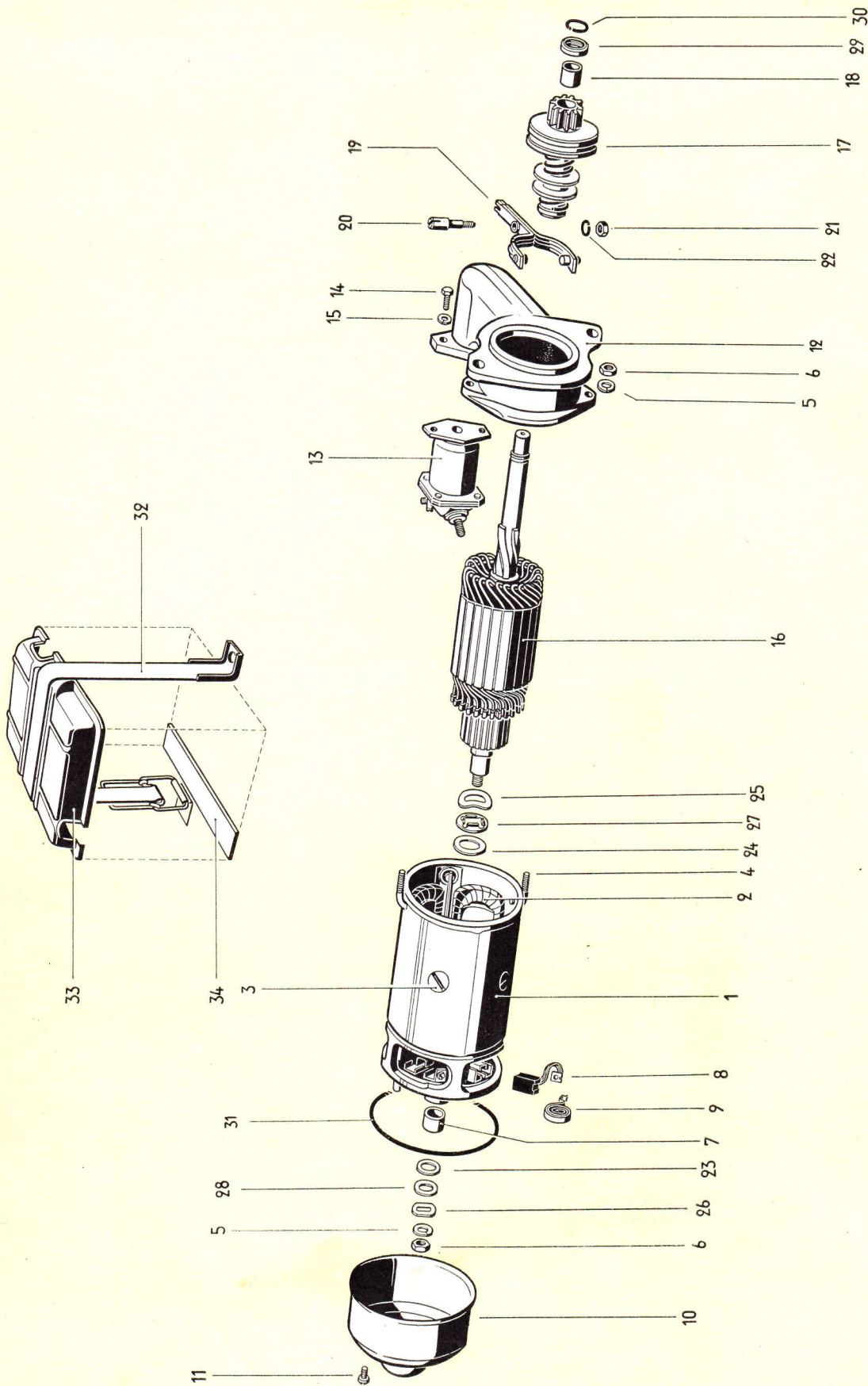

Illustration 38

Key No.	Part No.	Description	Quantity	Type and model
		STARTING MOTOR		
↩	*111 911 021 B <i>111 911 021 B</i>	Starting motor <i>MODIFIED ENGINE MECHANISM</i>	1	
-	*111 911 105	Housing with field coils - Starting motor 111 911 021	1	
1	*111 911 105 A	Housing with field coils - Starting motor 111 911 021 B	1	
-	*111 911 115	Field coil - Starting motor 111 911 021	1	
2	*111 911 115 A	Field coil - Starting motor 111 911 021 B	1	
3	N 10 999 1	Screw, countersunk head, M 10×13.5 DIN 63	4	
4	*111 911 145	Hook bolt	2	
5	N 12 234 1	Spring washer B 7 DIN 137	3	
6	N 11 007 1	Nut, hex., M 7 DIN 934	3	
-	*111 911 213	Commutator end bearing bush Starting motor 111 911 021 <i>OR 111 911 213 A</i>	1	
7	*111 911 213 A	Commutator end bearing bush - Starting motor 111 911 021 B	1	
-	*111 911 215	Carbon brush - Starting motor 111 911 021	2	
8	*111 911 215 A	Carbon brush - Starting motor 111 911 021 B	4	
9	*111 911 219	Spring - Brush (starting motor)	4	
10	*111 911 235	End cap for commutator bearing	1	
11	N 10 704 2	Screw, cheese head, AM 5×10 DIN 84, high-polish galvanized	2	
-	*111 911 255	Intermediate bearing - Starting motor 111 911 021	1	
12	*111 911 255 A	Intermediate bearing - Starting motor 111 911 021 B	1	
13	*111 911 285	Solenoid switch - Starting motor	1	
14	N 10 215 2	Bolt, hex. head, M 6×15 DIN 933, galvanized ...	2	
15	N 12 006 2	Lock washer B 6 DIN 127, galvanized	2	

Key No.	Part No.	Description	Quantity	Type and model
-	*111 911 309	Armature with starting motor drive	1	
-	*111 911 311	Armature – Starting motor 111 911 021	1	
16	*111 911 311 A	Armature – Starting motor 111 911 021 B	1	
-	*111 911 335	Drive – Starting motor 111 911 021	1	
17	*111 911 335 A	Drive – Starting motor 111 911 021 B	1	
18	*111 911 341	Bearing bush in pinion drive	1	
-	*111 911 343	Guide ring for pinion drive	1	
-	*111 911 343 A	Guide ring, rear, for pinion drive 111 911 335 A ..	1	
-	*111 911 349	Disc washer for pinion drive 111 911 335 A	1	
-	*111 911 351	Cover plate for pinion drive	1	
19	*111 911 365	Engaging fork – Starting motor drive	1	
20	*111 911 383	Bolt – Engaging fork	1	
21	N 11 006 2	Nut, hex., M 6 DIN 934, galvanized	1	
22	N 12 006 2	Lock washer B 6 DIN 127, galvanized	1	
23	*111 911 457	Butting ring	1	
24	*111 911 461	Insulating washer	1	
25	*111 911 471	Spring washer	1	
26	*111 911 473	Disc washer	1	
27	*111 911 475	Holding ring	1	
28	*111 911 477	Shim	1	
-	*111 911 479	Stop ring on armature shaft	1	
29	*111 911 479 A	Stop ring on armature shaft	1	

Key No.	Part No.	Description	Quantity	Type and model
30	*111 911 485	Circlip on armature shaft	1	
31	*111 911 499	Gasket – Cap	1	
-	*111 911 509	Push buffon – Starter, black	1	111, 112, 115, 116
		up to chassis No. 1 – 397 022		
-	*113 911 509	Push button – Starter, ivory	1	113, 114, 117, 118,
		up to chassis No. 1 – 397 022		151, 152
-	*111 911 511	Push buffon – Starter	1	
		from chassis No. 1 – 397 023 up to 1 – 575 414		
-	*111 911 911	Rubber sleeve for starter wiring	1	
BATTERY MOUNTING				
-	111 915 305	Mounting strap – Battery	1	
		from chassis No. 1 – 397 023 up to 1 – 575 414		
-	111 915 305 A	Mounting strap – Battery	1	
		from chassis No. 1 – 575 415 up to 1 – 929 745		
32	111 915 305 B	Mounting strap – Battery	1	
		from chassis No. 1 – 929 746		
-	*111 915 331	Retaining clip – Battery	2	
		up to chassis No. 1 – 397 022		
-	*111 915 333	Spring – Battery cover	2	
		up to chassis No. 1 – 397 022		
-	*111 915 405	Cover – Battery up to chassis No. 1 – 397 022	1	
-	111 915 405 A	Cover – Battery	1	
		from chassis No. 1 – 397 023 up to 1 – 929 745		
33	111 915 405 B	Cover – Battery from chassis No. 1 – 929 746	1	
34	*111 915 441	Mat – Battery well	2	

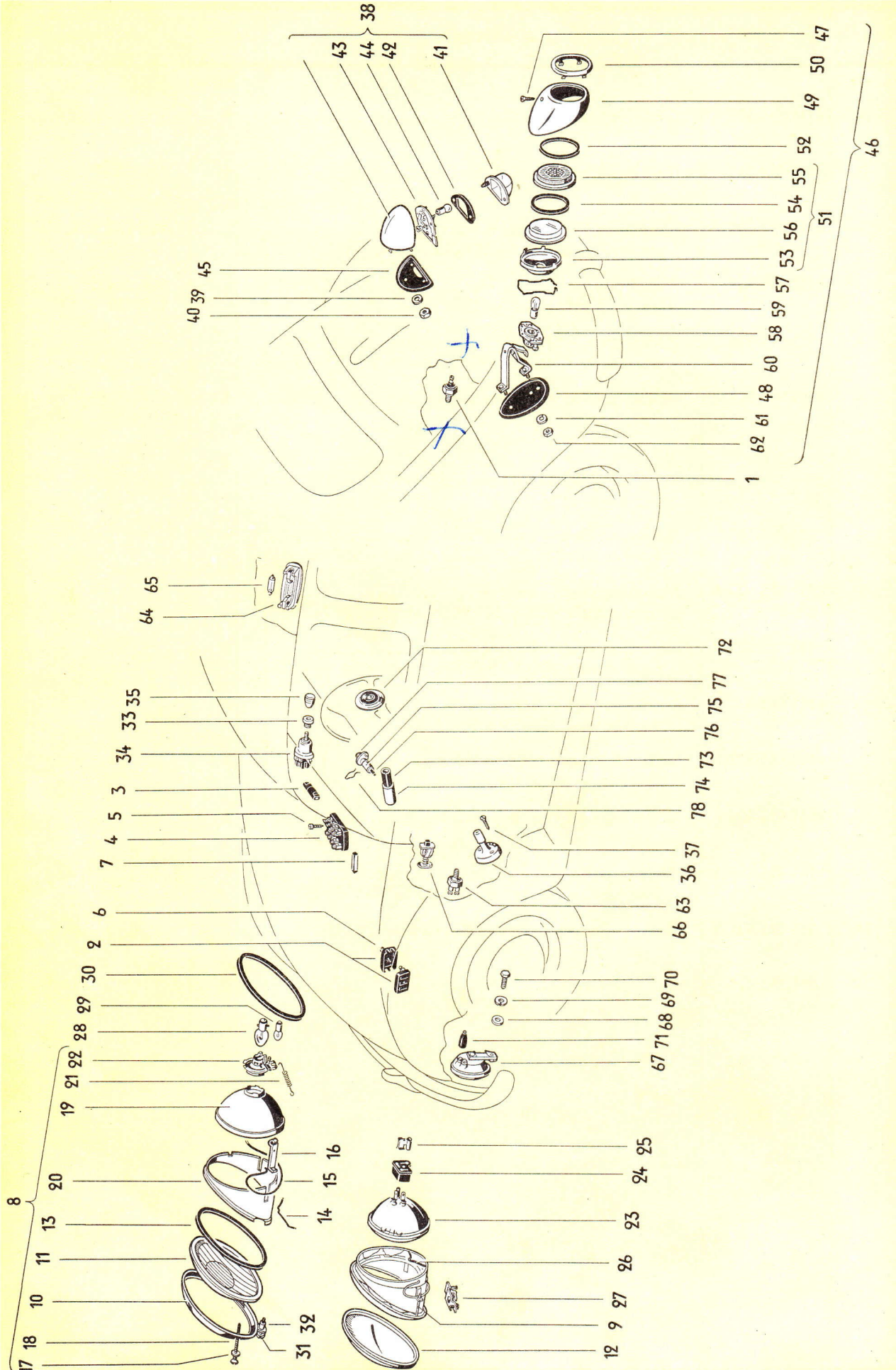

Illustration 39

Key N	*111 919 237 N 17 722 1	Parking light - Warning lamp Indicator bulb J 6 V 1.2 W DIN 72 601 <i>FOR ITALY ONLY.</i>	1 1	M 34, M 35 M 34, M 35	al
INSTRUMENTS					
-	111 919 031 <i>143 919 031 D.</i>	Fuel gauge (on instrument panel) <i>up to Chassis No 1 - 929 7445</i> <i>Fuel gauge " " from Chassis No 1 929 746.</i>	1		
-	*111 919 051	Fuel gauge, tank unit up to chassis No. 1 - 929 745	1		
-	111 919 051 A	Fuel gauge, tank unit from chassis No. 1 - 929 746	1		
-	111 919 081	Switch - Oil pressure up to engine No. 1 - 090 761	1	111, 112	
1	*111 919 081 A	Switch - Oil pressure from engine No. 1 - 090 762	1		
-	*271 919 125	Gasket - Fuel gauge tank unit	2		
-	111 919 201	Clock, electric - Instrument panel from chassis No. 1 - 397 023 up to 1 600 439	1		
INSTRUMENT PANEL					
-	111 925 051	Bakelite plate, left - Instrument panel (black) up to chassis No. 1 - 397 022	1	111, 112, 115, 116	
-	*113 925 051	Bakelite plate, left - Instrument panel (ivory) up to chassis No. 1 - 397 022	1	113, 114, 117, 118, 151, 152	
-	*113 925 052	Bakelite plate, right - Instrument panel (ivory) up to chassis No. 1 - 397 022	1	113, 114, 117, 118, 151, 152	
-	111 925 102	Bakelite plate, right - Instrument panel (black) up to chassis No. 1 - 397 022	1	111, 112, 115, 116	
-	N 17 721 1	Indicator bulb I 6 V 0.6 W DIN 72 601	4		
-	N 17 601 1	Socket - Indicator bulb	4		
-	*111 925 079	Switch - Light and windshield wiper (black) up to chassis No. 1 - 397 022	2	111, 112, 115, 116	
-	*113 925 079	Switch - Light and windshield wiper (ivory) up to chassis No. 1 - 397 022	2	113, 114, 117, 118, 151, 152	
-	113 925 161	Bracket - Speedometer mounting up to chassis No. 1 - 397 022	2 4	111, 112, 115, 116 113, 114, 117, 118, 151, 152	
-	*111 925 231	Control eye green - Instrument panel up to chassis No. 1 - 397 022	1		
-	*111 925 231 A	Control eye green with case - Instrument panel ... up to chassis No. 1 - 397 022	1		
-	*111 925 233	Control eye red - Instrument panel up to chassis No. 1 - 397 022	2		

Key No.	Part No.	Description	Quantity	Type and model
-	*111 925 233 A <i>Order 111 925 233</i>	Control eye red with case – Instrument panel up to chassis No. 1 – 397 022	2	
-	*111 925 235	Control eye blue – Instrument panel up to chassis No. 1 – 397 022	1	
-	*111 925 235 A <i>Order 111 925 235</i>	Control eye blue with case – Instrument panel up to chassis No. 1 – 397 022	1	
-	*111 925 241	Lockring – Control eye up to chassis No. 1 – 397 022	4	
-	*111 925 271	Screw – Bakelite plate up to chassis No. 1 – 397 022	4	
-	*111 925 275	Bracket – Bakelite plate up to chassis No. 1 – 397 022	4	
-	N 11 651 1	Washer 5.8 galvanized	4	
-	N 11 005 2	Nut, hex., M 5 DIN 934 galvanized	4	
-	*111 925 301	Sealing strip – Bakelite plate up to chassis No. 1 – 397 022	2	111, 112, 115, 116
-	*113 925 301 <i>Order 111 925 301</i>	Sealing strip – Bakelite plate up to chassis No. 1 – 397 022	2	113, 114, 117, 118, 151, 152
FUSE BOX				
-	111 937 011	Fuse box (3 fuses) up to chassis No. 1 – 575 414 ..	1	
-	N 10 702 1	Screw, cheese head, AM 5×15 DIN 84	2	
-	*111 937 031	Fuse box (6 fuses) up to chassis No. 1 – 575 414 ...	1	
-	N 10 702 1	Screw, cheese head, AM 5×15 DIN 84	2	
-	N 12 225 1	Spring washer B 5 DIN 137 galvanized	2	
-	N 11 005 2	Nut, hex., M 5 DIN 934 galvanized	2	
2	111 937 041	Fuse box (2 fuses) from chassis No. 1 – 575 415	1	
-	N 11 389 1	Metal screw, cheese head, S 4.8×13 DIN 7971	2	
3	111 937 091	Connector with fuse	1	
-	N 17 471 0	Connector	4	

Key No.	Part No.	Description	Quantity	Type and model
-	*111 937 155	Cover - Fuse box (6 fuses)	1	
4	111 937 205	Fuse box (4 fuses) without cover	1	
		from chassis No. 1 - 397 023		
-	N 10 700 1	Screw, cheese head, AM 5×12 DIN 84,	2	
		high-polish galvanized		
5	N 11 389 1	Metal screw, cheese head, S 4.8×13 DIN 7971	2	
-	111 937 255	Cover - Fuse box (4 fuses)	1	
		from chassis No. 1 - 397 023 up to 1 - 575 414		
-	111 937 355	Cover - Fuse box (3 fuses)	1	
6	111 937 455	Cover - Fuse box (2 fuses)	1	
7	N 17 121 1	Fuse 8 DIN 72 581	6	
112 941 039		Headlamp (asymmetrical) (left-hand traffic only)	2	
-	111 941 021 A	Headlamp (Bosch)	2	
8	111 941 021 B	Headlamp (Hella)	2	
-	111 941 031 C	Headlamp (Bosch), for Holland only	2	
-	111 941 031 D	Headlamp (Hella), for Holland only	2	
-	111 941 031 E	Headlamp (Hella), for France only	2	
-	151 941 031	Headlamp prime-coated	2	
9	111 941 037 A	Headlamp, for USA only	2	
10	*111 941 111	Rim - Headlamp glass for headlamp (Hella)	2	
-	111 941 111 A	Rim - Headlamp glass for headlamp (Bosch)	2	
-	*151 941 111	Rim - Headlamp glass for headlamp prime-coated	2	
11	111 941 115	Glass - Headlamp (Hella)	2	
-	111 941 115 A	Glass - Headlamp (Bosch)	2	
12	*111 941 115 B	Glass - Headlamp, clear, for USA only	2	
	112 941 115	Glass - Headlamp (asymmetrical) (left-hand traffic only)	2	

Key No.	Part No.	Description	Quantity	Type and model
-	111 941 115 C	Glass – Headlamp, for France only	2	
-	111 941 115 D	Glass – Headlamp, for Holland only (Hella)	2	
-	111 941 115 E	Glass – Headlamp, for Holland only (Bosch)	2	
13	*111 941 119	Sealing ring – Headlamp glass (Hella)	2	
-	*111 941 119 A	Sealing ring – Headlamp glass (Bosch)	2	
14	*111 941 125 A	Retainer spring – Headlamp glass (Hella)	14	
-	*111 941 125 B	Retainer spring – Headlamp glass (Bosch)	14	
15	*111 941 135	Spring clip – Headlamp	2	
16	*111 941 137	Adjusting hook – Headlamp	4	
17	*111 941 139	Gasket – Adjusting screw (Hella)	4	
-	111 941 139 A	Washer – Adjusting screw (Bosch)	4	
-	*111 941 141	Adjusting screw length: 109 mm. (Hella)	4	
-	111 941 141 A	Adjusting screw length: 55 mm. (Bosch)	4	
-	*111 941 141 B	Adjusting screw length: 95 mm. (Hella)	4	
18	*111 941 141 C	Adjusting screw length: 56 mm. (Hella)	4	
-	*111 941 143	Spring length: 45 mm. – Adjusting screw 111 941 141	4	
-	111 941 143 A	Spring length: 50 mm. –	4	
		Adjusting screw 111 941 141 A		
-	*111 941 143 B	Spring length: 105 mm. –	4	
		Adjusting screw 111 941 141 B		
-	*111 941 145	Nut – Adjusting screw (Hella)	4	
-	111 941 145 A	Nut – Adjusting screw (Bosch)	4	
-	N 12 502 1	Split pin 1.5×10 DIN 94	4	
-	111 941 151	Reflector – Headlamp less spring clip (Hella)	2	
	111 941 151 D	HEADLAMP SYMMETRICAL R-HAND TRAFFIC ONLY.	2	

N 17 705 2

Insert:
Bulb A 6 V 45/40 W
(for asymmetrical low beam headlights
and left-hand traffic only)

			Quantity	Type and model
-	111 941 151 A	Reflector – Headlamp (Bosch)	2	
19	111 941 151 B	Reflector – Headlamp (Hella)	2	
-	*111 941 153	Retainer – Headlamp reflector 111 941 151	2	
-	111 941 153 A	Retainer – Headlamp reflector 111 941 151 A	2	
20	*111 941 153 B	Retainer – Headlamp reflector 111 941 151 B	2	
-	111 941 153 C	Retainer – Sealed Beam Unit (for USA only)	2	
21	*111 941 157	Spring – Bulb socket (Hella)	2	
-	111 941 157 A	Mounting bracket for bulb socket	2	
-	111 941 159 A	Bulb socket – Headlamp (Bosch)	2	
22	*111 941 159 B	Bulb socket – Headlamp (Hella)	2	
-	*111 941 159 C	Bulb socket – Headlamp (for France only)	2	
23	*111 941 161	Sealed Beam Unit (for USA only)	2	
24	*111 941 165	Contact plate – Sealed Beam Unit (for USA only) ..	2	
25	*111 941 167	Contact spring – Sealed Beam Unit (for USA only)	6	
26	*111 941 171	Retaining spring – Sealed Beam Unit (for USA only)	10	
27	*111 941 173	Bulb socket – Parking light (for USA only)	1	
28	N 17 701 1	Bulb B 6 V 35/35 W DIN 72 601 – Headlamp	2	
29	N 17 720 1	Bulb H 6 V 2 W DIN 72 601 – Parking light	2	
	111 941 189 <i>IN 20 061 1</i>	Cabel sleeve – Headlamp housing (for USA only) ..	2	
30	*111 941 191 <i>AL 20 061 1</i>	Gasket between headlamp and fender	2	
31	*111 941 195	Mounting screw – Headlamp	2	
32	*111 941 197	Distance piece – Headlamp mounting screw	2	



Key No.	Part No.	Description	Quantity	Type and model
33	111 941 515	Escutcheon for push-pull type switch from chassis No. 1 600 440	1	
-	111 941 531 A	Push-pull type switch – Headlight up to chassis No. 1 600 439	1	
-	111 941 531 B	Push-pull type switch – Headlight (for USA only) . . up to chassis No. 1 600 439	1	
-	N 11 523 1	Washer A 5.3 DIN 125	1	
-	N 10 810 1	Screw, fillister head, AM 5×6 DIN 85	1	
34	111 941 531 D	Push-pull type switch – Headlight from chassis No. 1 600 440	1	
-	*111 941 541	Knob – Push-pull type switch, black	1	111, 112, 115, 116
35	*113 941 541	Knob – Push-pull type switch, ivory	1	113, 114, 117, 118, 151, 152
36	*211 941 561	Switch – Foot dipper <i>ORDER 111 941 561 A</i> <i>CHANGE IN PRODUCTION</i>	1	
-	N 10 925 1	Screw, countersunk head, BM 5×25 DIN 63	2	
37	N 11 340 1	Metal screw, countersunk head, S 4.8×32 DIN 7972	2	
LICENCE PLATE LIGHT				
-	111 943 025	Stop and licence plate light up to chassis No. 1 – 397 022	1	
38	111 943 025 E	Licence plate light from chassis No. 1 600 440	1	
-	111 943 111 A	Housing – Licence plate light from chassis No. 1 – 397 023 up to 1 600 439	1	
39	N 12 005 1	Lock washer B 5 DIN 127 galvanized	3	
40	N 11 005 2	Nut, hex., M 5 DIN 934 galvanized	1	
-	N 11 173 1	Wing nut M 5 DIN 315	2	
41	111 943 119	Lens – Licence plate light from chassis No. 1 600 440	1	
-	111 943 121	Lens – Licence plate light up to chassis No. 1 – 397 022	1	
-	111 943 121 A	Lens – Licence plate light from chassis No. 1 – 397 023 up to 1 600 439	1	
-	111 943 121 C	Lens – Licence plate light (for USA only) up to chassis No. 1 600 439	1	

Key No.	Part No.	Description	Quantity	Type and model
-	111 943 123	Lens - Stop light (Cellon) up to chassis No. 1 - 397 022	1	
-	111 943 131	Gasket - Licence plate light lens 111 943 121 A/C	1	
42	111 943 131 B	Gasket - Licence plate light lens 111 943 119	1	
-	111 943 139	Disc - Licence plate light (for USA only) up to chassis No. 1 600 439	1	
-	111 943 143	Cable sleeve - Disc (for USA only) up to chassis No. 1 600 439	1	
-	111 943 161	Bulb holder - <i>NOT AVAILABLE</i> Stop and licence plate light 111 943 025	1	
-	N 17 716 1	Bulb F 6 V 15 W DIN 72 601 - Stop light	1	
-	111 943 161 A	Bulb holder - Licence plate light from chassis No. 1 - 397 023 up to 1 600 439	1	
-	111 943 161 C	Bulb holder - Licence plate light (for USA only) up to chassis No. 1 600 439	1	
-	N 17 723 1	Bulb K 6 V 10 W DIN 72 601 - Licence plate light	1	
43	111 943 161 E	Bulb holder - Licence plate light from chassis No. 1 600 440	1	
44	N 17 718 1	Bulb G 6 V 5 W DIN 72 601	1	
-	111 943 185	Washer - Stop and licence plate light 111 943 025	1	
-	111 943 191	Gasket - Stop and licence plate light 111 943 025	1	
-	111 943 191 A	Gasket - Licence plate light from chassis No. 1 - 397 023 up to 1 600 439	1	
45	111 943 191 C	Gasket - Licence plate light from chassis No. 1 600 440	1	
-	111 943 197	Gasket - Disc (for USA only) up to chassis No. 1 600 439	1	
TAIL LIGHT				
-	111 945 081	Stop and tail light, left (for USA only) up to chassis No. 1 - 871 206	1	
-	111 945 082	Stop and tail light, right (for USA only) up to chassis No. 1 - 871 206	1	
-	111 945 091	Reflector and tail light, left up to chassis No. 1 - 397 022	1	

Key No.	Part No.	Description	Quantity	Type and model
-	111 945 091 A	Stop and tail light, left from chassis No. 1 - 397 023 up to 1 - 929 745	1	
-	111 945 092	Reflector and tail light, right up to chassis No. 1 - 397 022	1	
-	111 945 092 A	Stop and tail light, right from chassis No. 1 - 397 023 up to 1 - 929 745	1	
46	111 945 095	Stop and tail light, left from chassis No. 1 - 929 746	1	
-	111 945 095 A	Stop and tail light, left (with bezel prime-coated) from chassis No. 1 - 929 746	1	
-	111 945 096	Stop and tail light, right from chassis No. 1 - 929 746	1	
-	111 945 096 A	Stop and tail light, right (with bezel prime-coated) from chassis No. 1 - 929 746	1	
-	111 945 111	Housing - Reflector and tail light, left up to chassis No. 1 - 397 022	1	
-	111 945 111 B	Housing - Stop and tail light, left from chassis No. 1 - 397 023 up to 1 - 929 745	1	
-	111 945 112	Housing - Reflector and tail light, right up to chassis No. 1 - 397 022	1	
-	111 945 112 B	Housing - Stop and tail light, right from chassis No. 1 - 397 023 up to 1 - 929 745	1	
-	111 945 115	Housing - Stop and tail light 111 945 081 (for USA only)	1	
-	111 945 116	Housing - Stop and tail light 111 945 082 (for USA only)	1	
-	111 945 121	Lens stop light, orange from chassis No. 1 - 397 023 up to 1 - 929 745	2	
-	111 945 121 B	Lens stop light, red from chassis No. 1 - 397 023 up to 1 - 929 745	2	
-	111 945 125	Spring - Stop light lens from chassis No. 1 - 397 023 up to 1 - 929 745	2	
-	111 945 131	Tail light lens with rim up to chassis No. 1 - 397 022	2	
-	111 945 131 B	Tail light lens with rim from chassis No. 1 - 397 023 up to 1 - 929 745	2	
-	111 945 131 D	Tail light lens with rim (for USA only) up to chassis No. 1 - 871 206	2	
-	111 945 145	Retainer spring - Tail light lens with 3 lobes up to chassis No. 1 - 397 022	2	
-	111 945 145 A	Retainer spring - Tail light lens up to chassis No. 1 - 397 022	2	
-	111 945 161	Base plate - Reflector and tail light, left up to chassis No. 1 - 397 022	1	

*111 919 237	Parking light - Warning lamp	2	M 36
*111 919 237	Parking light - Warning lamp	2	M 35
111 945 191 C	Gasket between stop-tail-blinker lamp (for Australia and Italy only)	2	M 32
111 945 199	Grommet (for Australia and Italy only)	2	M 32
111 945 205 B	Housing - Stop-tail-blinker lamp left (for Australia and Italy only)	1	M 32
111 945 206 B	Housing - Stop-tail-blinker lamp right (for Australia and Italy only)	1	M 32
111 945 233	Lens - Stop-tail-blinker lamp (for Australia and Italy only)	2	M 32
N 14 124 1	Screw, fillister head, BM 4 x 35 DIN 7985 chromium plated	4	M 32

type and model

-	N 17 718 1	Bulb G 6 V 5 W DIN 72 601 - tail light ... up to chassis No. 1 - 929 745	
-	N 17 716 1	Bulb F 6 V 15 W DIN 72 601 - Stop light up to chassis No. 1 - 929 745	2
-	111 945 165	Bulb holder, left (for USA only) up to chassis No. 1 - 871 206	1
-	111 945 166	Bulb holder, right (for USA only) up to chassis No. 1 - 871 206	1
47	111 945 185	Screw, Phillips head, for stop and licence plate ...	2
-	111 945 191	Gasket between tail light case and fender up to chassis No. 1 - 397 022	2
-	111 945 191 A	Gasket between stop and tail light and fender .. from chassis No. 1 - 397 023 up to 1 - 929 745	2
48	111 945 191 B	Gasket between stop and tail light and fender .. from chassis No. 1 - 929 746	2
49	111 945 215	Housing - Stop and tail light, left from chassis No. 1 - 929 746	1
-	111 945 216	Housing - Stop and tail light, right from chassis No. 1 - 929 746	1
50	111 945 219	Bezel from chassis No. 1 - 929 746	2
-	111 945 219 A	Bezel prime-coated from chassis No. 1 - 929 746 ..	2
51	111 945 231	Reflector and glass from chassis No. 1 - 929 746	2
52	111 945 235	Seal between reflector and housing from chassis No. 1 - 929 746	2
53	111 945 237	Reflector - Stop and tail light from chassis No. 1 - 929 746	2
54	111 945 239	Gasket (rubber) - Tail light lens from chassis No. 1 - 929 746	2
55	111 945 241	Reflector lens - Stop and tail light from chassis No. 1 - 929 746	2
56	111 945 243	Disc (Cellon) - Stop and tail light from chassis No. 1 - 929 746	2

111 945 261 B	Bulb holder - Stop-tail-blinker lamp (for Australia and Italy only)	2	M 32	
N 17 731 1	Bulb R 6 V 18 W DIN 72 601	2	M 32	
N 10 802 2	Screw, fillister head, AM 3 x 6 DIN 85	2	M 32	
N 12 003 1	Lock washer B 3 DIN 127	2	M 32	and model

57	111 945 245	Spring clip - Reflector	2	
		from chassis No. 1 - 929 746		
58	111 945 261	Bulb holder from chassis No. 1 - 929 746	2	
59	N 17 736 1	Bulb S 6 V 20/5 W DIN 72 601	2	
60	111 945 291	Mounting bracket, left	1	
		from chassis No. 1 - 929 746		
-	111 945 292	Mounting bracket, right	1	
		from chassis No. 1 - 929 746		
61	N 12 005 1	Lock washer B 5 DIN 127 galvanized	4	
62	N 11 005 2	Nut, hex., M 5 DIN 934 galvanized	4	
-	111 945 511	Switch - Stop light	1	111, 112, 115, 116
-	N 10 715 2	Screw, cheese head, AM 6x15 DIN 84 galvanized	2	111, 112, 115, 116
-	N 12 226 2	Spring washer B 6 DIN 137 galvanized	2	111, 112, 115, 116
63	*113 945 515	Switch - Stop light (hydraulic brake)	1	113, 114, 117, 118, 151, 152
INTERIOR LIGHT				
-	113 947 105	Interior light up to chassis No. 1 - 397 022		<i>NOT AVAILABLE</i>
-	151 947 105	Interior light up to body No. 39 038	1	151, 152
-	<i>order?</i> 151 947 103			
-	N 17 718 1	Bulb G 6 V 5 W DIN 72 601 - Interior light	1	
64	111 947 111 A	Interior light, with switch	1	111-118
		from chassis No. 1 - 397 023		
-	143 947 111	Interior light, with switch	1	151, 152
		from body No. 39 039		
65	N 17 723 1	Bulb K 6 V 10 W DIN 72 601 -	1	
		Interior lights 111 947 111 A/143 947 111		
-	111 947 125	Glass - Interior light up to chassis No. 1 - 397 022	1	111-118
-	151 947 125	Glass - Interior light 151 947 105	1	151, 152
-	111 947 141	Retainer ring - Interior light glass	1	111-118
		up to chassis No. 1 - 397 022		
-	111 947 151	Packing - Interior light up to chassis No. 1 - 397 022	1	111, 112, 115, 116

Key No.	Part No.	Description	Quantity	Type and model
-	113 947 151	Packing - Interior light up to chassis No. 1 - 397 022 <i>NOT AVAILABLE</i>	1	113, 114, 117, 118
-	*151 947 511	Tumbler switch - Interior light from chassis No. 1 - 397 023 up to 1 - 575 414	1	
-	*111 947 541	Knob - Tumbler switch (black)	1	111, 112, 115, 116
-	*113 947 541	Knob - Tumbler switch (ivory)	1	113, 114, 117, 118, 151, 152
-	113 947 561	Switch - Door contact	2	113, 114, 117, 118, 151, 152
-	N 10 970 1	Screw, countersunk head, AM 4x8 DIN 63	4	113, 114, 117, 118, 151, 152
66	113 947 561 A	Switch - Door contact	2	113, 114, 117, 118, 151, 152
HORN				
67	*111 951 111	Horn (Hella)	1	
-	*111 951 111 A <i>111 951 111 C</i>	Horn (Bosch)	1	
68	N 11 526 2	Washer B 8.4 DIN 125 high-polish galvanized	1	
69	N 12 008 2	Lock washer B 8 DIN 127 galvanized	1	
70	N 10 325 1	Bolt, hex. head, BM 8x25 DIN 931	1	
-	111-951-133	Cover - Horn, chromium plated <i>NOT SUPPLIED</i>	1	111, 112, 115, 116
71	*111 951 195 <i>111 951 195 A</i>	Grommet - Horn	2	
-	*111 951 299	Housing - Horn <i>NOT SUPPLIED</i>	1	113, 114, 117, 118, 151, 152
-	111-951-499	Button - Horn up to chassis No. 1 - 072 904	1	111, 112
-	111 951 501	Button - Horn from chassis No. 1 - 072 905	1	111, 112, 115, 116
-	*113 951 501 A	Button - Horn (quote color)	1	113, 114, 117, 118, 151, 152
-	N 13 075 1	Stud M 4x5 DIN 551	1	
72	*113 951 501 B	Button - Horn (quote color)	1	113, 114, 117, 118, 151, 152
-	N 13 072 1	Stud M 2.6x5 DIN 551	1	113, 114, 117, 118, 151, 152

Key No.	Part No.	Description	Quantity	Type and model
-	111 951 503	Retainer – Horn button up to chassis No. 1 – 072 904	1	111, 112
-	111-951-505	Contact spring – Horn button <i>NOT SUPPLIED</i>	1	111, 112
-	111 951 509	Contact plate – Horn button 111 951 499 <i>NOT AVAILABLE</i>	1	111, 112
73	111 951 571	Insulator – Horn	1	
74	111 951 573	Collector ring – Horn	1	
75	111 951 575	Carbon brush with retainer – Horn	1	
76	111 951 581	Carbon with spring	1	
77	111 951 589	Threaded cap – Retainer	1	
78	*111 109 425	Spring clip	1	

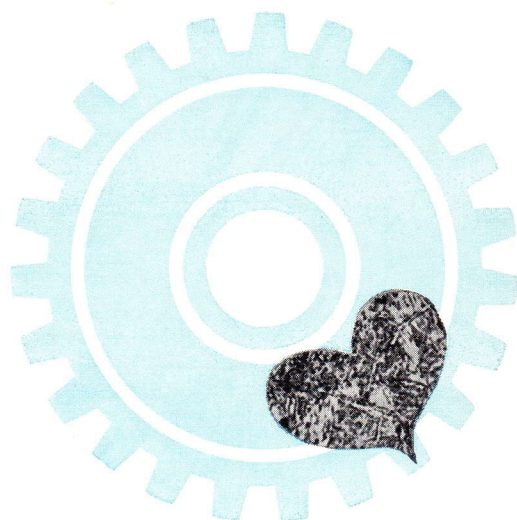

We go to the heart of the matter

That is, we don't stop with conventional precision instruments which measure mere thousandths. We call in the electrons. Magnifications up to 80,000 times are common in our laboratories.

Such precision costs a fortune which we willingly invest to make sure of satisfying our customers, the Volkswagen owners.

Genuine VW Spare Parts, like Volkswagens, are rigidly factory inspected.

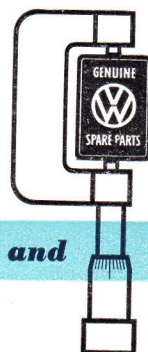

Each part is Factory Engineered and Inspected

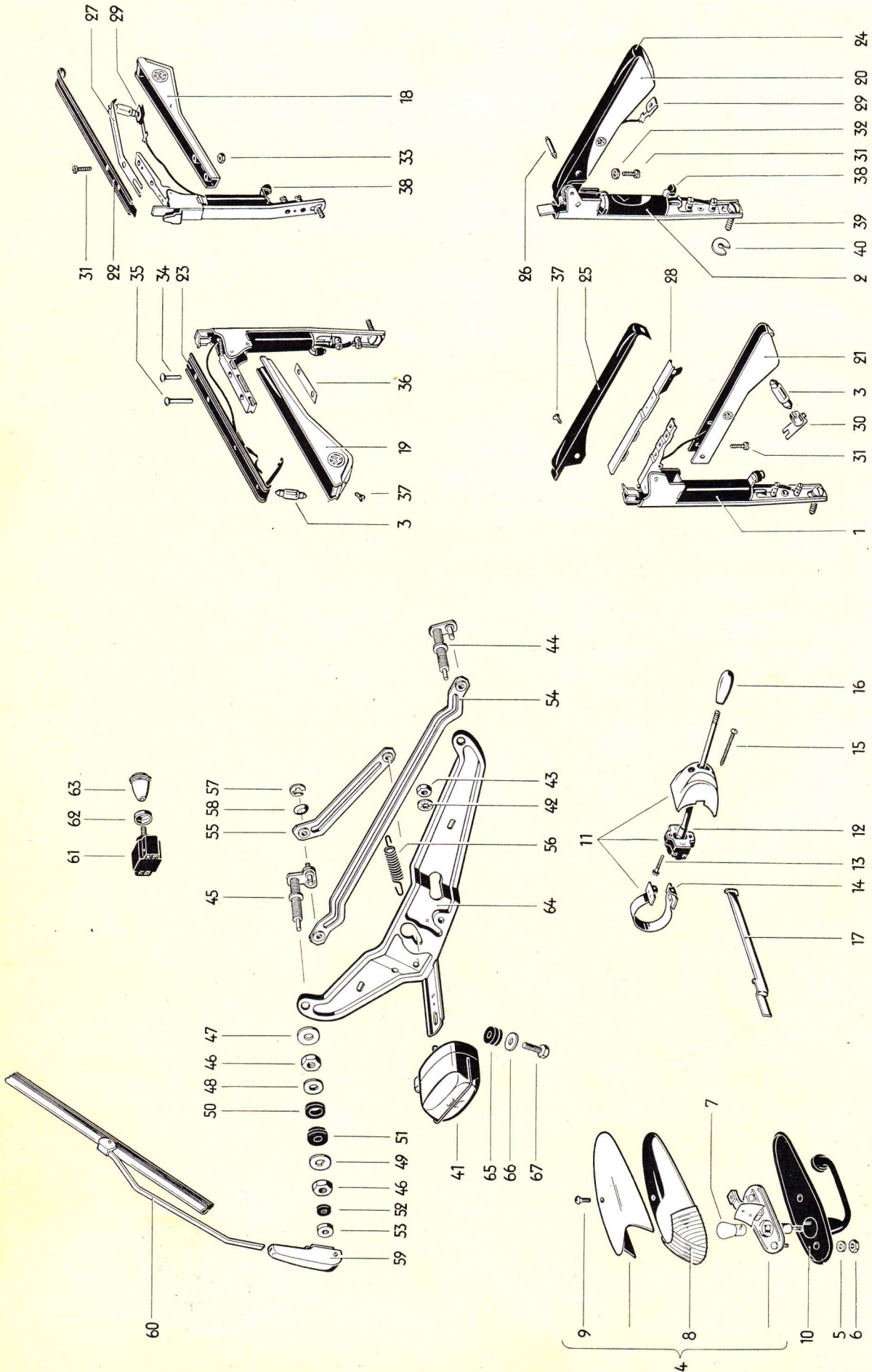

Illustration 40

	Description	Quantity	Type and model
111 953 163 A	Housing - Blinker, front from chassis No. 1 600 440 up to 2 318 714	2 M 162	
111 953 163 B	Housing - Blinker, front from chassis No. 2 318 715	2 M 162	
1	*111 953 021 C Direction indicator		111-118
2	*111 953 021 D Direction indicator <i>111 953 021 F</i>	2	111-118
-	<i>151 953 021 A</i> <i>151 953 021 B</i> Direction indicator	2	151, 152
3	N 17 726 1 Bulb M 6 V 3 W DIN 72 601	2	
4	111 953 041 A Blinker lamp, front from chassis No. 1 600 440	2	
5	N 12 005 1 Lock washer B 5 DIN 127, galvanized	4	
6	N 11 005 2 Nut, hex., M 5 DIN 934, galvanized	4	
-	*141 953 051 Bulb holder - Blinker lamp, front	2	
	up to chassis No. 1 600 439		
7	N 17 730 1 Bulb R 6 V 20 W DIN 72 601	2	
-	*141 953 153 Seal between bulb holder and fender	2	
	up to chassis No. 1 600 439		
-	N 12 135 1 Shake-proof washer J 21 DIN 6797	2	
-	*141 953 159 Nut, hex., M 20×1 up to chassis No. 1 600 439 ...	2	
-	*111 953 161 Lens - Blinker, front up to chassis No. 1 600 439 ..	2	
-	N 10 866 1 Screw, countersunk raised head,	4	
	M 4×10×2.5 DIN 924, chromium plated		
8	111 953 161 A Lens - Blinker, front from chassis No. 1 600 440 ..	2	
9	<i>111 953 163 B</i> <i>BLINKER FRONT HOUSING FRONT LOWER EDGES HAVE</i> Screw for lens - Bulb holder	2	<i>ROUNDED OFF</i>
	from chassis No. 1 600 440		
-	111 953 163 Housing - Blinker, front, left	1	
	up to chassis No. 1 600 439		
-	111 953 164 Housing - Blinker, front, right	1	
	up to chassis No. 1 600 439		
-	*111 953 165 Packing - Housing up to chassis No. 1 600 439 ...	2	
-	111 953 175 Sleeve - Blinker cable up to chassis No. 1 600 439	2	
-	*141 953 185 B Relay - Blinker	1	
-	<i>111 953 163 A</i> <i>BLINKER FRONT HOUSING</i> <i>under 111 953 163 B</i>	2	

Key No.	Part No.	Description	Quantity	Type and model
10	111 953 193	Packing – Blinker lamp, front from chassis No. 1 600 440	2	
-	111 953 511	Switch – Direction indicator (black) up to chassis No. 1 – 397 022	1	111, 112, 115, 116
11	111 953 511 A	Switch – Direction indicator (on steering column tube) (quote color) from chassis No. 1 – 397 023	1	
-	113 853 511	Switch – Direction indicator (ivory) up to chassis No. 1 – 397 022	1	113, 114, 117, 118, 151, 152
-	111 953 513	Blinker – Self-cancelling switch <i>118 953 511 A / 517 See 4/5 Bulletin B. 5b.</i>	1	
-	111 953 519 A	Blinker – Self-cancelling switch without housing ..	1	
12	111 953 521	Switch – Direction indicator without housing	1	
13	N 11 230 1	Screw, button head, BM 3×12 DIN 86	2	
-	*111 953 523	Screw, fillister head, M 3×5 – Self-cancelling ... switch for blinker	2	
14	111 953 531	Clamp – Direction indicator switch	1	
15	111 953 539	Screw, button head – Clamp	2	
-	*111 953 541	Knob black – Direction indicator switch from chassis No. 1 – 397 023	1	111, 112, 115, 116
16	*113 953 541	Knob ivory – Direction indicator switch from chassis No. 1 – 397 023	1	113, 114, 117, 118, 151, 152
-	111 953 547	Cable sleeve – Blinker cable	1	
-	N 20 091 1	Cable sleeve – Direction indicator cable up to chassis No. 1 – 929 745	1	
-	*111 953 547 A	Cable sleeve – Direction indicator cable from chassis No. 1 – 929 746	1	
-	111 953 549 A	Cover plate – Blinker cables (on steering column tube)	1	
17	111 953 549 B	Cover plate – Direction indicator (on steering ... column tube) from chassis No. 1 – 397 023	1	
18	*111 953 601	Arrow – Direction indicator 111 953 021	2	
19	*111 953 601 A	Arrow – Direction indicator 111 953 021	2	
20	*111 953 601 D	Arrow – Direction indicator 111 953 021 B/D	2	111–118
21	*111 953 601 E	Arrow – Direction indicator 111 953 021 A/C	2	111–118

Key No.	Part No.	Description	Quantity	Type and model
-	151 953 601	Arrow – Direction indicator 151 953 021	2	151, 152
-	151 953 601 A	Arrow – Direction indicator 151 953 021 A	2	151, 152
22	*111 953 607	Cover plate – Direction indicator 111 953 021	2	
23	*111 953 607 A	Cover plate with contact piece – Direction indicator 111 953 021	2	
24	*111 953 607 B	Cover plate – Direction indicator 111 953 021 B/D	2	111-118
25	*111 953 607 C	Cover plate – Direction indicator 111 953 021 A/C	2	111-118
-	151 953 607	Cover plate – Direction indicator 151 953 021/A ..	2	151, 152
26	*111 953 609	Pin – Cover plates for direction indicators 111 953 021 B/D and 151 953 021/A	2	
27	*111 953 611	Spring – Bulb retaining for direction indicator 111 953 021	2	
28	*111 953 611 A	Spring – Bulb retaining for direction indicator 111 953 021 A/C	2	111-118
29	*111 953 615	Socket – Bulb for direction indicator 111 953 021 B/D	2	111-118
30	*111 953 615 A	Socket – Bulb for direction indicator 111 953 021 A/C	2	111-118
-	151 953 615	Socket – Bulb for direction indicator 151 953 021/A	2	151, 152
31	*111 953 619	Screw, fillister head – Direction indicator	2	
32	*111 953 621	Washer – Direction indicators 111 953 021 B/D and 151 953 021/A	2	
33	*111 953 623	Nut, hex. – Direction indicator 111 953,021	4	
34	*111 953 627	Rivet, tubular, 3×12.3 – Direction indicator 111 953 021	2	
35	*111 953 631	Rivet, tubular, 3×15.2 – Direction indicator 111 953 021	2	
36	*111 953 635	Rivet plate – Direction indicator 111 953 021	2	
37	*111 953 639	Screw, countersunk head, 3×8	4	
38	*111 953 651	Rubber plug – Direction indicator stop	2	
39	*111 953 671	Mounting screw – Direction indicator	2	
40	*111 953 673	Securing washer	2	

Key	Type and model
111 955 216 B	Windshield wiper shaft, right, with crank from chassis No. 1 600 440
WINDSHIELD WIPER	
111 955 111	Motor - Windshield wiper up to chassis No. 1 600 439
<i>Order</i> → 111 955 111 A	Motor - Windshield wiper from chassis No. 1 600 440
113 955 111 A	Motor - Windshield wiper up to chassis No. 1 600 439
41 113 955 111 B	Motor - Windshield wiper from chassis No. 1 600 440
42 N 12 126 1	Shake-proof washer J 5.3 DIN 6797
43 N 11 005 2	Nut, hex., M 5 DIN 934, galvanized
114 955 111 A	Motor - Windshield wiper (RHD)
111 955 215 B	Windshield wiper shaft, left, with crank from chassis No. 1 600 440
<i>Order</i> → 111 955 215 A 111 955 215 B	Windshield wiper shaft, left, with crank from chassis No. 1 600 440 <i>CHANGE IN PRODUCTION</i>
113 955 215	Windshield wiper shaft with bearing up to chassis No. 1 600 439
111 955 216	Windshield wiper shaft with bearing up to chassis No. 1 600 439
<i>Order</i> → 111 955 216 A 111 955 216 B	Windshield wiper shaft, right, with crank from chassis No. 1 600 440 <i>change in production</i>
113 955 216	Windshield wiper shaft with bearing up to chassis No. 1 600 439
111 955 241	Circlip up to chassis No. 1 600 439
46 113 955 243 A	Nut, hex., chromium plated
47 N 12 230 2	Spring washer B 10 DIN 137, galvanized
48 111 955 245	Washer
49 111 955 255 A	Washer, chromium plated from chassis No. 1 600 440
113 955 255 A	Washer, chromium plated up to chassis No. 1 600 439
111 955 261	Ferrule - Windshield wiper bearing, inner up to chassis No. 1 600 439
50 111 955 261 A	Ferrule - Windshield wiper bearing, inner from chassis No. 1 600 440

111 955 407	Bracket with windshield wiper arm from chassis No. 2626976	2	111,112,115,116	d wiper
113 955 407 A	Bracket with windshield wiper arm, aluminium color from chassis No. 1 600 440 up to	2	113,114,117,118	
113 955 407 B	Bracket with windshield wiper arm, aluminium color from chassis No.	2	113,114,117,118, 151,152	ie and model
111 955 411 A	Bracket - Windshield wiper arm from chassis No. 1 600 440 up to 2626975	2	111,112,115,116	
113 955 411 A	Bracket - Windshield wiper arm, aluminium color from chassis No. 1 - 575 415 up to	2	113,114,117,118, 151,152	

THESE PARTS CAN BE USED FOR AVDC
AND SWP WIPER MOTORS

53	113 955 275 A	Bearing cover	2	
	113 955 275 B	" " <i>New Cover made of plastic Replaces previous forged or steel</i>	2	
-	111 955 305 A	Connecting rod - Windshield wiper up to chassis No. 1 600 439	1	
54	111 955 305 B	Connecting rod - Windshield wiper from chassis No. 1 600 440	1	
-	111 955 325	Connecting link - Windshield wiper up to chassis No. 1 600 439	1	
55	111 955 325 A	Connecting link - Windshield wiper from chassis No. 1 600 440	1	
56	111 955 339	Retaining spring - Connecting rod	1	
-	111 955 341	Washer - Crank pin up to chassis No. 1 600 439 ..	8	
57	111 955 346 A	Lockwasher - Crank pin	4	
58	111 955 349	Spring washer from chassis No. 1 600 440	4	
-	113 955 407	Bracket with windshield wiper arm, left up to chassis No. 1 600 439	1	113, 114, 117, 118, 151, 152
-	113 955 408	Bracket with windshield wiper arm, right up to chassis No. 1 600 439	1	113, 114, 117, 118, 151, 152
-	111 955 411	Bracket with windshield wiper arm up to chassis No. 1 600 439	2	111, 112, 115, 116
-	111 955 411 A	Bracket with windshield wiper arm from chassis No. 1 600 440	2	111, 112, 115, 116
-	113 955 411	Bracket with windshield wiper arm, chromium plated, up to chassis No. 1 - 575 414	2	113, 114, 117, 118, 151, 152
59	113 955 411 A	Bracket with windshield wiper arm, aluminium color from chassis No. 1 - 575 415	2	113, 114, 117, 118, 151, 152
-	111 955 421	Arm - Windshield wiper, with blade up to chassis No. 1 600 439	2	111, 112, 115, 116
-	111 955 421 A	Arm - Windshield wiper, with blade from chassis No. 1 600 440	2	111, 112, 115, 116
-	113 955 421	Arm - Windshield wiper, left, with blade, chromium plated, up to chassis No. 1 - 575 414	1	113, 114, 117, 118, 151, 152
-	113 955 421 A	Arm - Windshield wiper, left, with blade, aluminium color from chassis No. 1 - 575 415 up to 1 600 439	1	113, 114, 117, 118, 151, 152
111 955 421 A	Arm - Windshield wiper, with blade from chassis No. 1 600 440 up to 2626975	2	111,112,115,116	
113 955 421 B	Arm - Windshield wiper, with blade, aluminium color from chassis No. 1 600 440 up to	2	113,114,117,118, 151,152	

Key No.	Part No.	Description	Quantity	Type and model
60	113 955 421 B	Arm – Windshield wiper, with blade, aluminium color from chassis No. 1 600 440	2	113, 114, 117, 118, 151, 152
-	113 955 422	Arm – Windshield wiper, right, with blade, chromium plated, up to chassis No. 1 – 575 414	1	113, 114, 117, 118, 151, 152
-	113 955 422 A <i>111 955 425</i>	Arm – Windshield wiper, right, with blade, aluminium color from chassis No. 1 – 575 415 up to 1 600 439	1	113, 114, 117, 118, 151, 152
-	113 955 425	Blade – Windshield wiper up to chassis No. 1 600 439	2	113, 114, 117, 118, 151, 152
-	113 955 511 A	Push-pull type switch – Windshield wiper (three-pole) from chassis No. 1 – 397 023 up to 1 600 439	1	
-	N 11 523 1	Washer A 5.3 DIN 125	1	
-	N 10 810 1	Screw, fillister head, AM 5×6 DIN 85	1	
61	113 955 511 B	Push-pull type switch – Windshield wiper from chassis No. 1 600 440	1	
62	111 941 515	Escutcheon for push-pull type switch from chassis No. 1 600 440	1	
-	111 941 541	Knob – Push-pull type switch, black from chassis No. 1 600 440	1	111, 112, 115, 116
63	113 941 541	Knob – Push-pull type switch, ivory from chassis No. 1 600 440	1	113, 114, 117, 118, 151, 152
-	*111 955 541	Knob – Push-pull type switch, black up to chassis No. 1 600 439	1	111, 112, 115, 116
-	*113 955 541	Knob – Push-pull type switch, ivory up to chassis No. 1 600 439	1	113, 114, 117, 118, 151, 152
-	111 955 605	Frame – Windshield wiper up to chassis No. 1 600 439	1	
64	111 955 605 A	Frame – Windshield wiper from chassis No. 1 600 440	1	
65	111 955 641	Spacer	1	
66	N 11 695 2	Washer 6.1 galvanized	1	
67	N 10 216 1	Bolt, hex. head, M 6×18 DIN 933	1	
-	111 955 741	Housing – Windshield wiper motor 111 955 111 ..	1	111, 112, 115, 116
-	*111 955 849	Carbon brush – Windshield wiper motor 111 955 111	2	111, 112, 115, 116
-	*113 955 849	Carbon brush – Windshield wiper motor 113 955 111/A/B and 114 955 111/A	2	113, 114, 117, 118, 151, 152

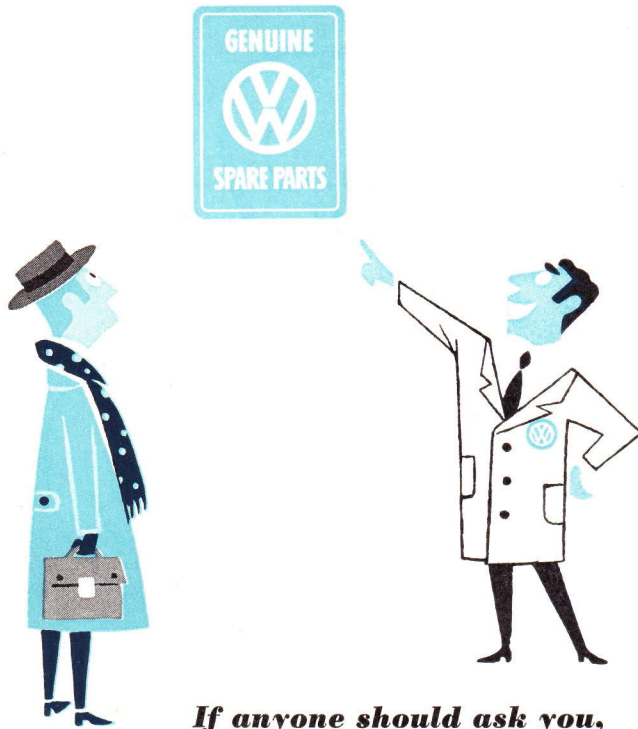

If anyone should ask you,

“How can I recognize Genuine VW Spare Parts?” it isn’t enough for you to say, “Because they’re better”. This is something the VW driver can’t appreciate until the repair job is done and he is pleased with it. The proper way is to explain that the registered VW trade mark is cast, punched, etched or stamped on most Genuine VW Spare Parts, or else they bear a sticker vouching for their authenticity.

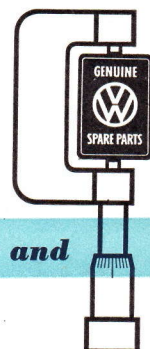

Each part is Factory Engineered and Inspected

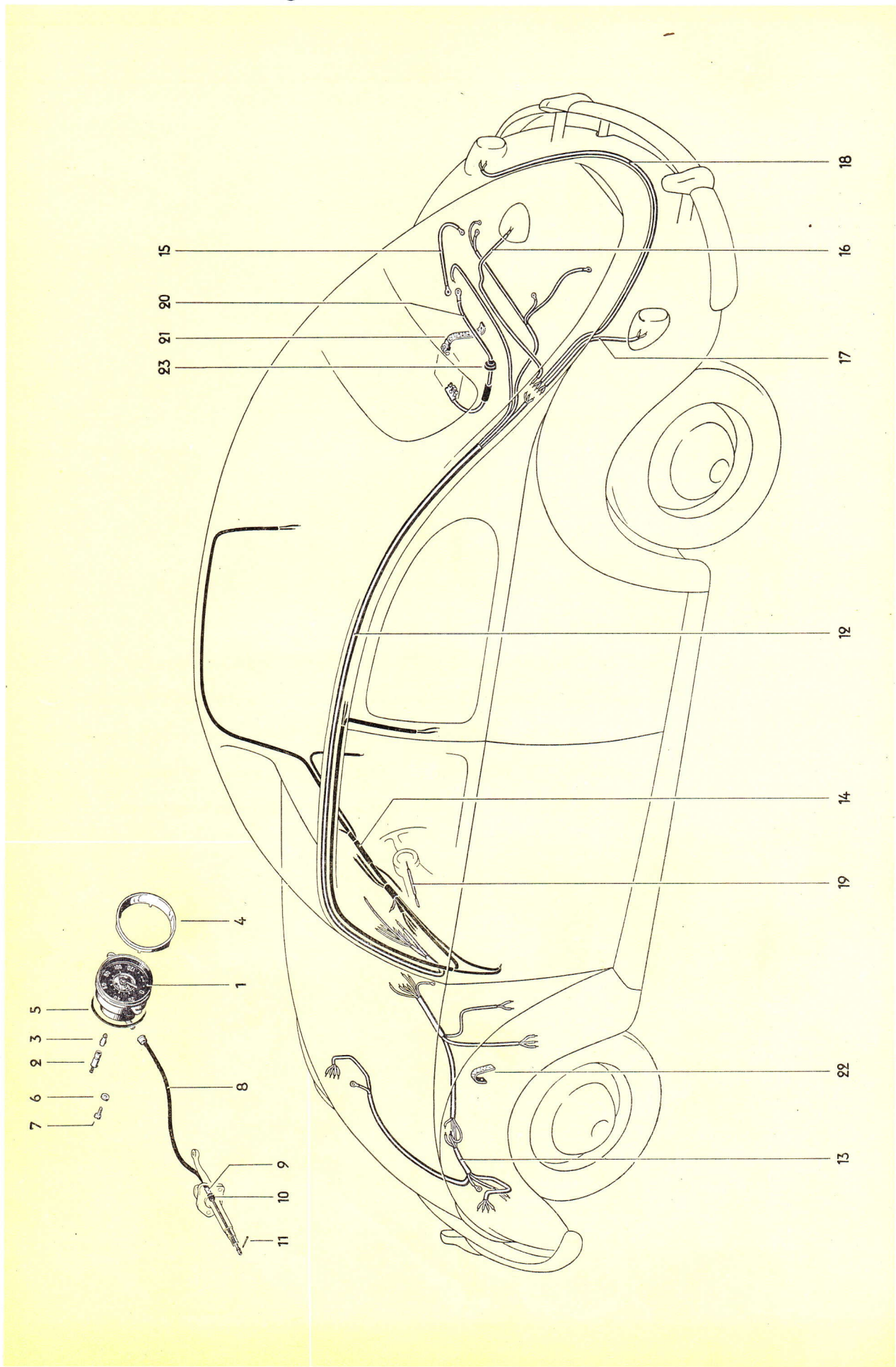

Illustration 41

Key No.	Part No.	Description	Quantity	Type and model
SPEEDOMETER				
1	111 957 021 A 111 957 021 C	Speedometer from chassis No. 1 - 397 023 <i>Change in Production.</i>	1	
-	113 957 021	Speedometer up to chassis No. 1 - 397 022	1	
-	111 957 023 111 957 023 B	Speedometer (miles) from chassis No. 1 - 397 023	1	
-	113 957 023	Speedometer (miles) up to chassis No. 1 - 397 022	1	
-	111 957 031	Speedometer with trip recorder from chassis No. 1 - 397 023	1	
-	111 957 033	Speedometer with trip recorder (miles) from chassis No. 1 - 397 023	1	
2	N 17 601 1	Socket - Bulb	6	
3	N 17 722 1	Bulb 16 V 1.2 W DIN 72 601	6	
-	113 957 371	Ornamental ring - Speedometer from chassis No. 1 - 397 023 up to 1 600 439	1	113, 114, 117, 118, 151, 152
4	113 957 371 A	Ornamental ring - Speedometer from chassis No. 1 600 440	1	113, 114, 117, 118, 151, 152
-	*111 957 375	Gasket - Speedometer up to chassis No. 1 - 397 022	1	111, 112, 115, 116
5	*111 957 375 A	Gasket - Speedometer from chassis No. 1 - 397 023	1	
-	113 957 375	Gasket - Speedometer up to chassis No. 1 - 397 022	1	113, 114, 117, 118, 151, 152
6	N 11 523 1	Washer A 5.3 DIN 125	2	
7	N 10 700 1	Screw, cheese head, AM 5x12 DIN 84, high-polish galvanized	2	
-	111 957 801	Cable, length: 1355 mm. - Speedometer up to chassis No. 1 - 397 022	1	111, 113, 115, 117, 151
8	111 957 801 A	Cable, length: 1275 mm. - Speedometer from chassis No. 1 - 397 023	1	111, 113, 115, 117, 151
-	112 957 801 B	Cable, length: 1585 mm. - Speedometer (RHD) ... up to chassis No. 1 - 397 022 <i>AND FROM</i>	1	112, 114, 116, 118, 152
-	112 957 801 A	Cable, length: 1625 mm. - Speedometer (RHD) ... from chassis No. 1 - 397 023 <i>CHASSIS 1 600 440</i>	1	112, 114, 116, 118, 152
9	*111 957 851	Bush - Speedometer cable	1	
10	*111 957 855	Grommet - Speedometer cable	1	
11	N 12 512 1	Split pin 2x12 DIN 94	1	

112 957 801 B Cable, length: 1585 mm - Speedometer (RHD)
up to chassis No. 1 - 397 022 and
from chassis No. 1 600 440

1 112, 114, 116, 118,
152

Key No.	Part No.	Description	Quantity	Type and model
ELECTRIC WIRING				
-	111 971 011	Main harness - Wiring up to chassis No. 1 - 397 022	1	111, 113, 115, 117
-	111 971 011 A	Main harness - Wiring from chassis No. 1 - 397 023 up to 1 - 575 414	1	111, 113, 115, 117
-	111 971 011 B	Main harness - Wiring from chassis No. 1 - 575 415 up to 1 - 929 745	1	111, 113, 115, 117
-	111 971 011 D	Main harness - Wiring from chassis No. 1 - 929 746 up to 1 600 439	1	111, 113, 115, 117
12	111 971 011-F	Main harness - Wiring from chassis No. 1 600 440	1	111, 113, 115, 117
	<i>111 971 013 B</i>			
-	112 971 011	Main harness - Wiring (RHD) up to chassis No. 1 - 397 022	1	112, 114, 116, 118
-	112 971 011 A	Main harness - Wiring (RHD) from chassis No. 1 - 397 023 up to 1 - 575 414	1	112, 114, 116, 118
-	112 971 011 B	Main harness - Wiring (RHD) from chassis No. 1 - 575 415 up to 1 - 929 745	1	112, 114, 116, 118
-	112 971 011 C	Main harness - Wiring (RHD) from chassis No. 1 - 929 746 up to 1 600 439	1	112, 114, 116, 118
-	112 971 011 D	Main harness - Wiring (RHD) from chassis No. 1 600 440	1	112, 114, 116, 118
-	151 971 011	Main harness - Wiring up to body No. 10 968	1	151
-	151 971 011 A	Main harness - Wiring from body No. 10 969 up to 15 996	1	151
-	151 971 011 B	Main harness - Wiring <i>NOT AVAILABLE</i> from body No. 15 997 up to 24 510	1	151
-	151 971 011 E	Main harness - Wiring from body No. 24 511 up to 39 038	1	151
		Wiring from body No. 39 039	1	151
(1)	112 971 011			
	152 971 011	Wiring (RHD) to 15 996	1	152
	152 971 011 A			
-	152 971 011 A	Main harness - Wiring (RHD) from body No. 15 997 up to 24 510	1	152
-	152 971 011 D	Main harness - Wiring (RHD) <i>NOT AVAILABLE</i> from body No. 24 511 up to 39 038	1	152
-	152 971 011 E	Main harness - Wiring (RHD) from body No. 39 039	1	152
-	111 971 013	Main harness - Wiring (blinker) <i>NOT AVAILABLE</i> from chassis No. 1 - 871 206 up to 1 - 929 745	1	111, 113, 115, 117
-	111 971 013 A	Main harness - Wiring (blinker) from chassis No. 1 - 929 746 up to 1 600 439	1	111, 113, 115, 117



Key No.	Part No.	Description	Quantity	Type and model
-	111 971 013 B	Main harness - Wiring (blinker) from chassis No. 1 600 440	1	111, 113, 115, 117
-	151-971-013	Main harness - Wiring (blinker) <i>NOT AVAILABLE</i> from body No. 22 650 up to 24 510	1	151
-	151 971 013 B	Main harness - Wiring (blinker) from body No. 24 511 up to 39 038	1	151
-	151 971 013 C	Main harness - Wiring (blinker) from body No. 39 039	1	151
-	111 971 031	Harness - Headlamp wiring, up to chassis No. 1 - 575 414	1	
-	111 971 033	Harness - Headlamp wiring (for USA only) up to chassis No. 1 - 575 414	1	111, 113, 115, 117, 151
-	111 971 041	Harness - Foot dipper switch and fuse box wiring, up to chassis No. 1 - 397 022	1	111, 113, 115, 117, 151
-	111 971 041 A	Harness - Foot dipper switch and fuse box wiring, from chassis No. 1 - 397 023 up to 1 - 575 414	1	111, 115
		112 971 041 no longer available		
		112 971 041 A no longer available fuse box wiring	1	112, 116
		114 971 041 no longer available		
		111 971 057 no longer available		
		151 971 057 A no longer available fuse box wiring to 1-575414	1	112, 116
-	144 971 041	Harness - Foot dipper switch and fuse box wiring (RHD) from chassis No. 1-397 023 up to 1-575 414	1	114, 118
-	113 971 043	Harness - Foot dipper switch and fuse box wiring from chassis No. 1 - 397 023 up to 1 - 575 414	1	113, 117, 151
-	111 971 055	Harness - Instrument panel up to chassis No. 1 - 575 414	1	111, 113, 115, 117, 151
-	111 971 055 A	Harness - Instrument panel from chassis No. 1 - 575 415 up to 1 - 929 745	1	111, 115
-	111 971 055 C	Harness - Instrument panel from chassis No. 1 - 929 746 up to 1 600 439	1	111, 115
-	112 971 055	Harness - Instrument panel (RHD) <i>NOT AVAILABLE</i> up to chassis No. 1 - 575 414	1	112, 114, 116, 118
-	112 971 055.C	Harness - Instrument panel (RHD) <i>NOT AVAILABLE</i> from chassis No. 1 - 929 746 up to 1 600 439	1	112, 116
-	113 971 055	Harness - Instrument panel from chassis No. 1 - 575 415 up to 1 - 929 745	1	113, 117
-	113 971 055 B	Harness - Instrument panel from chassis No. 1 - 929 746 up to 1 600 439	1	113, 117
-	114 971 055	Harness - Instrument panel (RHD) <i>NOT AVAILABLE</i> from chassis No. 1 - 575 415 up to 1 - 929 745	1	112, 114, 116, 118
-	114 971 055 B	Harness - Instrument panel (RHD) from chassis No. 1 - 929 746 up to 1 600 439	1	114, 118
-	151 971 055	Harness - Instrument panel <i>NOT AVAILABLE</i> from body No. 15 997 up to 24 510	1	151

Key No.	Part No.	Description	Quantity	Type and model
-	151-971-055-B	Harness - Instrument panel <i>Not Available</i> from body No. 24 511 up to 39 038	1	151
-	152-971-055	Harness - Instrument panel (RHD) <i>NOT AVAILABLE</i> up to body No. 24 510	1	152
-	152 971 055 B	Harness - Instrument panel (RHD) from body No. 24 511 up to 39 038	1	152
-	111-971-057	Harness - Instrument panel (blinker) <i>NOT AVAILABLE</i> from chassis No. 1 - 871 206 up to 1 - 929 745	1	111, 115
-	111 971 057 A	Harness - Instrument panel (blinker) from chassis No. 1 - 929 746	1	111, 115
-	113-971-057	Harness - Instrument panel (blinker) <i>Not Available</i> from chassis No. 1 - 871 206 up to 1 - 929 745	1	113, 117
-	113 971 057 A	Harness - Instrument panel (blinker) from chassis No. 1 - 929 746	1	113, 117
-	151-971-057	Harness - Instrument panel (blinker) <i>Not Available</i> from body No. 22 650 up to 24 510	1	151
-	151-971-057-A	Harness - Instrument panel (blinker) from body No. 24 511 <i>NOT AVAILABLE</i>	1	151
-	111 971 075	Harness - Wiring, front from chassis No. 1 - 575 415 up to 1 - 929 745	1	111, 115
-	111 971 075 C	Harness - Wiring, front from chassis No. 1 - 929 746 up to 1 600 439	1	111, 115
-	111 971 075 D	Harness - Wiring, front from chassis No. 1 600 440	1	111, 115
-	112-971-075	Harness - Wiring, front (RHD) <i>NOT AVAILABLE</i> from chassis No. 1 - 575 415 up to 1 - 929 745	1	112, 116
-	112-971-075-B	Harness - Wiring, front (RHD) <i>NOT AVAILABLE</i> from chassis No. 1 - 929 746 up to 1 600 439	1	112, 116
-	112 971 075 C	Harness - Wiring, front (RHD) from chassis No. 1 600 440	1	112, 116
-	113 971 075	Harness - Wiring, front from chassis No. 1 - 575 415 up to 1 - 929 745	1	113, 117, 151
-	113 971 075 B	Harness - Wiring, front from chassis No. 1 - 929 746 up to 1 600 439	1	113, 117, 151
13	113 971 075 C	Harness - Wiring, front from chassis No. 1 600 440	1	113, 117, 151
-	114-971-075	Harness - Wiring, front (RHD) <i>NOT AVAILABLE</i> from chassis No. 1 - 575 415 up to 1 - 929 745	1	114, 118, 152
-	114 971 075 B	Harness - Wiring, front (RHD) from chassis No. 1 - 929 746 up to 1 600 439	1	114, 118

Key	Part No.	Description	Quantity	Notes
	114 971 077 A	Harness - Wiring, front (Sealed-Beam) from chassis No. 2 528 668	1	M 22, 114, 118 <i>114 971 077 A</i>
-	114 911 075 C	Harness - Wiring, front (RHD) from chassis No. 1 600 440	1	114, 118
-	113 971 077 C	Harness - Wiring, front (for USA only) from chassis No. 1 - 575 415 up to 1 - 929 745	1	111, 113, 115, 117, 151
-	113 971 077 D	Harness - Wiring, front (for USA only) from chassis No. 1 - 929 746 up to 1 600 439	1	111, 113, 115, 117, 151
-	113 971 077 E	Harness - Wiring, front (for USA only) from chassis No. 1 600 440	1	111, 113, 115, 117, 151,
-	111 971 105	Cable - Interior light up to chassis No. 1 - 575 414	1	111, 113, 115, 117
-	112 971 105	Cable - Interior light (RHD) up to chassis No. 1 - 575 414	1	112, 114, 116, 118 <i>NOT AVAILABLE</i>
-	111 971 115	Cable - Direction indicator up to chassis No. 1 - 397 022	1	111, 113, 115, 117
-	111 971 115 A	Cable - Direction indicator from chassis No. 1 - 397 023 up to 1 - 575 414	1	111-118
14	113 971 115	Cable - Direction indicator from chassis No. 1 600 440	1	111, 113, 115, 117
-	114 971 115	Cable - Direction indicator (RHD) from chassis No. 1 600 440	1	112, 114, 116, 118
-	113 971 125	Cable - Door contact switch up to chassis No. 1 - 397 022	1	113, 114, 117, 118, 151, 152
-	113 971 125 A	Cable - Door contact switch from chassis No. 1 - 397 023 up to 1 - 575 414	1	113, 114, 117, 118, 151, 152 <i>NOT AVAILABLE</i>
15	111 971 127	Cable - Generator to starter motor from chassis No. 1 600 440	1	
-	111 971 135	Cable - Steering and ignition lock from chassis No. 1 - 575 415	1	
-	111 971 145	Cable - Licence plate light up to chassis No. 1 - 397 022	1	
16	111 971 145 B	Cable - Licence plate light from chassis No. 1 - 397 023	1	
-	111 971 165	Cable - Tail light, left up to chassis No. 1 - 397 022	1	
17	111 971 165 A	Cable - Tail light, left from chassis No. 1 - 397 023	1	
-	111 971 166	Cable - Tail light, right up to chassis No. 1 - 397 022	1	
18	111 971 166 A	Cable - Tail light, right from chassis No. 1 - 397 023	1	
-	111 971 167	Cable - Tail-blinker-lamps, left from chassis No. 1 - 871 206	1	
	111 971 139	no longer available		

Key No.	Part No.	Description	Quantity	Type and model
-	111 971 168	Cable – Tail-blinker-lamps, right from chassis No. 1 – 871 206	1	
-	N 20 005 1	Ferrule 16.5×4	2	
-	113 971 175	Cable – Stop light switch and fuse box (hydraulic brake) up to chassis No. 1 – 397 022	1	113, 114, 117, 118, 151, 152
-	111 971 177	Cable – Stop light switch and fuse box, front (mechanical brake)	1	111, 112, 115, 116
-	N 20 061 1	Grommet	1	111, 112, 115, 116
-	111 971 185	Cable – Horn up to chassis No. 1 – 397 022	1	
-	111 971 185 A	Cable – Horn from chassis No. 1 – 397 023 up to 1 – 575 414	1	
19	111 971 189	Cable – Horn button	1	
20	111 971 225	Cable – Starter	1	
-	111 971 227	Cable – Starter (for second battery)	1	
-	111 971 235	Strap – Battery earthing up to chassis No. 1 – 929 745	1	
21	111 971 235 A	Strap – Battery earthing from chassis No. 1 – 929 746	1	
-	111 971 237	Earthing strap – Transmission to chassis from chassis No. 1 – 397 023	1	
-	111 971 237 A	Earthing strap – Transmission to chassis up to chassis No. 1 – 397 022	1	
22	111 971 246	Earth strap – Steering coupling	1	
23	111 971 905	Grommet – Starter cable	1	
-	N 17 501 1	Cable 0.5 mm ² cross section	*	
-	N 17 510 1	Cable 0.75 mm ² cross section	*	
-	N 17 520 1	Cable 1.0 mm ² cross section	*	
-	N 17 530 1	Cable 1.5 mm ² cross section	*	
-	N 17 535 1	Cable 2.5 mm ² cross section	*	