

MAIN GROUP 3

TRANSMISSION

		Illustration
00	Transmission	-
01	Transmission case	20
11	Gears, shafts	21
21	Transmission case (Automatic)	22
23	Forward, direct, reverse gear clutch, torque converter (Automatic)	A22
25	Valve body, oil strainer (Automatic)	B22
98	Repair kits	-

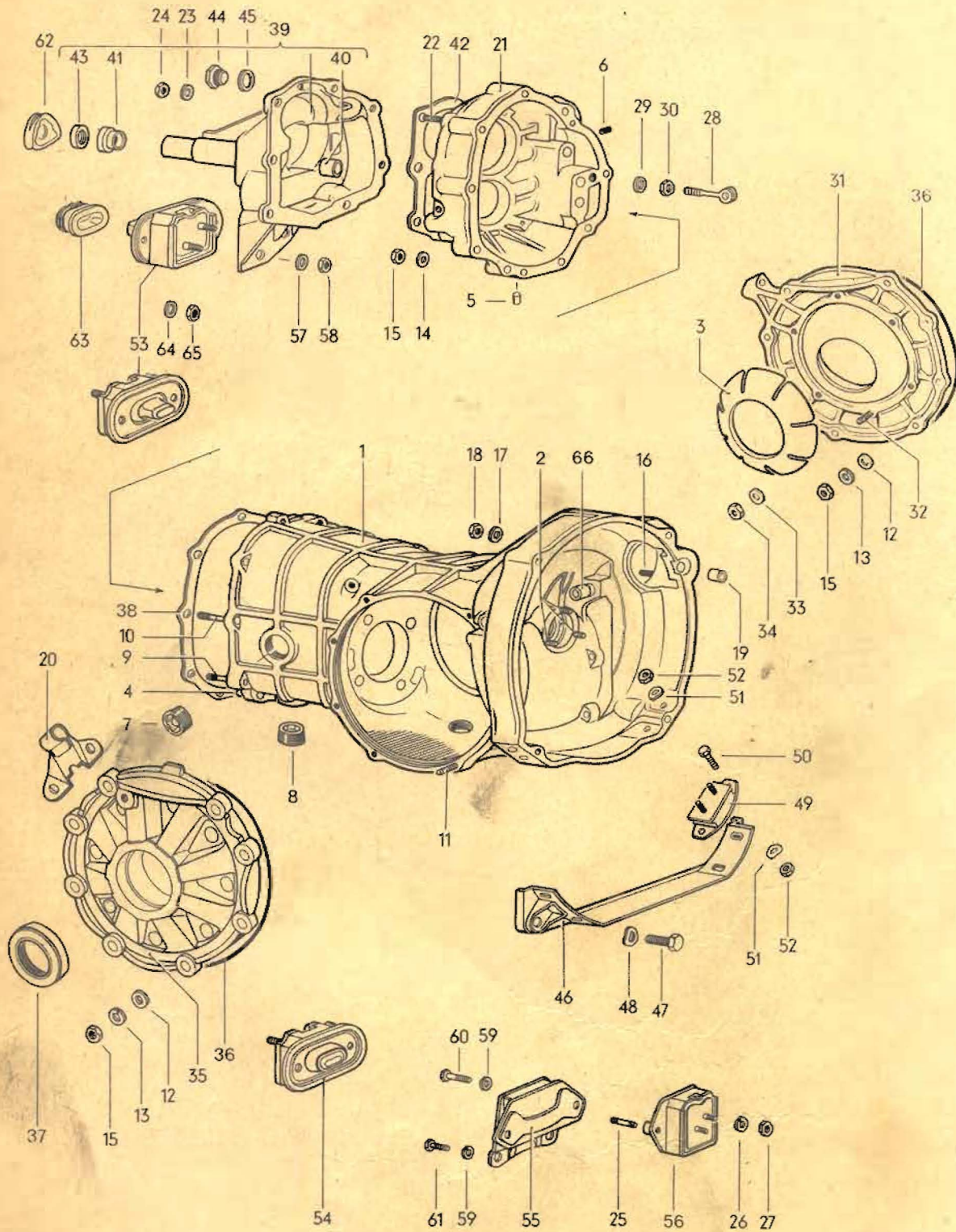

MAIN GROUP 3

TRANSMISSION

Key	Part No.	Description	Qty.	Type and model
TRANSMISSION				
-	003 300 035	Transmission, complete - Automatic	1	M 249
-	003 300 035 A	*Transmission, complete - Automatic to Ch. No. 312 2006 452	1	M 249/M 236
-	003 300 035 H	*Transmission, complete - Automatic from Ch. No. 312 2006 453	1	M 249/M 236
-	311 300 043 P	Transmission, complete from Ch. No. 319 000 001 to 312 2006 452 use: 311 141 025 D from Ch. No. 319 000 001 to 310 2500 000	1	
-	311 300 043 R	Transmission, complete from Ch. No. 317 000 001 to 318 500 000 from Ch. No. 369 000 001 to 312 2006 452 use: 311 141 025 D from Ch. No. 317 000 001 to 310 2500 000	1	M 263
-	361 300 043	Transmission, complete from Ch. No. 312 2006 453	1	M 263
-	113 300 044 B	Transmission, complete from Ch. No. 312 2006 453	1	
TRANSMISSION CASE				
(1)	111 301 051 B	Transmission case from Ch. No. 317 000 001 to 312 2006 452	1	
1	111 301 051 D	Transmission case from Ch. No. 312 2006 453	1	
2	N 14 448 1	Stud AM 7 x 22 from Ch. No. 311 2000 001	3	
(1)	113 301 051 M	Transmission case for flywheel with 109 teeth to Ch. No. 316 500 000 use: to Ch. No. 316 500 000 002 311 219 A/223/001 311 125/127 A/391/ 392/393/394/395/396/397/398 additionally to Ch. No. 315 158 979 113 301 179 C/180 C/185 A	1	
3	113 301 111	Plastic packing between final drive cover and rear axle tube to Ch. No. 318 500 000 from Ch. No. 369 000 001	2	M 263
4	113 301 113	Dowel pin - Gear carrier	2	
5	111 301 115	Retaining plug	1	
6	113 311 599	Retaining plug - Detent ball	3	

(7)	113 301 123	Oil filler plug M 24 x 1.5	1	M 220
7	111 301 127 B	Oil filler plug M 24 x 1.5	1	
(7)	111 301 129 B	Oil filler plug M 24.5 x 1.5 (oversize)	X	
8	113 301 141	Oil drain plug M 24 x 1.5 (magnetic)	1	
(8)	111 301 143	Oil drain plug M 24.5 x 1.5 for magnetic (oversize)	X	
9	N 14 428 3	Stud AM 8 A x 48 for gear carrier	4	
(9)	N 14 484 3	Stud CM 10 A/M 8 x 48 for gear carrier	X	
10	N 14 407 1	Stud AM 8 A x 62 for gear carrier	5	
(10)	N 14 408 2	Stud CM 10 A/M 8 x 62 for gear carrier	X	
11	N 14 395 9	Stud AM 8 A x 42 for final drive cover	16	
(11)	N 14 560 1	Stud CM 10 A/M 8 x 42 for final drive cover	X X	
12	113 301 193	Washer 8.2 x 18	16	
13	N 12 038 1	Lock washer 8	16	
14	N 12 241 2	Spring washer B 8 x 15	9	
15	N 11 008 8	Nut, hex. M 8	25	
16	N 14 459 1	Stud BM 10 A x 45 - Starting motor	1	
(16)	N 14 480 1	Stud CM 12 x 1.5 A/M 10 x 42 for starting motor	X	
17	N 12 230 2	Spring washer B 10	1	
18	N 11 010 4	Nut, hex. M 10	1	
(19)	111 301 155	Bush - Starting motor shaft to Ch. No. 316 500 000	1	
19	113 301 155	Bush - Starting motor shaft from Ch. No. 317 000 001	1	
(20)	113 301 165	Guide plate - Clutch cable to Ch. No. 312 2006 452	1	
20	113 301 165 A	Guide plate - Clutch cable from Ch. No. 312 2006 453	1	
21	113 301 169	Gear carrier	1	
22	N 14 449 1	Stud AM 7 A x 32 for gearshift housing	7	
(22)	N 14 492 1	Stud CM 10 A/M 7 x 32 for gearshift housing	X	
23	N 12 234 1	Spring washer B 7	7	
24	N 11 007 1	Nut, hex. M 7	7	
25	311 301 175	Stud for bonded rubber mounting, front from Ch. No. 318 000 001	2	
26	N 12 011 2	Lock washer A 10	2	
27	N 11 010 4	Nut, hex. M 10	2	

28	113 301 177	Support – Reverse lever	1	
29	N 12 242 1	Spring washer B 10 x 18	1	
30	N 11 134 2	Nut, hex. M 10	1	
21	113 301 179 C	Final drive cover, left from Ch. No. 315 158 980 bis 318 500 000	1 1	
(31)	113 301 179 D	Final drive cover, left to Ch. No. 315 158 979	1	M 263;M 220 / M 263
(31)	113 301 180 C	Final drive cover, right from Ch. No. 315 158 980 to 318 500 000	1 1	
(31)	113 301 180 D	Final drive cover, right to Ch. No. 315 158 979	1	M 263;M 220 / M 263
32	N 14 398 3	Stud AM 8 A x 27 for axle tube retainer to Ch. No. 318 500 000	12 12	
(32)	N 14 482 1	Stud CM 10 A/M 8 x 27 for axle tube retainer to Ch. No. 318 500 000	12 X	M 263
		from Ch. No. 369 000 001	X	M 263
33	N 12 241 2	Spring washer B 8 x 15 to Ch. No. 318 500 000	12 12	
		from Ch. No. 369 000 001	12	M 263
34	N 11 008 8	Nut, hex. M 8 to Ch. No. 318 500 000	12 12	
		from Ch. No. 369 000 001	12	M 263
35	113 301 183 F	Final drive cover from Ch. No. 319 000 001	2	
(36)	113 301 185	Gasket – Final drive cover to Ch. No. 315 158 979	2	
36	113 301 185 A	Gasket – Final drive cover from Ch. No. 315 158 980	2	
37	113 301 189 A	Seal – Joint flange from Ch. No. 319 000 001	2	
38	113 301 191	Gasket – Gear carrier	1	
(39)	113 301 205 G	Gearshift housing to Ch. No. 312 2006 452 use 001 301 207/209/227 to Ch. No. 319 072 008	1	
39	311 301 205 A	Gearshift housing from Ch. No. 312 2006 453	1	
(40)	111 301 207	Bush – Gearshift housing to Ch. No. 319 072 008	2	
41)				
40	001 301 207	Bush, rear – Gearshift housing from Ch. No. 319 072 009	1	

41	001 301 209	Bush, front – Gearshift housing from Ch. No. 319 072 009	1	
42	211 301 215	Gasket – Gearshift housing	1	
(43)	131 301 225 A	Sealing ring – Transmission shift lower, inner to Ch. No. 319 072 008	1	
43	001 301 227	Seal – Transmission shift lever, inner from Ch. No. 319 072 009		
44	113 301 229 A	Plug M 18 x 1.5 for gearshift housing to Ch. No. 312 2006 452	1	
		from Ch. No. 312 2006 453	2	
45	N 13 816 1	Gasket C 18 x 24 to Ch. No. 312 2006 452	1	
		from Ch. No. 312 2006 453	2	
46	111 301 255 A	Transmission carrier to Ch. No. 318 500 000	1	
		from Ch. No. 369 000 001	1	M 263
47	111 301 257	Bolt – Transmission carrier to Ch. No. 318 500 000	2	
		from Ch. No. 369 000 001	2	M 263
48	N 12 240 1	Spring washer B 20	2	
(49)	111 301 263 B	Bonded rubber mounting, rear to Ch. No. 315 021 109	2	
		from Ch. No. 315 021 110 to 318 500 000	2	M 105
		from Ch. No. 369 000 001	2	M 105/M 263
49	113 301 263	Bonded rubber mounting, rear from Ch. No. 315 021 110 to 318 500 000	2	
		from Ch. No. 369 000 001	2	M 263
50	N 10 238 7	Bolt, hex. head M 8 x 15	4	
51	N 12 241 2	Spring washer B 8 x 15	8	
52	N 11 008 8	Nut, hex. M 8	8	
(53)	311 301 265	Bonded rubber mounting, front to Ch. No. 315 021 109	1	
		from Ch. No. 315 021 110 to 315 220 883	1	M 105
53	311 301 265 A	Bonded rubber mounting, front from Ch. No. 315 021 110 to 315 220 883	1	
54	311 301 265 B	Bonded rubber mounting, front from Ch. No. 316 000 001 to 317 500 000	1	
(54)	311 301 265 C	Bonded rubber mounting, front from Ch. No. 316 000 001 to 317 500 000	1	M 105
55	311 301 265 D	Bonded rubber mounting, front from Ch. No. 318 015 226	1	M 249 <i>Aut</i>
56	311 301 265 E	Bonded rubber mounting, front from Ch. No. 318 000 001	1	
(56)	311 301 265 G	Bonded rubber mounting, front from Ch. No. 318 000 001	1	M 105
57	N 12 242 1	Spring washer B 10 x 18	2	
58	N 11 134 2	Nut, hex. M 10	2	

57	N 12 011 1	Lock washer A 10	2
58	N 11 010 4	Nut, hex. M 10 x 1.5	2
59	N 10 460 1	Bolt, hex. hd. M 10 x 60	2
60	N 10 440 1	Bolt, hex. hd. M 10 x 40	2
61	111 301 289 B	Gasket between gearshift housing and frame	1
62	311 301 343	Rubber bush - Bonded rubber mounting, front to Ch. No. 315 220 883	1
63	N 12 230 2	Spring washer B 10	2
64	N 11 010 4	Nut, hex. M 10	2
65	113 141 711	Bush, right - Operating shaft	1

59	N 12 011 2	Lock washer A 10	4	M 249
60	N 10 460 1	Bolt, hex. hd. M 10 x 60	2	M 249
61	N 10 440 1	Bolt, hex. hd. M 10 x 40	2	M 249
62	111 301 289 B	Gasket between gearshift housing and frame	1	
63	311 301 343	Rubber bush - Bonded rubber mounting, front to Ch. No. 315 220 883	1	
64	N 12 230 2	Spring washer B 10	2	
65	N 11 010 4	Nut, hex. M 10	2	
66	113 141 711	Bush, right - Operating shaft	1	

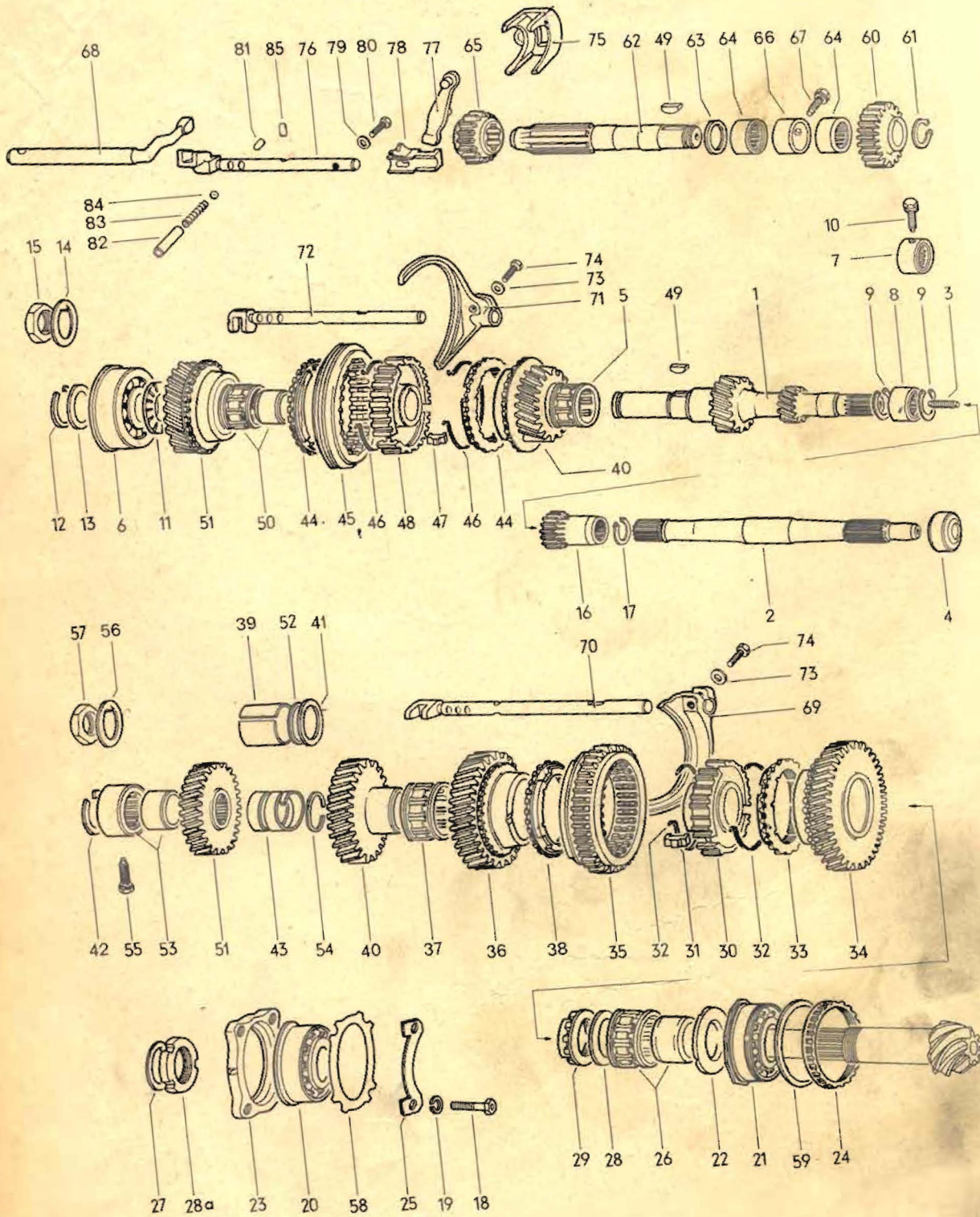

Key Part No. Description Qty. Type and model

GEARS . SHAFTS

1	113 311 101 C	Main drive shaft , front use: to Ch. No. 317 244 940 113 311 187/123 A/191 to Ch. No. 311 2146 905 113 311 161 A	1	
2	113 311 105 A	Main drive shaft, rear	1	
3	113 311 109	Stud – Main drive shaft connection	1	
(4)	111 307 113 C	Oil seal – Main drive shaft to Ch. No. 310 2500 000	1	
4	113 311 113 A	Oil seal – Main drive shaft from Ch. No. 311 2000 001	1	
5	113 311 115 B	Needle bearing (3rd gear) for main drive shaft	1	
6	113 311 123 A	Ball bearing for main drive shaft 19 mm wide	1	
7	113 311 125	Needle bearing – Main drive shaft to Ch. No. 319 500 000	1	
8	001 311 125	Needle bearing – Main drive shaft from Ch. No. 310 2000 001	1	
9	001 311 127 A	Lock ring – Needle bearing from Ch. No. 310 2000 001.	2	
10	113 311 141	Lock bolt for needle bearing on main drive shaft to Ch. No. 319 500 000	1	
11	113 311 151 C	Thrust washer for 4th gear on main drive shaft	1	
12	113 311 187	Lockring – Main drive shaft, front from Ch. No. 317 244 941	1	
-	113 311 189	Spacer for ball bearing (only when 113 311 101 B is used with the 17 mm wide main drive shaft ball bearing)	1	
13	113 311 191	Concave washer – Main drive shaft, front from Ch. No. 317 244 941	1	
14	113 309 381 A	Lock plate – Main drive shaft to Ch. No. 317 244 940	1	
15	113 309 385	Nut, hex. M 22 x 1.5 – Main drive shaft to Ch. No. 317 244 940	1	
(16)	002 311 161	Reverse gear on main drive shaft to Ch. No. 311 2146 905 use: 002 311 507 to Ch. No. 318 057 487	1	

16	113 311 161 A	Reverse gear on main drive shaft from Ch. No. 311 2146 906	1
17	N 12 419 1	Lockring 19 x 1.2 for reverse gear	1
18	113 311 215	Bolt, hex. hd. M 10 x 35 – Retainer to Ch. No. 319 500 000	4
19	N 12 242 1	Spring washer B 10 x 18 from Ch. No. 318 064 185 to 319 500 000	4
20	113 311 219 A	Double taper roller bearing for drive pinion to Ch. No. 319 500 000	1
(21)	002 311 219 A	Double taper roller bearing for drive pinion from Ch. No. 310 2000 001 to 312 2006 452	1
21	113 311 219 B	Double taper roller bearing for drive pinion from Ch. No. 312 2006 453	1
22	113 311 221 A	Thrust washer between 1st gear and double taper roller bearing	1
23	113 311 223 B	Retainer for double taper roller bearing to Ch. No. 319 500 000	1
(24)	002 311 223	Tensioning nut – Bearing from Ch. No. 310 2000 001 to 312 2006 452	1
24	002 311 223 A	Tensioning nut – Bearing from Ch. No. 312 2006 453	1
25	113 311 225	Lock plate – Retainer to Ch. No. 318 064 184	2
26	113 311 227 B	Needle bearing (1st gear) for drive pinion	1
27	113 311 229	Thrust washer between needle bearing and round nut to Ch. No. 317 500 000	1
(28)	113 311 230	Shim 0.45 mm for clutch gear (1st speed) from Ch. No. 316 035 546	X
(28)	113 311 231	Shim 0.1 mm for clutch gear (1st speed) to Ch. No. 316 035 545	X
(28)	113 311 231 A	Shim 0.5 mm for clutch gear (1st speed) from Ch. No. 316 035 546	X
(28)	113 311 232	Shim 0.15 mm for clutch gear (1st speed) to Ch. No. 316 035 545	X
(28)	113 311 232 A	Shim 0.55 mm for clutch gear (1st speed) from Ch. No. 316 035 546 to 317 500 000	X

28	113 311 232 B	Shim 0.55 mm for clutch gear (1st speed) from Ch. No. 318 000 001	X
(28)	113 311 233	Shim 0.2 mm for clutch gear (1st speed) to Ch. No. 316 035 545	X
(28)	113 311 233 A	Shim 0.6 mm for clutch gear (1st speed) from Ch. No. 316 035 546 to 317 500 000	X
(28)	113 311 233 B	Shim 0.6 mm for clutch gear (1st speed) from Ch. No. 318 000 001	X
(28)	113 311 234	Shim 0.25 mm for clutch gear (1st speed) to Ch. No. 316 035 545	X
(28)	113 311 234 A	Shim 0.65 mm for clutch gear (1st speed) from Ch. No. 316 035 546 to 317 500 000	X
(28)	113 311 234 B	Shim 0.65 mm for clutch gear (1st speed) from Ch. No. 318 000 001	X
(28)	113 311 235	Shim 0.3 mm for clutch gear (1st speed) to Ch. No. 316 035 545	X
(28)	113 311 235 A	Shim 0.7 mm for clutch gear (1st speed) from Ch. No. 316 035 546 to 317 500 000	X
(28)	113 311 235 B	Shim 0.7 mm for clutch gear (1st speed) from Ch. No. 318 000 001	X
(28)	113 311 236	Shim 0.4 mm for clutch gear (1st speed) to Ch. No. 316 035 545	X
(28)	113 311 236 A	Shim 0.8 mm for clutch gear (1st speed) from Ch. No. 316 035 546 to 317 500 000	X
(28)	113 311 236 B	Shim 0.8 mm for clutch gear (1st speed) from Ch. No. 318 000 001	X
(28)	113 311 238	Shim 0.75 mm for clutch gear (1st speed) from Ch. No. 316 035 546 to 317 500 000	X
(28)	113 311 238 A	Shim 0.75 mm for clutch gear (1st speed) from Ch. No. 318 000 001	X
(28)	113 311 239	Shim 0.85 mm for clutch gear (1st speed) from Ch. No. 316 035 546 to 317 500 000	X

(28)	113 311 239 A	Shim 0.85 mm for clutch gear (1st speed) from Ch. No. 318 000 001	X
28a	113 311 237	Round nut for drive pinion to Ch. No. 317 500 000	1
29	113 311 237 A	Round nut for drive pinion from Ch. No. 318 000 001	1
(30)	113 311 243	Clutch gear – 1st and 2nd speeds to Ch. No. 316 035 545	1
30	113 311 243 B	Clutch gear – 1st and 2nd speeds from Ch. No. 316 035 546 use: to Ch. No. 317 500 000 113 311 232 B/233 B/234 B/ 235 B/236 B/237 A/238 A/239 A	1
(31)	113 309 313	Shifting plate – 1st and 2nd gears to Ch. No. 316 035 545	3
31	113 311 245	Shifting plate – 1st and 2nd gears from Ch. No. 316 035 546	3
(32)	113 309 311	Snap spring – Shifting plate to Ch. No. 316 035 545	2
32	004 311 311	Snap spring – Shifting plate from Ch. No. 316 035 546	2
(33)	113 311 247	Synchronizer stop ring – 1st speed (3 mm shoulder) to Ch. No. 5827	1
(33)	113 311 247 A	Synchronizer stop ring – 1st speed (5 mm shoulder) from Ch. No. 5828 to 316 035 545	1
33	113 311 247 C	Synchronizer stop ring – 1st speed from Ch. No. 316 035 546	1
(34)	113 311 251 A	Gear (1st speed) on drive pinion to Ch. No. 316 035 545	1
34	113 311 251 C	Gear (1st speed) on drive pinion from Ch. No. 316 035 546	1
35	113 311 255 B	Operating sleeve – 1st and 2nd speeds (see Parts Service Bulletin 3/5) use: 113 311 531 B to Ch. No. 317 099 355 to Ch. No. 311 2116 285 113 311 269 B	1
(36)	113 311 261	Gear (2nd speed) on drive pinion to Ch. No. 316 035 545	1
36	113 311 261 A	Gear (2nd speed) on drive pinion from Ch. No. 316 035 546	1

37	113 311 265 B	Needle bearing (2nd gear) for drive pinion	1
38	113 311 269 B	Synchronizer stop ring – 2nd speed from Ch. No. 5828 use: from Ch. No. 5 828 to 311 2116 285 113 311 255 B	1
39	113 311 271 A	Spacer sleeve 35.9 mm for drive pinion to Ch. No. 318 064 185	1
40	113 311 275 C	Gear train (3rd speed)	1
41	113 311 281	Concave washer between 3rd and 4th gears on drive pinion to Ch. No. 318 064 185	1
42	113 311 287	Lockring (4th gear) on drive pinion from Ch. No. 318 064 186	1
43	113 311 289	Spacer spring (3rd gear) from Ch. No. 318 064 186	1
(44)	113 311 295	Synchronizer stop ring – 2nd, 3rd and 4th gears (3 mm shoulder) to Ch. No. 5 827	3
44	113 311 295 D	Synchronizer stop ring – 3rd and 4th gears (see Parts Service Bulletin 3/5) use: from Ch. No. 5 828 to 316 035 545 113 311 315 A	2
45	113 311 309	Clutch gear – 3rd and 4th gears	1
46	113 309 311	Snap ring – Shifting plate	2
47	113 309 313	Shifting plate – 3rd and 4th gears	3
48	113 311 315 A	Operating sleeve – 3rd and 4th gears (see Parts Service Bulletin 3/5) use: to Ch. No. 311 2116 285 2 x 113 311 295 D	1
49	113 311 321	Woodruff key 5 x 7.5	X
(49)	113 311 323	Woodruff key 5.03 x 7.5	X
50	113 311 325 B	Needle bearing (4th gear) on main drive shaft	1
(51)	113 311 341	Gear train (4th gear) to Ch. No. 318 064 185	1
51	113 311 341 B	Gear train (4th gear) from Ch. No. 318 064 186	1
52	113 311 361	Shim 0.15 mm for concave washer to Ch. No. 318 064 185	X
(52)	113 311 362	Shim 0.2 mm for concave washer to Ch. No. 318 064 185	X

(52)	113 311 363	Shim 0.25 mm for concave washer to Ch. No. 318 064 185	X
(52)	113 311 364	Shim 0.3 mm for concave washer to Ch. No. 318 064 185	X
(52)	113 311 365	Shim 9.4 mm for concave washer to Ch. No. 318 064 185	X
(52)	113 311 366	Shim 0.6 mm for concave washer to Ch. No. 318 064 185	X
(52)	113 311 367	Shim 0.8 mm for concave washer to Ch. No. 318 064 185	X
(52)	113 311 368	Shim 1 mm for concave washer to Ch. No. 318 064 185	X
(52)	113 311 369	Shim 1.2 mm for concave washer to Ch. No. 318 064 185	X
(53)	113 311 375	Needle bearing – Drive pinion to Ch. No. 318 064 185	1
53	113 311 375 A	Needle bearing – Drive pinion from Ch. No. 318 064 186	1
54	113 311 381	Lockring 1.45 mm – 3rd gear from Ch. No. 318 064 186	X
(54)	113 311 382	Lockring 1.6 mm – 3rd gear from Ch. No. 318 064 186	X
(54)	113 311 383	Lockring 1.75 mm – 3rd gear from Ch. No. 318 064 186	X
(54)	113 311 384	Lockring 1.9 mm – 3rd gear from Ch. No. 318 064 186	X
(54)	113 311 385	Lockring 2.05 mm – 3rd gear from Ch. No. 318 064 186	X
(54)	113 311 386	Lockring 2.2 mm – 3rd gear from Ch. No. 318 064 186	X
55	113 311 141	Lock bolt for needle bearing on drive pinion	1
56	113 309 381 A	Lock plate – Drive pinion to Ch. No. 318 064 185	1
57	113 309 385	Nut, hex. M 22 x 1.5 – Drive pinion to Ch. No. 318 064 185	1
58	113 311 391	Shim 0.15 mm – Drive pinion to Ch. No. 319 500 000	X
59	001 311 391	Shim 0.15 mm – Drive pinion from Ch. No. 310 2000 001	X

(58)	113 311 392	Shim 0.2 mm – Drive pinion to Ch. No. 319 500 000	X
(59)	001 311 392	Shim 0.2 mm – Drive pinion from Ch. No. 310 2000 001	X
(58)	113 311 393	Shim 0.3 mm – Drive pinion to Ch. No. 319 500 000	X
(59)	001 311 393	Shim 0.3 mm – Drive pinion from Ch. No. 310 2000 001	X
(58)	113 311 394	Shim 0.4 mm – Drive pinion to Ch. No. 319 500 000	X
(59)	001 311 394	Shim 0.4 mm – Drive pinion from Ch. No. 310 2000 001	X
(58)	113 311 395	Shim 0.5 mm – Drive pinion to Ch. No. 319 500 000	X
(59)	001 311 395	Shim 0.5 mm – Drive pinion from Ch. No. 310 2000 001	X
(58)	113 311 396	Shim 0.6 mm – Drive pinion to Ch. No. 319 500 000	X
(59)	001 311 396	Shim 0.6 mm – Drive pinion from Ch. No. 310 2000 001	X
(58)	113 311 397	Shim 0.7 mm – Drive pinion to Ch. No. 319 500 000	X
(59)	001 311 397	Shim 0.7 mm – Drive pinion from Ch. No. 310 2000 001	X
(58)	113 311 398	Shim 0.8 mm – Drive pinion to Ch. No. 319 500 000	X
(59)	001 311 398	Shim 0.8 mm – Drive pinion from Ch. No. 310 2000 001	X
(59)	001 311 399	Shim 0.9 mm – Drive pinion from Ch. No. 310 2000 001	X
(58)	113 311 400	Shim 1 mm – Drive pinion to Ch. No. 319 500 000	X
(58)	113 311 401	Shim 1.2 mm – Drive pinion to Ch. No. 319 500 000	X
60	002 311 507	Reverse drive gear use to Ch. No. 318 057 488 002 311 161	1
61	N 12 419 1	Lockring 19 x 1.2	1
62	211 311 515	Reverse gear shaft	1
63	113 311 517	Thrust washer – Reverse gear shaft	1
64	113 311 523	Needle bearing – Reverse gear shaft	2
(64)	113 311 523 B	Needle bearing – Reverse gear shaft (oversize)	X
65	113 311 531 B	Reverse sliding gear use: to Ch. No. 317 099 355 113 311 255 B	1

66	113 311 537	Spacer sleeve – Reverse gear shaft	1
67	113 311 141	Lock bolt	
		Spacer sleeve	1
(68)	113 311 541 A	Transmission shift lever to Ch. No. 433 785	1
68	311 311 541	Transmission shift lever from Ch. No. 433 786	1
69	113 311 551 C	Selector fork (1st and 2nd gear)	1
70	113 311 557 B	Selector shaft (1st and 2nd gear) (shorten by 55 mm) to Ch. No. 315 220 883 use: to Ch. No. 317 099 355 113 311 255 B/531 B	1
71	113 311 561	Selector fork (3rd and 4th gear)	1
72	113 311 567	Selector shaft (3rd and 4th gear)	1
73	N 12 241 2	Spring washer B 8 x 15	2
74	113 309 595	Bolt, hex. hd. M 8 x 25 – Selector fork	2
75	113 311 571	Selector fork – Reverse gear	1
76	113 311 577	Selector shaft – Reverse gear	1
77	113 311 581 A	Reverse lever – Reverse gear	1
78	113 311 585	Guide – Reverse lever	1
79	N 12 234 1	Spring washer B 7	1
80	N 10 277 1	Bolt, hex. hd. M 7 x 22	1
81	113 311 599	Retaining plug – Detent ball	3
82	111 307 621	Sleeve – Detent ball	3
83	111 307 625	Spring – Detent ball	3
84	N 25 667 2	Detent ball – Selector shaft	3
85	111 307 629	Plunger – Gear lock	2

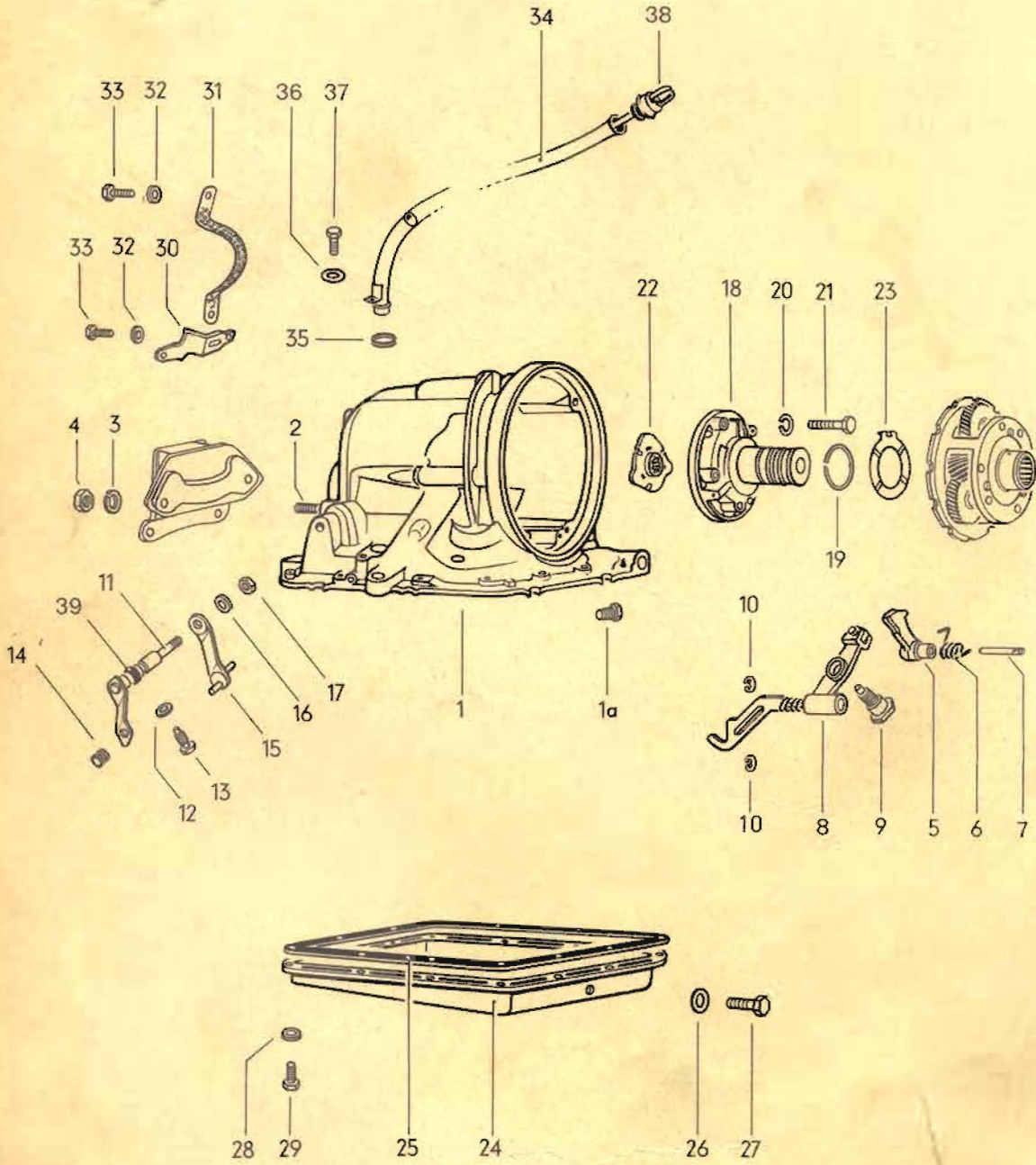

MAIN GROUP 3

TRANSMISSION

Key	Part No.	Description	Qty.	Type and model
TRANSMISSION CASE				
from Ch. No. 318 015 226				M 249
1	003 321 101 C	Transmission case use: to Ch. No. 318 171 040 003 323 511 A additionally to Ch. No. 310 2119 999 003 321 121 E/003 323 443 C/529 B	1	
1 a	003 507 133 A	Plug M 10 x 1 for measuring connection	4	
2	N 14 523 2	Stud AM 10 x 38 for bonded rubber mounting	2	
3	N 12 011 2	Lock washer A 10	2	
4	N 11 010 4	Nut, hex. M 10 x 1.5	2	
5	003 321 119	Lever - Parking lock	1	
(6)	003 321 121	Return spring - Parking lock to Ch. No. 310 2119 999	1	
6	003 321 121 E	Return spring - Parking lock from Ch. No. 310 2120 000	1	
7	003 321 123	Pin - Parking lock	1	
8	003 321 135	Engaging lever - Parking lock	1	
9	003 321 165	Pin - Engaging lever	1	
10	N 12 436 2	Lock washer 6	2	
11	003 321 173	Lever - Parking lock cable	1	
12	N 12 226 2	Spring washer B 6	1	
13	N 10 224 1	Bolt, hex. hd. M 6 x 13.5	1	
14	003 321 177	Bush - Cable lever	1	
15	003 321 185	Lever - Manual valve	1	
16	N 11 525 2	Washer 8.4	1	
17	113 415 431 A	Nut, hex. M 8 self-locking	1	
18	003 321 241	Oil pump	1	
19	003 321 261	Piston ring - Oil pump	4	
20	N 12 006 2	Lock washer B 6	5	
21	N 10 221 2	Bolt, hex. hd. M 6 x 35	5	
22	003 321 273	Carrier - Oil pump	1	
23	003 321 285	Thrust washer 61 mm dia. - Oil pump body	1	
24	003 321 359 A	Oil sump	1	
25	003 321 371	Gasket - Oil sump	1	
26	N 13 840 1	Sealing ring D 10 x 16	1	
27	N 10 110 1	Bolt, hex. hd. M 10 x 10	1	
28	N 12 038 1	Lock washer 8	13	
29	N 10 239 0	Bolt, hex. hd. M 8 x 8	13	
30	003 321 391	Bracket - Cable	1	
31	111 971 237 A	Ground strap	1	
32	N 12 228 2	Spring washer B 8	2	
33	N 10 241 3	Bolt, hex. hd. M 8 x 22	2	

34	003 321 405	Oil filler pipe	1
35	003 321 419	Seal 24.5 mm dia. - Oil filler pipe	1
36	N 12 226 2	Spring washer B 6	2
37	N 10 212 3	Bolt, hex. hd. M 6 x 22	2
38	003 321 431	Oil level dipstick	1
39	003 398 007	1 set of gaskets for transmission - Automatic	1

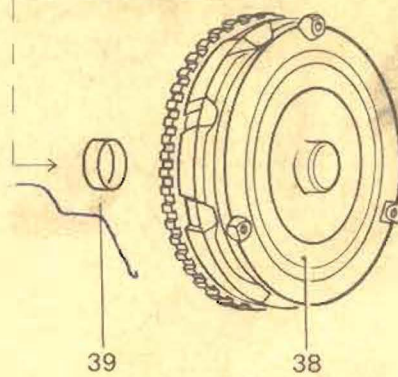
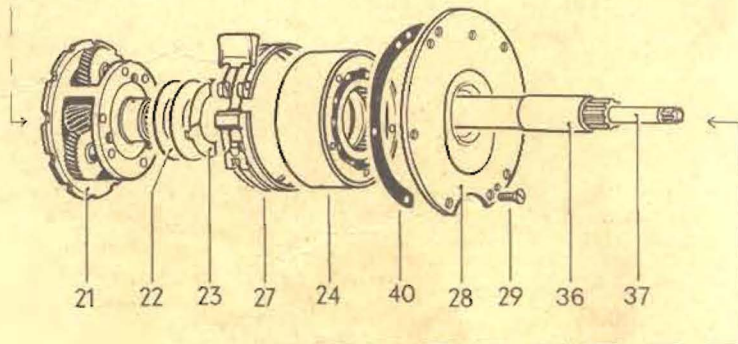
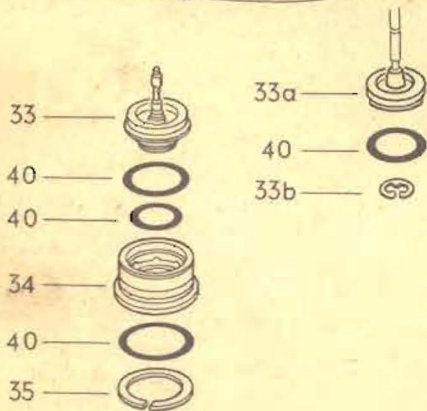
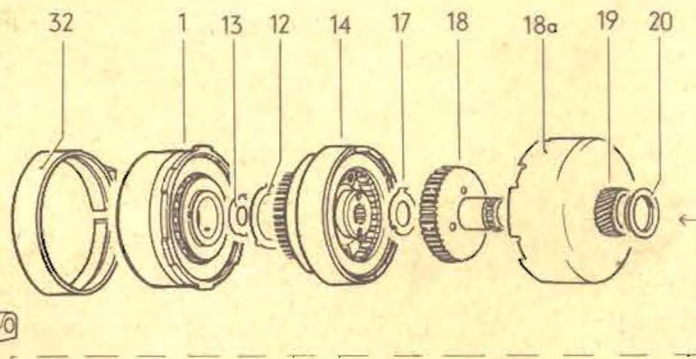
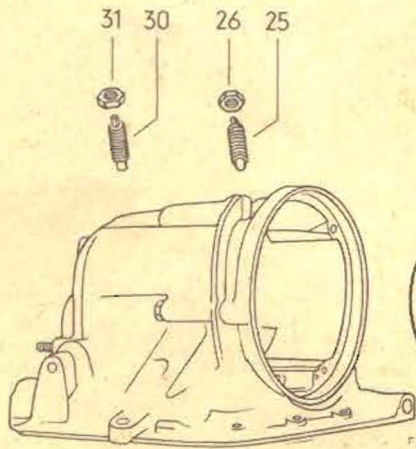
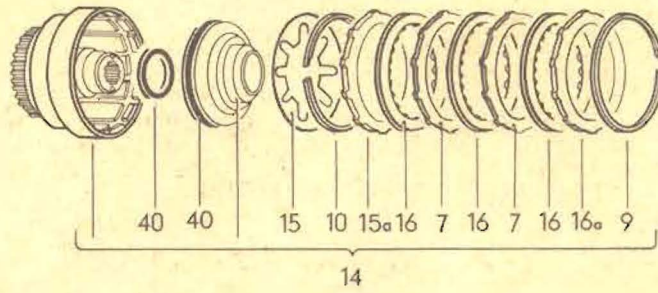
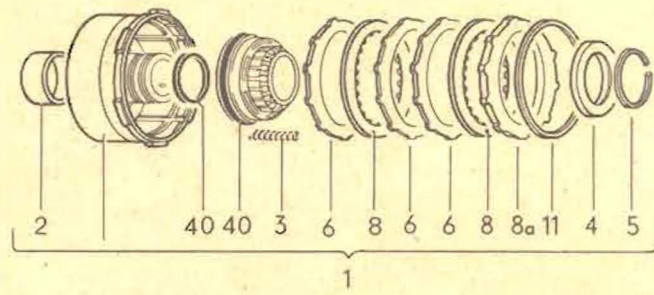

MAIN GROUP 3

TRANSMISSION

Key	Part No.	Description	Qty.	Type and model
FORWARD-DIRECT-REVERSE				
GEAR CLUTCH				
TORQUE CONVERTER (AUTOMATIC)				
from Ch. No. 318 015 226				M 249
1	003 323 105 A	Clutch – Direct and reverse gear	1	
2	003 323 115	Bush for direct and reverse gear clutch	1	
3	003 323 129	Spring for direct and reverse gear clutch	18	
4	003 323 131	Concave washer for direct and reverse gear clutch	1	
(5)	003 323 135	Lock ring 55 mm dia. – Concave washer to Ch. No. 310 2500 000	1	
5	003 323 135 A	Lock ring 55 mm dia. – Concave washer from Ch. No. 311 2000 001	1	
6	003 323 139	Disc (external splines) for direct and reverse gear clutch	3	
7	003 323 139	Disc (external splines) for forward clutch	2	
8	003 323 141	Disc (internal splines) – Direct and reverse gear clutch	2	
8a	003 323 153	End plate for direct and reverse gear clutch	1	
(11)	003 323 157	Lock ring 123 mm dia., 1.7 mm wide for direct and reverse gear clutch to Ch. No. 310 2119 999	1	
9	003 323 157	Lock ring 123 mm dia., 1.7 mm wide for forward clutch	X	
10	003 323 157 A	Lock ring 123 mm dia., 2.0 mm wide for concave washer – Forward clutch	1	
(9)	003 323 157 A	Lock ring 123 mm dia., 2.0 mm wide for forward clutch	X	
11	003 323 157 A	Lock ring 123 mm dia., 2.0 mm wide for direct and reverse gear clutch from Eng. No. 310 2120 000	X	
(9)	003 323 157 B	Lock ring 123 mm dia., 2.5 mm wide for forward clutch	X	
(9)	003 323 157 C	Lock ring 123 mm dia., 2.3 mm wide for forward clutch	X	
(9)	003 323 157 D	Lock ring 123 mm dia., 1.5 mm wide for forward clutch	X	
(11)	003 323 157 D	Lock ring 123 mm dia., 1.5 mm wide for direct and reverse gear clutch from Eng. No. 310 2120 000	X	

12	003 323 161	Thrust washer 60 mm dia. for direct and reverse gear clutch	1
13	003 323 165	Thrust washer 40 mm dia. for forward clutch	1
(14)	003 323 205	Forward clutch to Ch. No. 310 2119 999	1
14	003 323 205 F	Forward clutch from Ch. No. 310 2120 000	1
15	003 323 229	Concave washer - Forward clutch	1
15a	003 323 237	Pressure plate for forward clutch	1
(16)	003 323 241	Driving disc - Forward clutch to Ch. No. September 1971	3
16	003 323 241 A	Driving disc - Forward clutch from Ch. No. October 1971	3
16a	003 323 253	End plate for forward clutch	1
17	003 323 261	Thrust washer 38 mm dia. - Clutch hub	1
18	003 323 271	Clutch hub	1
18a	003 323 281	Driving shell	1
19	003 323 285	Sun gear	1
20	003 323 293	Thrust washer 43 mm dia. - Sun gear	1
(21)	003 323 303	Planet pinion carrier to Ch. No. August 1971	1
21	003 323 303 A	Planet pinion carrier from Ch. No. September 1971	1
22	003 323 345	Shim 0.4 mm - Planet pinion carrier	X
(22)	003 323 346	Shim 1.2 mm - Planet pinion carrier	X
(23)	003 323 353	Thrust washer 70 mm dia. - Bearing flange to Ch. No. August 1971	1
23	003 323 353 A	Thrust washer 70 mm dia. - Bearing flange from Ch. No. September 1971	1
24	003 323 361	Annulus gear	1
25	003 323 405	Adjusting screw - Reverse gear brake band	1
26	N 11 162 1	Nut, hex. M 12 x 1.5	1
27	003 323 411	Brake band - Reverse gear	1
28	003 323 443 C	Bearing flange	1
29	N 10 984 1	Screw, countersunk hd. AM 6 x 10	2
30	003 323 455	Adjusting screw - 2nd gear brake band	1
31	N 11 162 1	Nut, hex. M 12 x 1.5	1
32	003 323 461	Brake band - 2nd gear	1
33	003 323 511 A	Piston for 2nd gear brake	1
33a	003 323 483 A	Piston for 1st and reverse gear brake	1
33b	N 12 436 2	Lock washer 6	1
(34)	003 323 529	Cover 94.9 mm for 2nd gear brake to Ch. No. 310 2119 999	1
34	003 323 529 B	Cover 96.9 mm for 2nd gear brake from Eng. No. 310 2120 000	1

35	003 323 537	Lock ring - Cover for 2nd gear brake	1
36	003 323 555	Drive shaft	1
37	003 323 561	Shaft - Oil pump	1
38	003 323 571 D	Torque converter	1
39	003 323 611	Bush - Torque converter	1
40	003 398 007	1 set of gaskets for transmission - Automatic	1

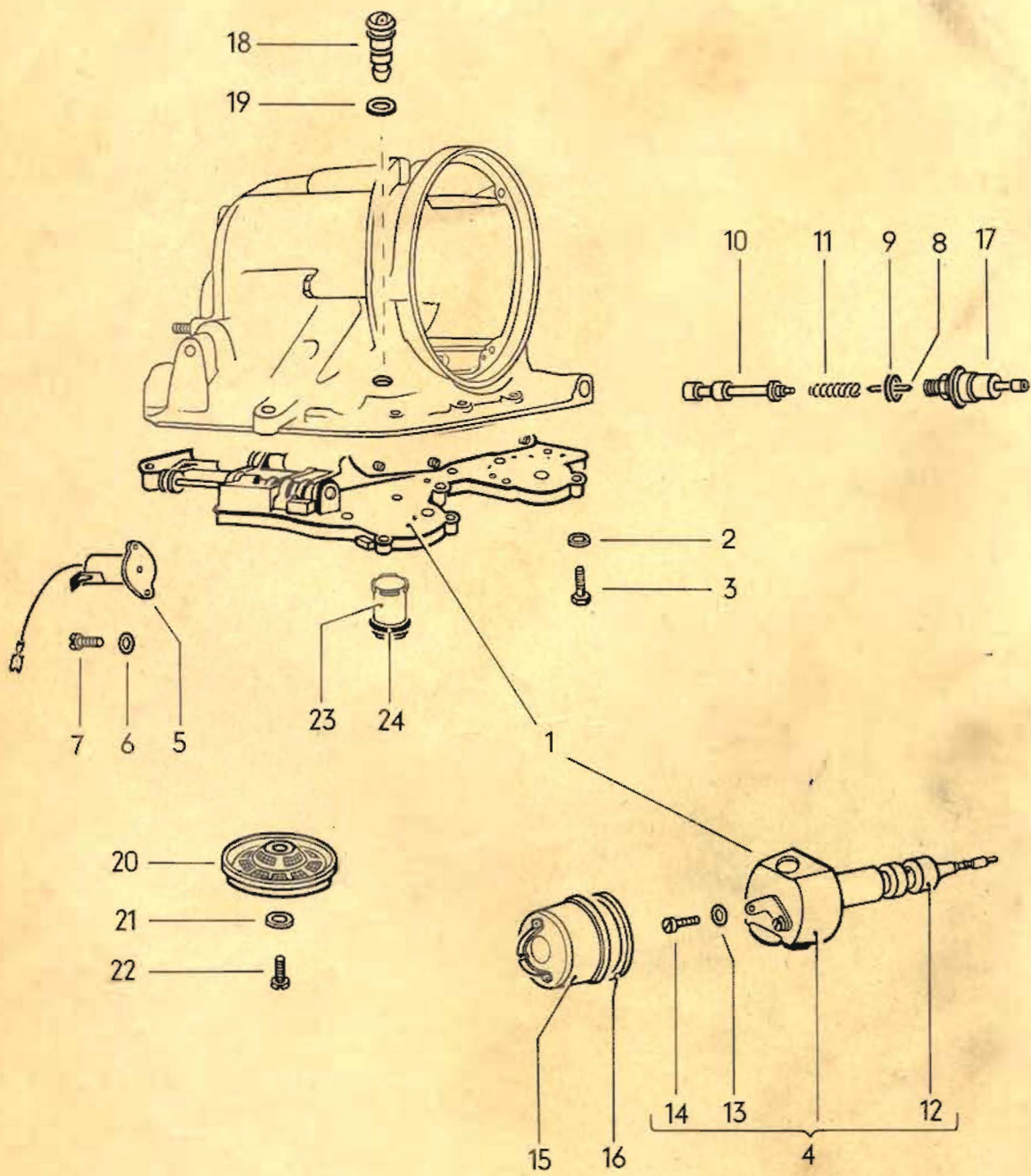

MAIN GROUP 3

TRANSMISSION

Key	Part No.	Description	Qty.	Type and model
VALVE BODY				
OIL STRAINER (AUTOMATIC)				
from Ch. No. 318 015 226				
				M 249
1	003 325 029	*Valve body with governor	1	
(1)	003 325 029 A	*Valve body with governor to Ch. No. 311 2500 000	1	M 236
2	N 12 226 2	Spring washer B 6	15	
3	N 10 346 2	Bolt, hex. hd. BM 6 x 30	15	
4	003 325 041	Governor	1	
5	003 927 105	Electro magnet	1	
6	N 12 225 1	Spring washer B 5	2	
7	N 10 702 1	Screw, cheese hd. AM 5 x 15	2	
8	003 325 261	Operation pin - Vacuum unit and electro magnet	2	
9	N 13 814 2	Sealing ring A 14 x 18 x 1.5	1	
10	003 325 291	Primary modulator valve	1	
11	003 325 295	Spring - Primary modulator valve	1	
12	003 325 305	Shaft - Governor	1	
13	N 12 225 1	Spring washer B 5	2	
14	N 10 724 1	Screw, cheese hd. AM 5 x 40	2	
15	003 325 371	Governor cap	1	
16	003 325 381	Seal 96 mm dia. - Governor cap and cover for 2nd gear brake	2	
17	003 325 391	Vacuum unit	1	
(17)	003 325 391 A	*Vacuum unit (marked yellow) to Ch. No. 311 2500 000	1	M 236
(17)	003 325 391 C	*Vacuum unit (marked brown) from Ch. No. 312 2000 001	1	M 236
18	003 927 113	Connecting piece	1	
19	003 927 115	Seal - Connecting piece	1	
20	003 325 421	Oil strainer	1	
21	N 12 226 2	Spring washer B 6	1	
23	003 325 409	Piston - Accumulator	1	
22	N 10 715 2	Screw, cheese hd. AM 6 x 15	1	
24	003 398 007	1 set of gaskets for automatic transmission	1	

MAIN GROUP 3

Part No.	Description	Qty.
REPAIR KITS		
111 398 005	1 set of gaskets – Transmission	
	to Ch. No. 318 500 000	
	from Ch. No. 319 000 001: M 263	
	comprising:	
113 301 185	Gasket – Final drive cover	2
113 301 185 A	Gasket – Final drive cover	2
113 301 191	Gasket – Gear carrier	1
211 301 215	Gasket – Gearshift housing	1
111 307 113 C	Oil seal – Main drive shaft	1
113 309 381 A	Lock plate – Main drive shaft and drive pinion	2
113 311 225	Lock plate – Retainer	2
111 501 131	Gasket 0.2 mm – Rear axle tube retainer	6
111 501 133	Gasket 0.1 mm – Rear axle tube retainer	2
N 12 419 1	Lockring 19 x 1.2	2
003 398 007	1 set of gaskets for transmission – Automatic	
	from Ch. No. 318 012 226: M 249	
	comprising:	
	Seal 16 mm dia. – Lever	1
003 321 371	Gasket – Oil sump	1
	Gasket – Rear axle housing	1
003 321 419	Seal 24.5 mm dia.	1
	for oil filler pipe	
	Seal 54 mm dia.	1
	for direct and reverse gear clutch	
	Seal 112 mm dia. – Clutch	2
	Seal 54.6 mm dia. – Forward clutch	1
	Gasket – Bearing flange	1
	Seal 68 mm dia., lower	2
	for piston for 2nd gear brake and reverse gear	
	Seal 86 mm dia., upper	1
	for piston for 2nd gear brake	
003 325 381	Seal 96 mm dia.	1
	Cover for 2nd gear brake	
	Seal 46 mm dia. – Accumulator piston	1
003 927 115	Seal – Connecting piece	1
N 13 814 2	Sealing ring A 14 x 18 x 1.5	1
N 13 840 1	Sealing ring D 10 x 16	1

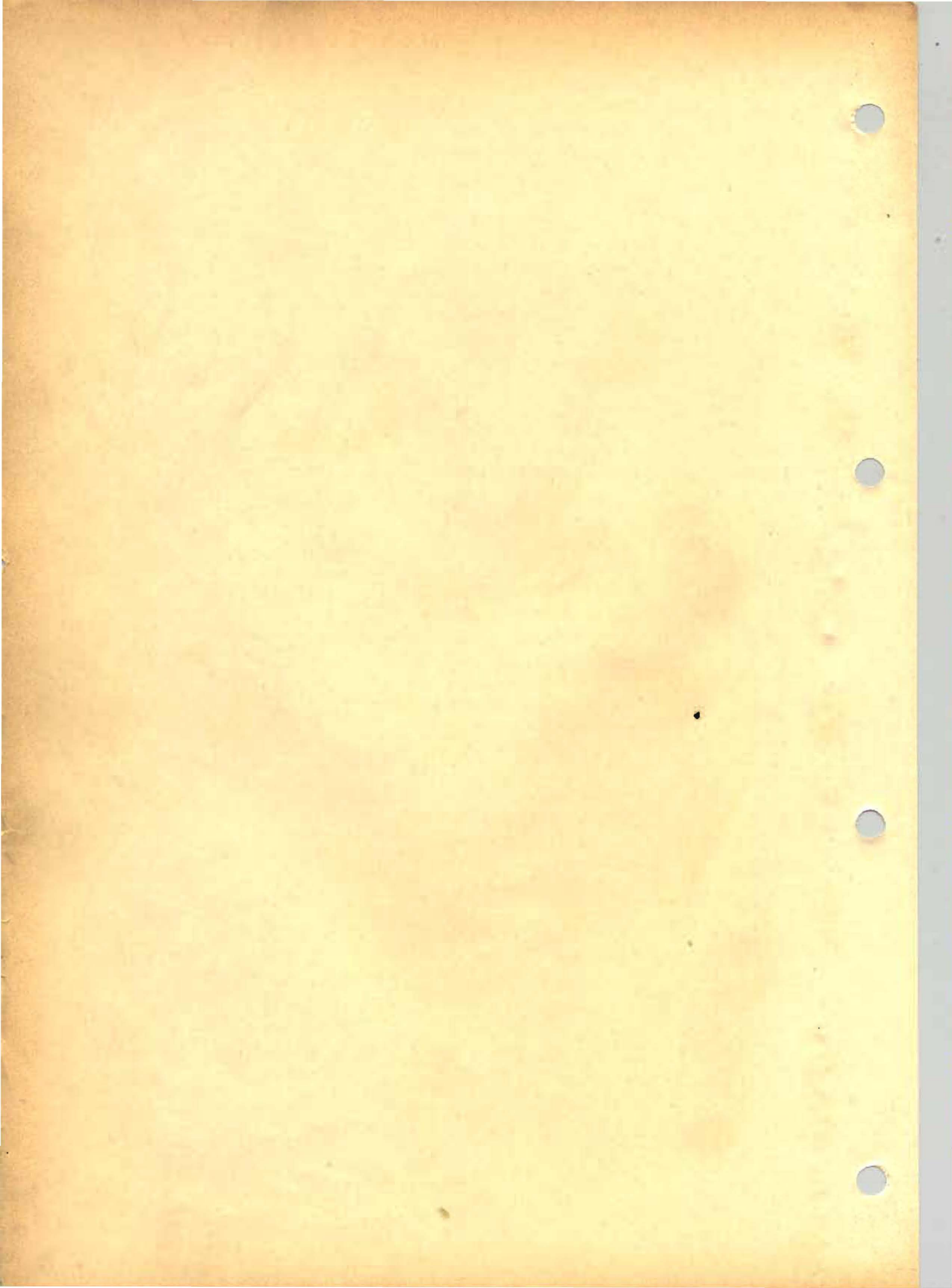

MAIN GROUP 3

Part No.	Description	Qty.
REPAIR KITS		
111 398 005	1 set of gaskets – Transmission	
	to Ch. No. 318 500 000	
	from Ch. No. 319 000 001: M 263	
	comprising:	
113 301 185	Gasket – Final drive cover	2
113 301 185 A	Gasket – Final drive cover	2
113 301 191	Gasket – Gear carrier	1
211 301 215	Gasket – Gearshift housing	1
111 307 113 C	Oil seal – Main drive shaft	1
113 309 381 A	Lock plate – Main drive shaft and drive pinion	2
113 311 225	Lock plate – Retainer	2
111 501 131	Gasket 0.2 mm – Rear axle tube retainer	6
111 501 133	Gasket 0.1 mm – Rear axle tube retainer	2
N 12 419 1	Lockring 19 x 1.2	2
003 398 007	1 set of gaskets for transmission – Automatic	
	from Ch. No. 318 012 226: M 249	
	comprising:	
	Seal 16 mm dia. – Lever	1
003 321 371	Gasket – Oil sump	1
	Gasket – Rear axle housing	1
003 321 419	Seal 24.5 mm dia.	1
	for oil filler pipe	
	Seal 54 mm dia.	1
	for direct and reverse gear clutch	
	Seal 112 mm dia. – Clutch	2
	Seal 54.6 mm dia. – Forward clutch	1
	Gasket – Bearing flange	1
	Seal 68 mm dia., lower	1
	for piston for 1nd gear brake and reverse gear	
	Seal 86 mm dia., upper	1
	for piston for 2nd gear brake	
003 325 381	Seal 96 mm dia.	1
	Cover for 2nd gear brake	
	Seal 46 mm dia. – Accumulator piston	1
003 927 115	Seal – Connecting piece	1
N 13 814 2	Sealing ring A 14 x 18 x 1.5	1
N 13 840 1	Sealing ring D 10 x 16	1