

MAIN GROUP 7

FRAME HAND LEVER SYSTEM PEDAL CLUSTER

| | Illustration |
|------------------------------|--------------|
| 05 Frame | 34 |
| 07 Bumpers | 35 |
| 11 Hand controls | 36 |
| 13 Hands control (Automatic) | A36 |
| 21 Pedal cluster | 37 |
| 23 Pedal cluster (Automatic) | 37 |
| 98 Repair kits | - |

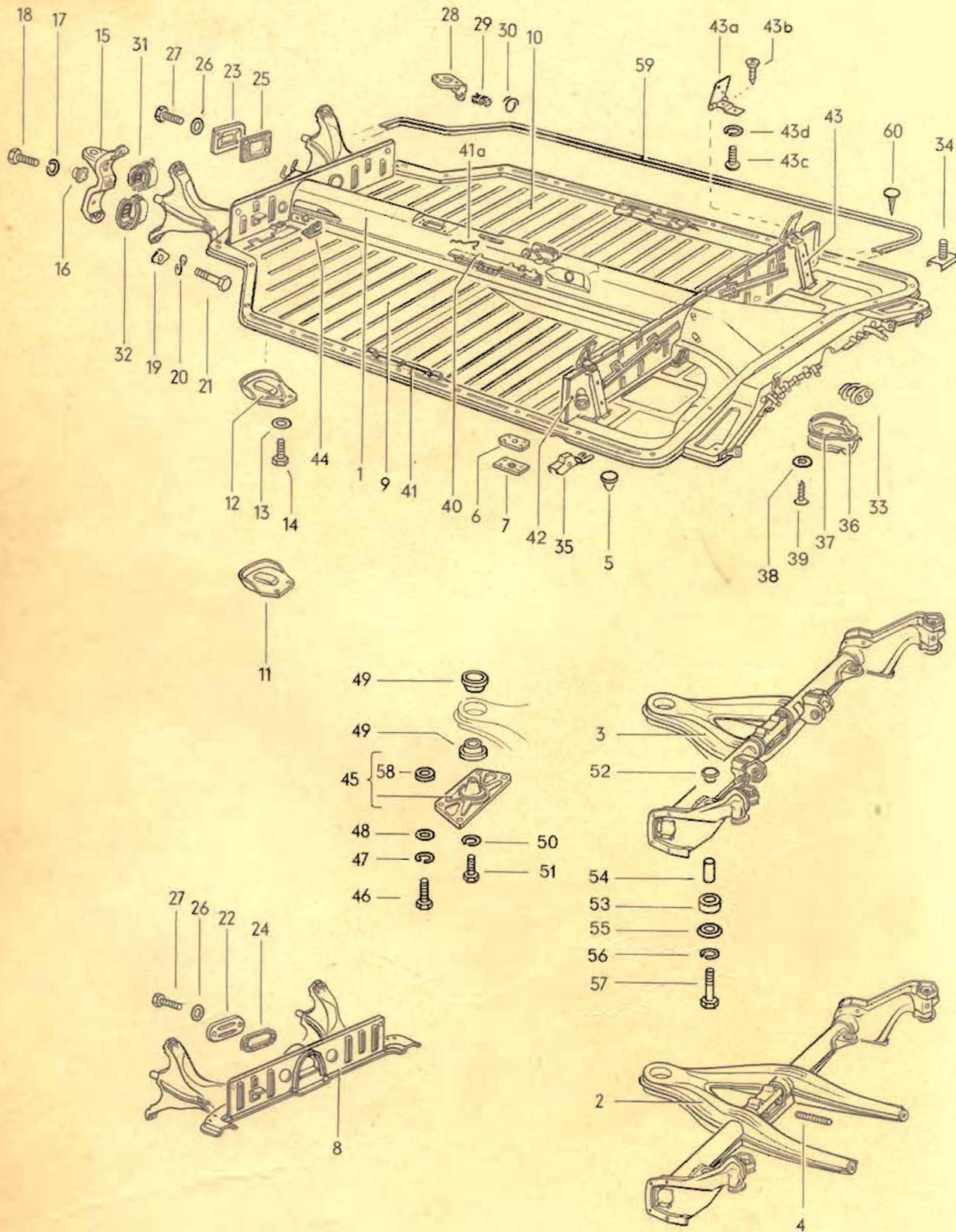

PEDAL CLUSTER

| Key | Part No. | Description | Qty. | Type and model |
|--------------|---------------|---|--------|-------------------------------------|
| FRAME | | | | |
| 1 | 311 700 027 | Frame without sub-frame with sound absorbers use to Ch. No. 221 974 311 798 001/001 A and 2 of 311 255 547/ 311 255 553/563 from Ch. No. 221 975 to 483 592 311 798 001/011 A from Ch. No. 315 000 001 to 316 500 000 311 798 011 A additionally to Ch. No. 317 500 000 311 711 251 additionally to Ch. No. 315 048 101 311 711 707 D | 1 | 311,313,315,317, 361,363,365,367 |
| (1) | 312 700 021 | Frame without sub-frame to Ch. No. 221 974 | 1 | 312, 314 |
| (1) | 312 700 027 | Frame without sub-frame with sound absorbers use to Ch. No. 221 974 312 798 001/311 798 011 A and 2 of 311 255 547/553/563 from Ch. No. 221 975 to 483 592 312 798 001/311 798 011 A from Ch. No. 315 000 001 to 316 500 000 311 798 011 A additionally to Ch. No. 317 500 000 311 711 251 additionally to Ch. No. 315 048 101 311 711 707 D | 1 | 312,314,316,318, 362,364,366,368 |
| - | N 20 027 1 | Plug A 15 x 1 for frame front and rear | 1 | |
| 2 | 361 700 041 D | Sub-frame to Ch. No. 318 500 000 from Ch. No. 319 000 001 use 311 301 265 E to Ch. No. 317 500 000 | 1 1 | M 263 |
| 3 | 311 700 041 D | Sub-frame from Ch. No. 318 015 226 to 318 500 000 from Ch. No. 319 000 001 | 1 1 | M 249 |

| | | | | |
|------|---------------|--|--------|-------------------------------------|
| 4 | N 14 499 1 | Stud AM 10 B x 28 to Ch. No. 317 500 000 | 2 | |
| 5 | 111 701 309 | Water drain valve for tunnel plate from Ch. No. 317 000 001 | 1 | |
| 6 | 311 705 127 | Threaded plate – Safety belt mounting on floor plate from Ch. No. 445 247 | 2 | |
| 7 | 311 701 449 | Threaded plate – Safety belt mounting on floor plate to Ch. No. 445 246 | 2 | |
| 8 | 311 705 037 | Frame head | 1 | 311,313,315,317, 361,363,365,367 |
| (8) | 312 705 037 | Frame head | 1 | 312,314,316,318, 362,364,366,368 |
| 9 | 311 705 057 | Floor plate, left | 1 | 311,313,315,317, 361,363,365,367 |
| (9) | 312 705 057 | Floor plate, left | 1 | 312,314,316,318, 362,364,366,368 |
| 10 | 311 705 058 | Floor plate, right | 1 | 311,313,315,317, 361,363,365,367 |
| (10) | 312 705 058 | Floor plate, right | 1 | 312,314,316,318, 362,364,366,368 |
| 11 | 311 705 221 | Cover plate for master cylinder to Ch. No. 317 500 000 | 1 | |
| 12 | 311 705 221 A | *Cover plate for master cylinder from Ch. No. 317 000 001 to 317 500 000 from Ch. No. 318 000 001 | 1 1 | M 139 |
| 13 | N 12 226 2 | Spring washer B 6 | 2 | |
| 14 | N 10 2107 | Bolt, hex. hd. M 6 x 10 K | 2 | |
| 15 | 311 705 237 B | Bracket – Front axle | 2 | |
| 16 | 311 705 243 | Spacer – Front axle mounting | 2 | |
| 17 | N 12 011 2 | Lock washer A 10 | 2 | |
| 18 | N 10 063 1 | Bolt, hex. hd. M 10 x 30 | 2 | |
| 19 | 311 705 246 | Packing – Front axle bracket mounting | 4 | |
| 20 | N 12 231 1 | Spring washer A 10 | 4 | |
| 21 | N 10 023 2 | Bolt, hex. hd. M 10 x 45/25 | 4 | |
| 22 | 311 705 253 | Cover – Frame head to Ch. No. 316 107 734 | 1 | |
| 23 | 311 705 253 A | Cover – Frame head from Ch. No. 316 107 735 | 1 | |
| 24 | 311 705 257 | Seal – Frame head cover to Ch. No. 316 107 734 | 1 | |
| 25 | 311 705 257 A | Seal – Frame head cover from Ch. No. 316 107 735 | 1 | |

| | | | | |
|------|---------------|---|---|---------|
| 26 | 211 805 243 | Spring washer 6.5 x 17 | 2 | |
| 27 | N 10 212 3 | Bolt, hex. hd. M 6 x 12 | 2 | |
| 28 | 111 701 255 B | Guide for gearshift rod to Ch. No. 317 500 000 | 1 | |
| 29 | 111 701 259 A | Bush for gearshift rod guide | 1 | |
| 30 | 111 701 263 | Retaining ring for bush | 1 | |
| 31 | 311 705 261 A | Rubber collar, upper for front axle | 2 | |
| (32) | 311 705 263 | Rubber collar, lower for front axle to Ch. No. 317 181 001 | 2 | |
| 32 | 311 705 263 A | Rubber collar, lower, left for front axle from Ch. No. 317 181 002 | 1 | |
| (32) | 311 705 264 | Rubber collar, lower, right for front axle from Ch. No. 317 181 002 | 1 | |
| 33 | 311 705 345 | Boot - Cable guide | 1 | |
| 34 | 111 701 415 | Bolt - Battery mounting | 1 | |
| 35 | 311 705 431 | Socket - Jack | 2 | |
| 36 | 311 705 445 A | Cover plate for shift rod coupling | 1 | |
| 37 | 311 705 449 | Gasket - Cover plate | 1 | |
| 38 | N 12 131 2 | Shake-proof washer J 3.7 | 3 | |
| 39 | N 13 958 3 | Tapping screw, fillister hd. B 3.5 x 13 | 3 | |
| (40) | 311 705 453 B | Runner, inner - Front seat, left to Ch. No. 311 2500 000 | 1 | |
| (40) | 311 705 454 B | Runner, inner - Front seat, right to Ch. No. 311 2500 000 | 1 | |
| 40 | 311 705 455 B | Runner, inner - Front seat, left from Ch. No. 312 2000 001 | 1 | |
| (40) | 311 705 456 B | Runner, inner - Front seat, right from Ch. No. 312 2000 001 | 1 | |
| 41 | 311 705 459 | Runner, outer - Front seat ✓ | 2 | |
| 41a | 311 705 463 A | Spring - Runner from Ch. No. 312 2000 001 | 2 | |
| 42 | 311 705 481 C | Kick plate | 1 | 311-318 |
| (42) | 361 705 481 C | Kick plate | 1 | 361-368 |
| 43 | 311 705 487 A | Bracket - Kick plate | 2 | 361-368 |
| 43a | 361 705 535 B | Hinge - Rear seat | 2 | 361-368 |
| 43b | N 14 099 3 | Tapping screw, csk. raised hd. B 4.8 x 13 | 2 | 361-368 |
| 43c | N 14 138 9 | Screw, fillister hd. AM 6 x 10 | 2 | 361-368 |
| 43d | N 12 006 2 | Lock washer B 6 | 2 | 361-368 |

| | | | | |
|------|---------------|---|--------|---|
| 44 | 111 701 535 A | Bracket for accelerator pedal on floor plate to Ch. No. 315 048 101 from Ch. No. 316 142 515 | 1 1 | 312, 314, 316, 318, 362, 364, 366, 368 |
| 45 | 311 705 679 | Reinforcement plate for sub-frame mounting, front | 1 | |
| 46 | N 10 238 7 | Bolt, hex. hd. M 8 x 15 | 4 | |
| 47 | N 12 008 2 | Lock washer B 8 to Ch. No. 310 2160 000 | 4 | |
| (48) | N 11 526 2 | Washer B 8.4 to Ch. No. 310 2160 000 | 4 | |
| 48 | | | | |
| - | N 12 241 2 | Spring washer B 8 x 15 from Ch. No. 310 2160 001 | 4 | |
| 49 | 311 705 683 | Rubber bush for sub-frame mounting, front | 2 | |
| 50 | N 12 011 2 | Lock washer A 10 | | |
| 51 | N 10 252 4 | Bolt, hex. hd. M 10 x 20 | 1 | |
| 52 | 311 705 687 | Rubber bush for sub-frame mounting, rear | 2 | |
| 53 | 311 705 689 | Thrust ring for sub-frame mounting, rear | 2 | |
| 54 | 311 705 691 | Spacer sleeve for sub-frame mounting, rear | 2 | |
| 55 | 311 705 695 | Washer for sub-frame mounting, rear | 2 | |
| 56 | N 12 011 2 | Lock washer A 10 | 2 | |
| 57 | N 10 445 1 | Bolt, hex. hd. M 10 x 45 | 2 | |
| 58 | 311 705 761 A | Washer - Reinforcement plate | 4 | |
| 59 | 113 701 605 | Weatherstrip between body and frame | 1 | |
| 60 | 111 701 625 | Tack | X | |

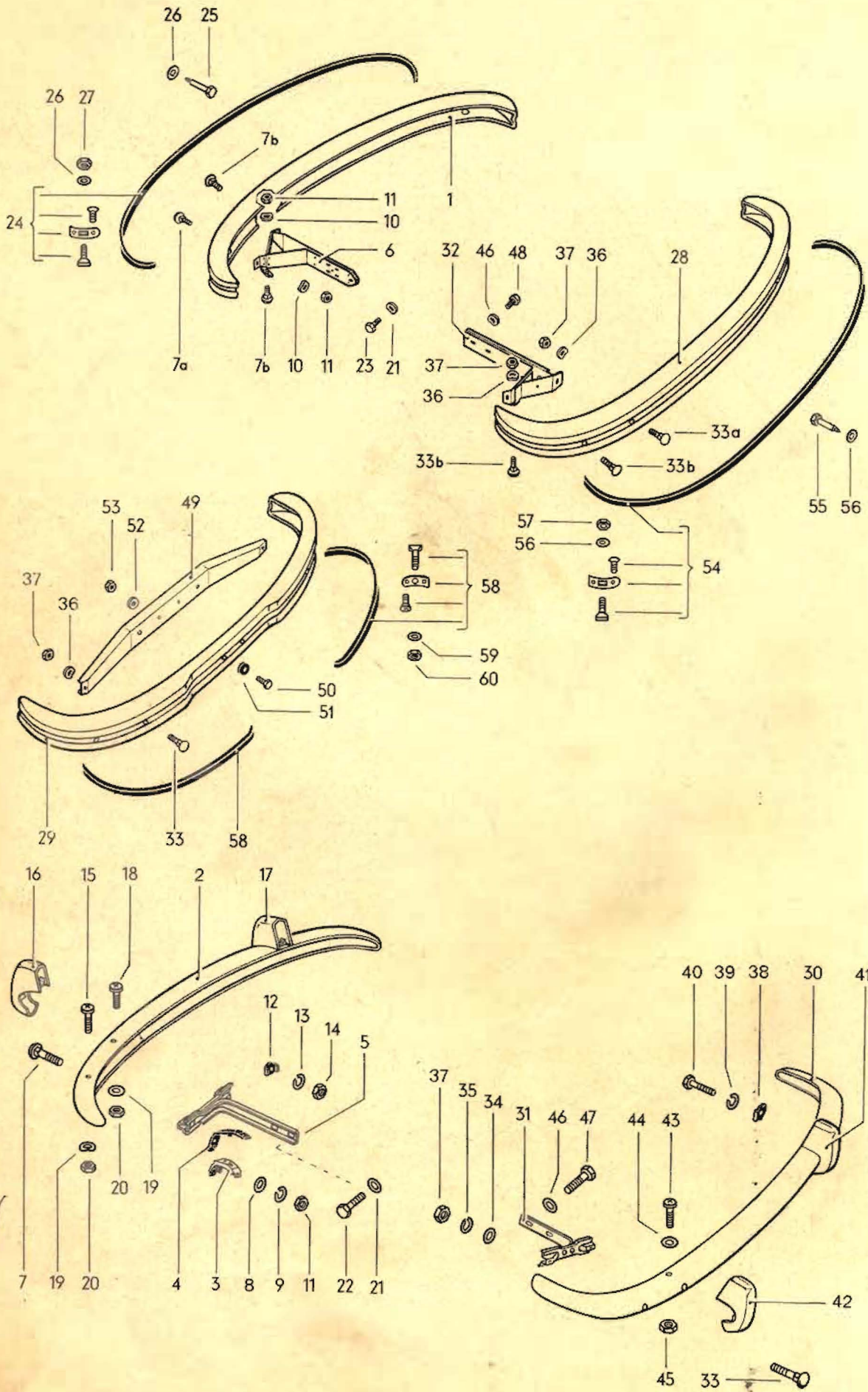

PEDAL CLUSTER

| Key | Part No. | Description | Qty. | Type and model |
|----------------|---------------|---|------|-----------------|
| BUMPERS | | | | |
| (1) | 311 707 103 | Bumper, front from Ch. No. 310 2000 001 to 311 2500 000 | 1 | |
| 1 | 315 707 103 A | Bumper, front from Ch. No. 312 2000 001 | 1 | |
| 2 | 311 707 111 J | Bumper, front to Ch. No. 319 500 000* use: to Ch. No. 64 915, 311 707 135 A/136 A | 1 | |
| (1) | 311 707 111 L | Bumper, front, primed from Ch. No. 310 2000 001 | 1 | M 163 |
| (2) | 315 707 111 C | Bumper, front, primed to Ch. No. 319 500 000 | 1 | M 163 |
| 3 | 311 707 127 | Bracket - Horn from Ch. No. 315 000 001 to 319 500 000 | 1 | |
| 4 | 311 707 129 | Packing - Bracket from Ch. No. 315 000 001 to 319 500 000 | 1 | |
| 5 | 311 707 135 A | Bracket, front, left - Bumper to Ch. No. 319 500 000 | 1 | |
| 6 | 311 707 135 D | Bracket, front, left - Bumper from Ch. No. 310 2000 001 | 1 | |
| (5) | 311 707 136 A | Bracket, front, right - Bumper to Ch. No. 319 500 000 | 1 | |
| (6) | 311 707 136 B | Bracket, front, right - Bumper from Ch. No. 310 2000 001 | 1 | |
| 7 | 311 707 141 C | Screw M 8 x 51 - Bumper to Ch. No. 319 500 000 | 2 | 311-314,361-364 |
| | | | 4 | 315-318,365-368 |
| 7a | 113 707 191 | Screw M 8 x 20 - Bumper from Ch. No. 310 2000 001 | 2 | |
| 7b | 113 707 191 C | Screw M 8 x 15 - Bumper from Ch. No. 310 2000 001 | 4 | |
| 8 | N 11 526 2 | Washer B 8.4 to Ch. No. 319 500 000 | 2 | |
| 9 | N 12 009 1 | Lock washer A 8 to Ch. No. 319 500 000 | 2 | 311-314,361-364 |
| | | | 4 | 315-318,365-368 |
| | | from Ch. No. 310 2000 001 | | |
| 10 | 131 821 150 | *Spring washer | 6 | |

| | | | | |
|------|---------------|--|---|------------------|
| 11 | N 11 008 8 | Nut, hex. M 8 to Ch. No. 319 500 000 | 2 | 311-314,361-364 |
| | | from Ch. No. 310 2000 001 | 4 | 315-318,365-368 |
| | | | 6 | |
| 12 | 311 707 145 | Reinforcement – Overrider mounting to Ch. No. 317 500 000 | 1 | |
| | | from Ch. No. 318 000 001 to 319 500 000 | 2 | |
| 13 | N 12 009 1 | Lock washer A 8 to Ch. No. 319 500 000 | 2 | 311-314,361-364 |
| 14 | N 10 360 2 | Bolt, hex. hd. BM 8 x 60 to Ch. No. 319 500 000 | 2 | 311-314,361-364 |
| 15 | 315 707 151 | Screw M 6 x 15 – Bracket from Ch. No. 221 975 to 319 500 000 | 1 | 315-318,365-368 |
| | | from Ch. No. 318 000 001 to 319 500 000 | 1 | 311-314,361-364 |
| 16 | 311 707 155 A | Overrider, front left to Ch. No. 319 500 000 | 1 | 311-314,361-364 |
| 17 | 311 707 156 A | Overrider, front right to Ch. No. 319 500 000 | 1 | 311-314,361-364 |
| 18 | N 14 141 2 | Screw, fillister hd. AM 6 x 18 to Ch. No. 319 500 000 | 2 | 311-314,361-364 |
| 19 | 111 837 201 | *Spring washer 7.4 x 15 to Ch. No. 319 500 000 | 3 | 311-314,361-364 |
| | | | 2 | 315-318,365-368 |
| 20 | N 11 006 2 | Nut, hex. M 6 to Ch. No. 319 500 000 | 3 | 311-314,361-364 |
| | | | 2 | 315-318,365-368 |
| 21 | 131 821 150 | *Spring washer to Ch. No. 319 500 000 | 4 | |
| | | from Ch. No. 310 2000 001 | 6 | |
| (22) | N 10 242 5 | Bolt, hex. hd. M 8 x 25 to Ch. No. 315 124 240 | 4 | |
| 22 | N 10 238 7 | Bolt, Hex. hd. M 8 x 15 from Ch. No. 315 124 241 to 319 500 000 | 4 | |
| 23 | N 10 239 0 | Bolt, hex. hd. M 8 x 18 from Ch. No. 310 2000 001 | 6 | |
| (24) | 311 707 201 A | Rubber molding – Bumper, front from Ch. No. 310 2000 001 to 311 2500 000 | 1 | 311-314, 361-364 |
| 24 | 311 707 401 | Rubber molding – Bumper, front from Ch. No. 312 2000 001 | 1 | |
| 25 | 411 707 199 | Tapping screw, hex.hd. for rubber molding mounting from Ch. No. 310 2000 001 | 1 | 311-314,361-364 |
| 26 | N 11 524 4 | Washer A 6.4 from Ch. No. 310 2000 001 | 3 | 311-314, 361-364 |
| 27 | N 11 006 2 | Spring washer M 6 from Ch. No. 310 2000 001 | 2 | 311-314,361-364 |
| 28 | 311 707 303 | Bumper, rear from Ch. No. 310 2000 001 | 1 | |

| | | | | |
|------|---------------|---|---|------------------|
| 29 | 315 707 303 | Bumper, rear from Ch. No. 310 2000 001 to 311 2500 000 | 1 | M 286 |
| 30 | 311 707 311 C | Bumper, rear to Ch. No. 319 500 000 use: 315 707 151 for models 315-318,365-368; and, to Ch. No. 64 915, 311 707 325 A/326 A | 1 | |
| (28) | 311 707 311 L | Bumper, rear, primed from Ch. No. 310 2000 001 | 1 | M 163 |
| (30) | 315 707 311 C | Bumper, rear, primed to Ch. No. 319 500 000 | 1 | M 163 |
| 31 | 311 707 325 A | Bracket, rear, left – Bumper to Ch. No. 319 500 000 | 1 | |
| 32 | 311 707 325 C | Bracket, rear, left – Bumper from Ch. No. 310 2000 001 | 1 | |
| (31) | 311 707 326 A | Bracket, rear, right – Bumper to Ch. No. 319 500 000 | 1 | |
| (32) | 311 707 326 D | Bracket, rear, right – Bumper from Ch. No. 310 2000 001 | 1 | |
| (31) | 311 707 339 | Bracket, rear – Bumper to Ch. No. 64 915 | 2 | 311-314,361,362 |
| 33 | 311 707 141 C | Screw M 8 x 51 – Bumper to Ch. No. 319 500 000 | 2 | 311-314,361-364 |
| | | | 4 | 315-318,365-368 |
| 33a | 113 707 191 | Screw M 8 x 20 – Bumper from Ch. No. 310 2000 001 | 2 | |
| 33b | 113 707 191 C | Screw M 8 x 15 – Bumper from Ch. No. 310 2000 001 | 4 | |
| 34 | N 11 526 2 | Washer B 8.4 to Ch. No. 319 500 000 | 2 | |
| 35 | N 12 009 1 | Lock washer A 8 to Ch. No. 319 500 000 | 2 | |
| 36 | 131 821 150 | *Spring washer from Ch. No. 310 2000 001 | 6 | |
| 37 | N 11 008 8 | Nut, hex. M 8 to Ch. No. 319 500 000 | 2 | 311-314,361-364 |
| | | | 4 | 315-318,365-368 |
| | | from Ch. No. 310 2000 001 | 6 | |
| 38 | 311 707 145 | Reinforcement – Overrider mounting to Ch. No. 319 500 000 | 2 | |
| 39 | N 12 009 1 | Lock washer A 8 to Ch. No. 319 500 000 | 2 | |
| 40 | N 10 360 2 | Bolt, hex. hd. BM 8 x 60 to Ch. No. 319 500 000 | 2 | 311-314, 361-364 |

| | | | | |
|------|---------------|---|--------|------------------|
| 41 | 311 707 155 A | Overrider, rear, right to Ch. No. 319 500 000 | 1 | 311-314, 361-364 |
| 42 | 311 707 156 A | Overrider, rear, left to Ch. No. 319 500 000 | 1 | 311-314, 361-364 |
| 43 | N 14 141 2 | Screw, fillister hd. AM 6 x 18 to Ch. No. 319 500 000 | 2 | 311-314, 361-364 |
| 44 | 111 837 201 | Spring washer 7.4 x 15 to Ch. No. 319 500 000 | 2 | 311-314, 361-364 |
| 45 | N 11 006 2 | Nut, hex. M 6 to Ch. No. 319 500 000 | 2 | 311-314, 361-364 |
| 46 | 131 821 150 | *Spring washer | 4 | |
| (47) | N 10 242 5 | Bolt, hex. hd. M 8 x 25 to Ch. No. 315 124 240 from Ch. No. 315 124 241 to 315 220 883 | 4 4 | 311-318 |
| 47 | N 10 238 7 | Bolt, hex. hd. M 8 x 15 from Ch. No. 315 124 241 to 315 220 883 from Ch. No. 316 000 001 to 319 500 000 | 4 4 | 361-368 |
| 48 | N 10 239 0 | Bolt, hex. hd. M 8 x 18 from Ch. No. 310 2000 001 | 4 | |
| 49 | 315 707 341 | Reinforcement - Bumper, rear from Ch. No. 310 2000 001 to 311 2500 000 | 1 | M 286 |
| 50 | N 10 215 4 | Bolt, hex. hd. M 6 x 15 from Ch. No. 310 2000 001 to 311 2500 000 | 2 | M 286 |
| 51 | 311 821 185 | Rubber washer from Ch. No. 310 2000 001 to 311 2500 000 | 2 | M 286 |
| 52 | N 12 226 2 | Spring washer B 6 from Ch. No. 310 2000 001 to 311 2500 000 | 2 | M 286 |
| 53 | N 11 006 2 | Nut, hex. M 6 from Ch. No. 310 2000 001 to 311 2500 000 | 2 | M 286 |
| 54 | 311 707 401 | Rubber molding - Bumper, rear from Ch. No. 310 2000 001 | 1 | 311-314, 361-364 |
| 55 | 411 707 199 | Tapping screw, hex. hd. for rubber molding mounting from Ch. No. 310 2000 001 | 1 | 311-314, 361-364 |
| 56 | N 11 524 4 | Washer A 6.4 from Ch. No. 310 2000 001 | 3 | 311-314, 361-364 |
| 57 | N 11 006 2 | Nut, hex. M 6 from Ch. No. 310 2000 001 | 2 | 311-314, 361-364 |
| 58 | 315 707 401 | Rubber molding - Bumper, rear from Ch. No. 310 2000 001 to 311 2500 000 | 2 | M 286 |
| 59 | N 12 227 3 | Spring washer A 6 from Ch. No. 310 2000 001 to 311 2500 000 | 4 | M 286 |
| 60 | N 11 006 2 | Nut, hex. M 6 from Ch. No. 310 2000 001 to 311 2500 000 | 4 | M 286 |

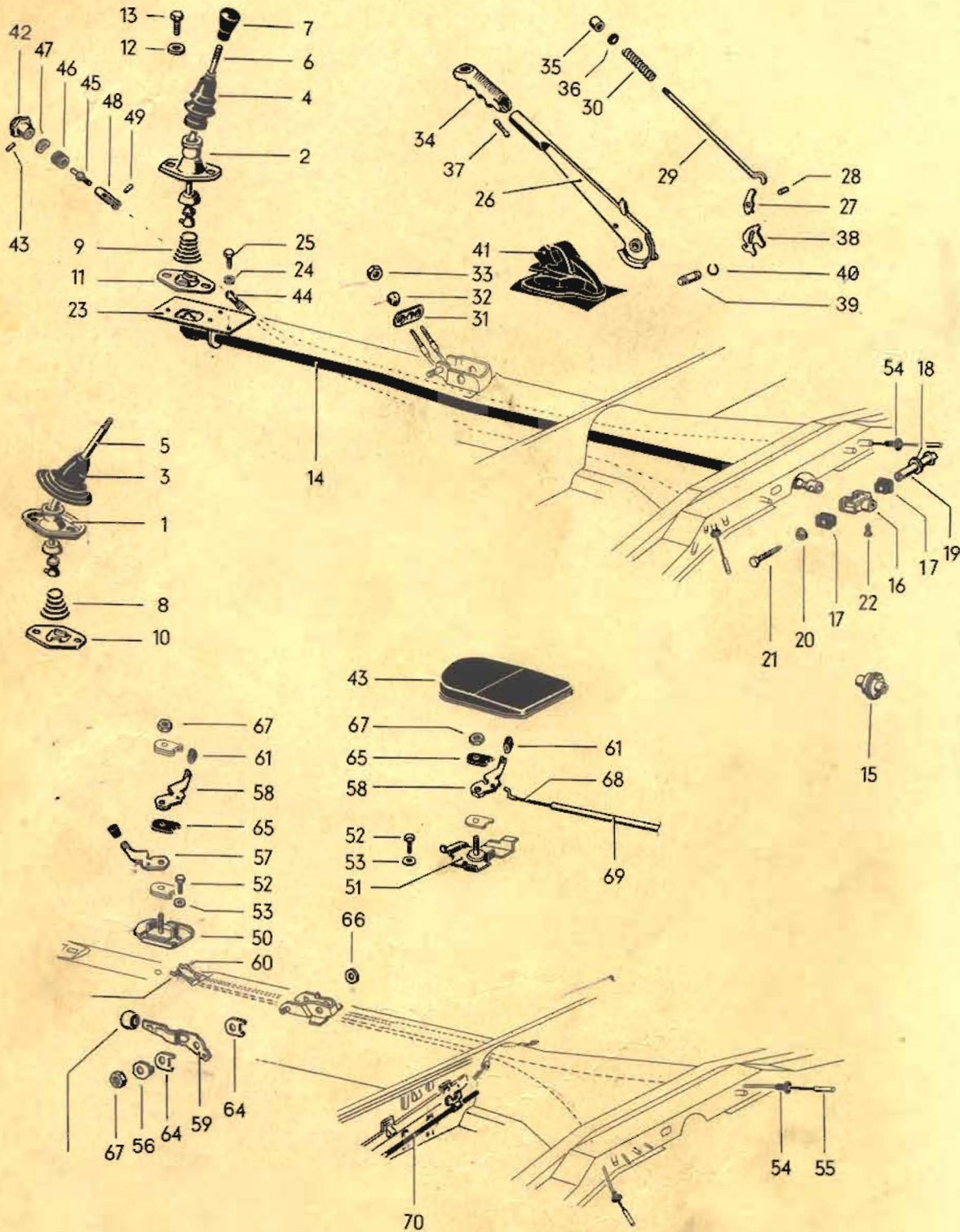

MAIN GROUP 7

**FRAME HAND LEVER SYSTEM
PEDAL CLUSTER**

| Key | Part No. | Description | Qty. | Type and model |
|--------------------------|---------------|--|------|------------------|
| HAND LEVER SYSTEM | | | | |
| 1 | 311 711 105 | Ball housing – Gearshift lever to Ch. No. 310 2500 000 | 1 | |
| 2 | 111 711 105 | Ball housing – Gearshift lever from Ch. No. 311 2000 001 to 311 2500 000 | 1 | |
| – | 111 711 105 A | Ball housing – Gearshift lever from Ch. No. 312 2000 001 | 1 | |
| 3 | 311 711 115 | Rubber boot – Gearshift lever to Ch. No. 310 2500 000 | 1 | |
| | 9/61 – 7/62 | 290 satin blue – 55, 72 | | 343 |
| | 9/61 – 7/62 | 444 malachite green – 56, 73 | | 343 |
| | 9/61 – 7/62 | 469 anthracite – 50, 51, 70, 71 | | 343 |
| | 8/62 – 7/64 | 043 grey-black | | 343-346 |
| | 8/64 – 7/65 | 469 anthracite | | 343-346 |
| | 4/61 – 7/65 | 469 anthracite | | 311-314, 361-364 |
| | 8/63 – 12/63 | 043 grey-black | | 315-318, 365-368 |
| | 1/64 – 7/65 | 469 anthracite | | 315-318, 365-368 |
| | 8/65 – 7/70 | 043 grey-black | | |
| 4 | 311 711 115 B | Boot – Gearshift lever from Ch. No. 311 2000 001 | 1 | |
| | 8/70 – | 043 grey-black | | |
| 5 | 311 711 121 | Gearshift lever to Ch. No. 310 2500 000 | 1 | 311-318, 361-368 |
| 6 | 311 711 121 E | Gearshift lever from Ch. No. 311 2000 001 | 1 | |
| – | 341 711 121 | Gearshift lever to Ch. No. 349 500 000 | 1 | 343-346 |
| 7 | 311 711 141 | Knob – Gearshift lever | 1 | |
| | 4/61 – | 043 grey-black | | |
| 8 | 311 711 145 | Spring for gearshift lever to Ch. No. 310 2500 000 | 1 | |
| 9 | 111 711 145 B | Spring for gearshift lever from Ch. No. 310 2000 001 | 1 | |
| 10 | 311 711 149 | Stop for gearshift lever to Ch. No. 310 2500 000 | 1 | |
| 11 | 111 711 149 A | Stop plate for gearshift lever from Ch. No. 311 2000 001 to 311 2500 000 | 1 | |
| – | 111 711 149 B | Stop plate for gearshift lever from Ch. No. 312 2000 001 | 1 | |

| | | | |
|----|---------------|---|---|
| 12 | 131 821 150 | *Spring washer | 2 |
| 13 | N 10 240 4 | Bolt, hex. hd. M 8 x 20 | 2 |
| - | 311 711 155 B | Gearshift rod to Ch. No. 433 785 use: to Ch. No. 221 974 311 711 211/233/239/243/N 11 560 2 | 1 |
| 14 | 311 711 155 C | Gearshift rod from Ch. No. 433 786 | 1 |
| 15 | 111 711 175 B | Coupling - Gearshift rod to Ch. No. 221 974 | 1 |
| 16 | 311 711 211 | Housing for gearshift rod coupling from Ch. No. 221 975 | 1 |
| 17 | 311 711 233 | Guide ring for gearshift rod coupling from Ch. No. 221 975 | 2 |
| 18 | N 11 560 2 | Washer 10.5 from Ch. No. 221 975 | 1 |
| 19 | 311 711 235 A | Sleeve for gearshift rod coupling from Ch. No. 221 975 | 1 |
| 20 | 311 711 239 | Locking cap for hex. hd. tapping screw from Ch. No. 221 975 | 1 |
| 21 | 311 711 243 | Tapping screw, hex. hd. A 6.5 x 41.5 for gearshift rod coupling from Ch. No. 221 975 | 1 |
| 22 | 111 711 189 | *Screw for gearshift rod coupling | 1 |
| 23 | 311 711 251 | Cover plate for gearshift guide from Ch. No. 318 000 001 | 1 |
| 24 | N 12 228 2 | Spring washer B 8 | 2 |
| 25 | N 10 238 7 | Bolt, hex. hd. M 8 x 15 | 2 |
| - | 113 711 305 | Lever - Hand brake to Ch. No. 315 144 905 | 1 |
| - | 113 711 305 A | Lever - Hand brake from Ch. No. 315 144 906 to 317 500 000 | 1 |
| 26 | 311 711 305 | Lever - Hand brake from Ch. No. 318 000 001 to 311 2500 000 | 1 |
| - | 311 711 305 A | Lever - Hand brake from Ch. No. 312 2000 001 | 1 |
| 27 | 111 711 321 | Pawl - Hand brake | 1 |
| 28 | 111 711 323 | Pin - Hand brake pawl | 1 |
| - | 111 711 325 | Rod for hand brake pawl to Ch. No. 317 500 000 | 1 |

| | | | |
|----|---------------|---|---|
| 29 | 311 711 325 | Rod for hand brake pawl from Ch. No. 318 000 001 | 1 |
| 30 | 111 711 329 | Spring – Pawl rod | 1 |
| 31 | 111 711 331 | Compensating lever for hand brake lever from Ch. No. 315 144 906 | 1 |
| 32 | 111 711 349 | *Adjusting nut – Rear brake on compensating lever from Ch. No. 315 144 906 | 2 |
| 33 | N 11 006 2 | Nut, hex. M 6 | 2 |
| 34 | 311 711 327 | *Handle for hand brake lever | 1 |
| | 4/61 – | 043 grey-black | |
| 35 | 311 711 333 | Release button for hand brake lever | 1 |
| | 4/61 – | 043 grey-black | |
| 36 | 111 711 335 | Rubber washer for hand brake lever | 1 |
| 37 | 311 711 337 | Retainer for hand brake lever grip | 1 |
| 38 | 131 711 339 | Ratchet for hand brake from Ch. No. 317 000 001 | 1 |
| – | 211 711 339 | Ratchet for hand brake from Ch. No. 316 500 000 | 1 |
| 39 | 113 711 341 | Pin 14 x 16 for hand brake lever | 1 |
| 40 | N 12 460 1 | Circlip 14 | 2 |
| 41 | 311 711 461 | Rubber boot for hand brake lever from Ch. No. 318 000 001 | 1 |
| | 8/67 – | 043 grey-black | |
| 42 | 113 711 623 A | Knob – Heating control cable to Ch. No. 221 974 466 silver beige | 1 |
| 43 | N 13 328 1 | Pin 3 x 20 | 1 |
| 44 | 311 711 629 | Cable – Heating control (length 2890 mm – 113 25/32 in.) to Ch. No. 221 974 | 1 |
| 45 | 311 711 671 | Spindle – Heating control cable to Ch. No. 221 974 | 1 |
| 46 | 111 711 675 | Cap – Heating control cable to Ch. No. 221 974 | 1 |

| | | | | |
|----|---------------|---|--------|------|
| 47 | 111 711 677 | Spring washer 10.5 x 18 to Ch. No. 221 974 | 1 | |
| 48 | 311 711 681 | Clevis – Heating control cable to Ch. No. 221 974 | 1 | |
| 49 | N 13 216 1 | Cable pin 4 x 14 | 1 | |
| – | 311 711 683 | Plate for heater control from Ch. No. 221 975 to 315 116 153 | 1 | |
| 50 | 311 711 683 A | Plate for heater control from Ch. No. 315 116 154 to 316 500 000 | 1 | |
| 51 | 311 711 687 | Plate for heater control from Ch. No. 319 108 900 to 319 500 000 | 1 | M 60 |
| 52 | N 10 212 3 | Bolt, hex. hd. M 6 x 12 | 1 | |
| 53 | N 12 226 2 | Spring washer B 6 | 1 | |
| 54 | 113 711 691 | Plug | 2 | |
| – | 311 711 707 | Heating control cable, 1295 mm – 50 $\frac{31}{32}$ in. from Ch. No. 221 975 to 315 048 101 | 1 | |
| – | 311 711 707 B | Heating control cable, 1587/1617 mm – 62 $\frac{15}{32}$ / 63 $\frac{21}{32}$ in. from Ch. No. 315 048 102 to 316 500 000 | 1 | |
| 55 | 311 711 707 C | Heating control cable, 1375/1389 mm – 54 $\frac{1}{8}$ / 54 $\frac{11}{16}$ in. from Ch. No. 317 000 001 | 1 | |
| – | 311 711 707 D | Heating control cable, 1062 mm – 41 $\frac{13}{16}$ in. for 311 700 021 AA/312 700 021 L/361 700 021 AA/ 362 700 021 M to Ch. No. 315 048 101 | 1 | |
| 56 | 131 711 665 | Stop – Lever from Ch. No. 317 000 001 | 2 | |
| 57 | 311 711 709 | Lever, left from Ch. No. 221 975 to 316 500 000 | 1 | |
| 58 | 311 711 711 | Lever, right from Ch. No. 221 975 to 316 500 000 from Ch. No. 319 108 900 to 319 500 000 | 1 1 | M 60 |
| 59 | 111 711 711 B | Lever, left from Ch. No. 317 000 001 | 1 | |
| – | 111 711 712 B | Lever, right from Ch. No. 317 000 001 | 1 | |
| – | 311 711 713 | Cable (length 790 mm – 31 $\frac{3}{32}$ in.) for footwell heating rear from Ch. No. 221 975 to 316 500 000 | 1 | |
| 60 | 311 711 713 A | Cable – Footwell heating rear from Ch. No. 317 000 001 | 1 | |

| | | | | |
|----|---------------|---|---|------|
| 61 | 311 711 741 | Knob - Lever | | |
| | | from Ch. No. 221 975 to 316 500 000 | 1 | |
| | 8/63 - 7/66 | 043 grey-black | | |
| | | from Ch. No. 319 108 900 to 319 500 000 | 1 | M 60 |
| | 1/69 - | 043 grey-black | | |
| - | 311 711 741 A | Knob red - Lever | 1 | |
| | | from Ch. No. 221 975 to 316 500 000 | | |
| 62 | 131 711 741 B | Knob - Lever | 2 | |
| | | from Ch. No. 317 000 001 | | |
| | 8/66 - | 043 grey-black | | |
| 63 | 311 711 745 | Cover | 1 | M 60 |
| | | for heater control | | |
| | | from Ch. No. 319 108 900 to 319 500 000 | | |
| | 1/69 - 7/69 | 043 grey-black | | |
| 64 | 111 711 749 A | Friction plate | 4 | |
| | | from Ch. No. 317 000 001 | | |
| 65 | 311 711 749 | Friction plate | | |
| | | from Ch. No. 221 975 to 316 500 000 | 4 | |
| | | from Ch. No. 319 108 900 to 319 500 000 | 2 | M 60 |
| 66 | 311 711 751 | Friction washer 8.2 x 20 x 0.8 | | |
| | | from Ch. No. 221 975 to 316 500 000 | 4 | |
| | | from Ch. No. 319 108 900 to 319 500 000 | 1 | M 60 |
| 67 | 311 101 463 | Nut, hex. M 8 (self-locking) | | |
| | | to Ch. No. 316 500 000 | 1 | |
| | | from Ch. No. 319 108 900 to 319 500 000 | 1 | M 60 |
| | | from Ch. No. 317 000 001 | 2 | |
| 68 | 311 711 771 A | Cable | 1 | M 60 |
| | | for temperature regulator switch | | |
| | | from Ch. No. 319 108 900 to 319 500 000 | | |
| 69 | 311 711 779 A | Protective tube | 1 | M 60 |
| | | for temperature regulator cable | | |
| | | from Ch. No. 319 108 900 to 319 500 000 | | |
| 70 | 311 711 941 | Guide tube | 2 | |
| | | for rear footwell heating | | |
| | | from Ch. No. 319 000 001 | | |

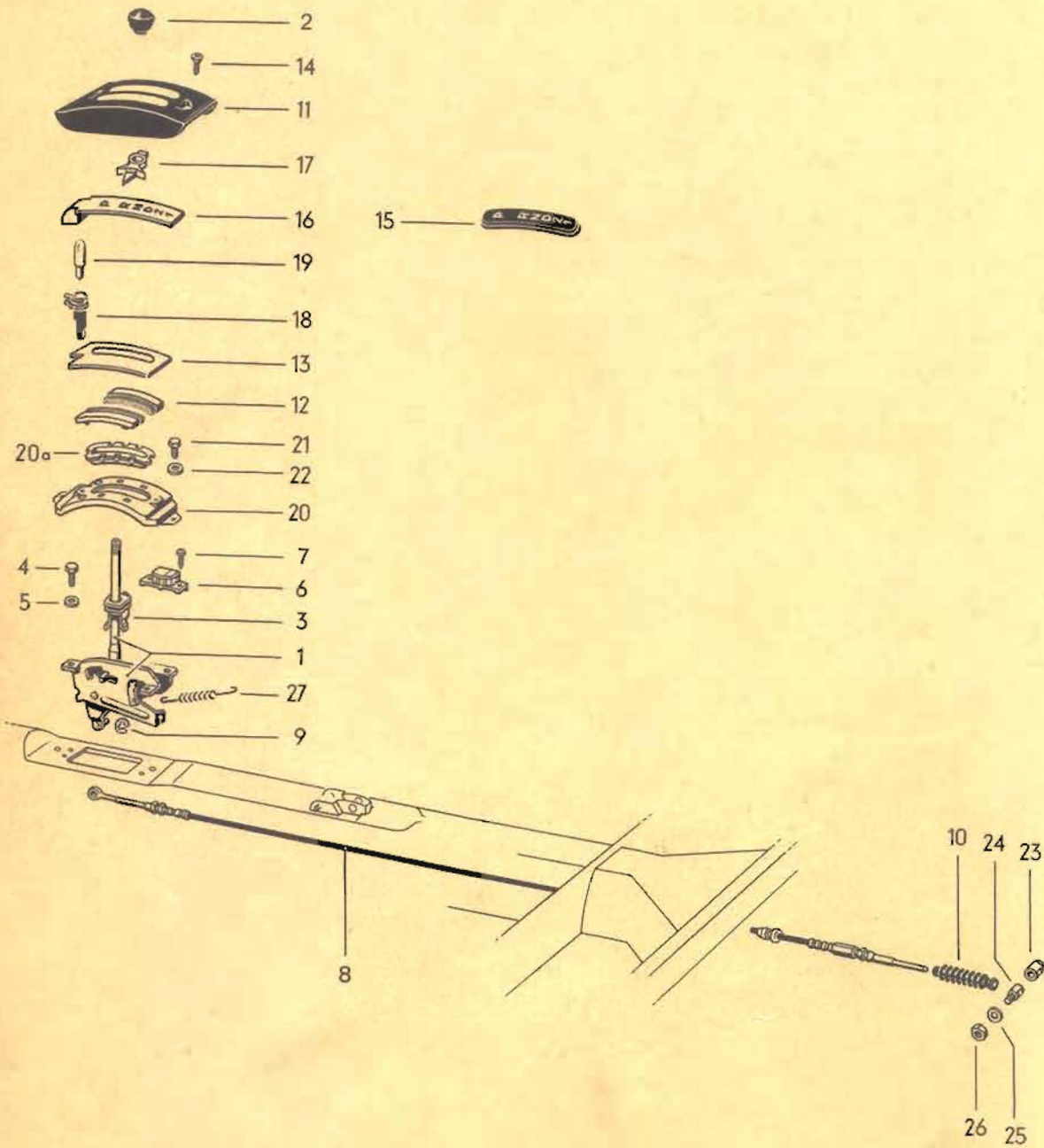

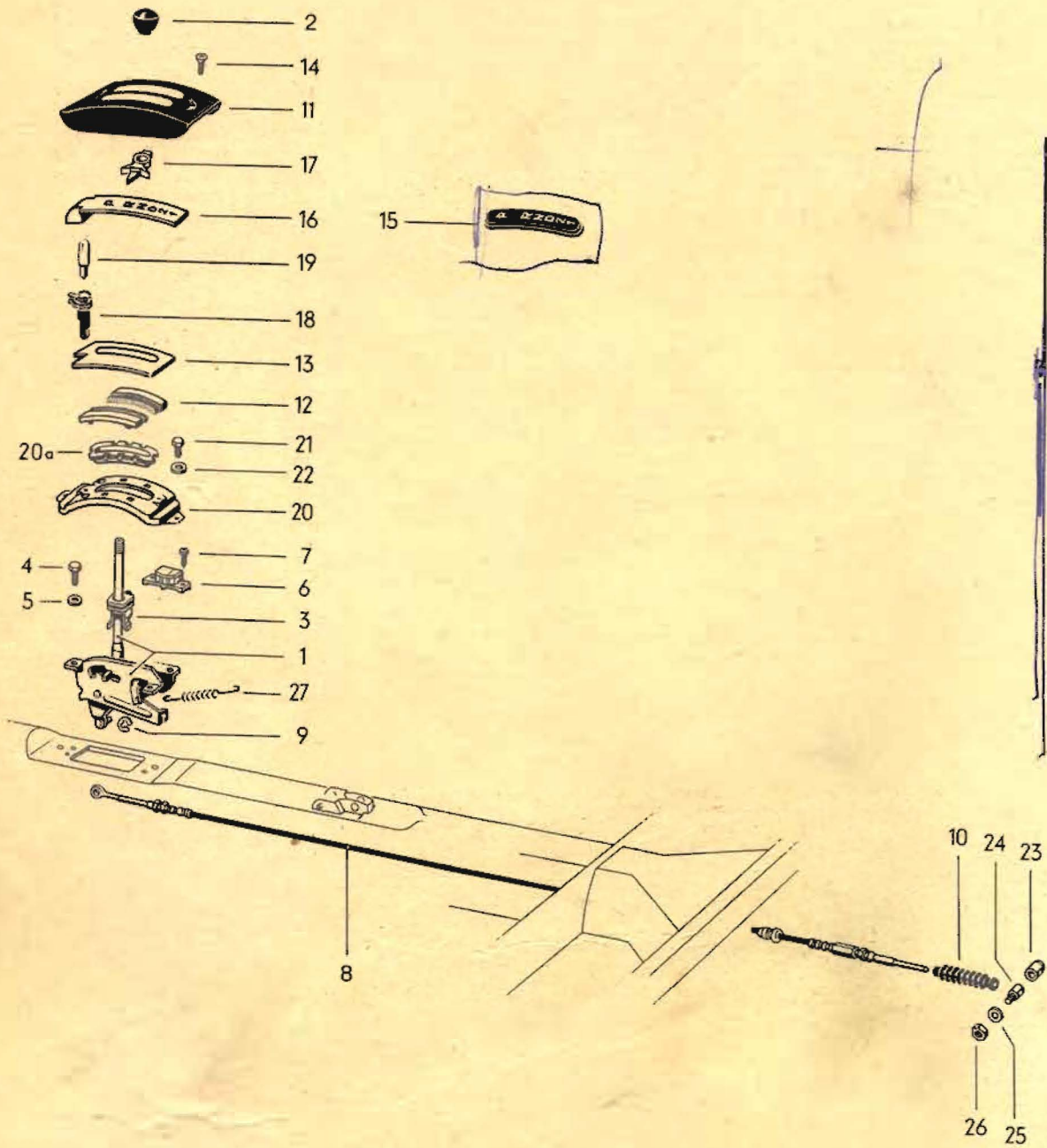

PEDAL CLUSTER

| Key | Part No. | Description | Qty. | Type and model |
|----------------------------------|---------------------------------|--|------|----------------|
| HANDS CONTROL (AUTOMATIC) | | | | |
| | | | | M 249 |
| | from Ch. No. 318 015 226 | | | |
| 1 | 311 713 025 A | Selector mechanism for automatic transmission to Ch. No. 311 2500 000 | 1 | |
| - | 311 713 025 C | Selector mechanism for automatic transmission from Ch. No. 312 2000 001 | 1 | |
| 2 | 141 711 141 D | Knob - Gearshift lever | 1 | |
| 3 | 311 927 145 | *Starter inhibitor switch for selector mechanism | 1 | |
| 4 | N 10 238 7 | Bolt, hex. hd. M 8 x 15 | 3 | |
| 5 | N 12 241 2 | Spring washer B 8 x 15 | 3 | |
| 6 | 311 927 147 | *Contact carrier - Inhibitor switch on selector mechanism to Ch. No. 311 2500 000 | 1 | |
| - | 311 927 147 A | Contact carrier - Inhibitor switch on selector mechanism from Ch. No. 312 2000 001 | 1 | |
| 7 | N 13 968 1 | Tapping screw, fillister hd. B 4.8 x 13 | 2 | |
| 8 | 311 713 265 C | Cable for selector mechanism | 1 | |
| 9 | N 12 434 1 | Lock washer A | 1 | |
| 10 | 311 713 269 A | Boot - Cable | 1 | |
| - | 311 713 273 | Cover for selector mechanism to Ch. No. 310 2500 000 | 1 | |
| 11 | 311 713 273 B | Cover for selector mechanism from Ch. No. 311 2000 001 | 1 | |
| - | 311 713 275 | Cover plate, chrome for selector mechanism | 1 | |
| 12 | 311 713 277 | Brush for selector lever | 2 | |
| 13 | 311 713 279 A | Retainer - Indicator from Ch. No. 311 2000 001 | 1 | |
| 14 | N 14 265 4 | Screw, csk. raised hd. AM 5 x 12 | 2 | |
| 15 | 311 713 283 | Indicator for selector lever to Ch. No. 310 2500 000 | 1 | |
| 16 | 311 927 135 | *Indicator for selector lever from Ch. No. 311 2000 001 | 1 | |
| 17 | | No longer available | | |

| | | | |
|-----|---------------|--|---|
| 18 | 141 957 397 B | *Socket - Bulb from Ch. No. 311 2000 001 | 1 |
| 19 | N 17 751 2 | Bulb JG 12 V 1.2 W | 1 |
| - | 311 713 285 | Cover with guide for selector lever to Ch. No. 310 2500 000 | 1 |
| 20 | 311 713 287 A | Support plate for selector mechanism cover from Ch. No. 311 2000 001 | 1 |
| 20a | 311 713 289 | Guide - Gearshift mechanism from Ch. No. 311 2000 001 | 1 |
| 21 | N 10 210 7 | Bolt, hex. hd. M 6 x 10 K | 2 |
| 22 | N 12 226 2 | Spring washer B 6 | 2 |
| 23 | 311 713 291 | Clamping sleeve for cable | 1 |
| 24 | 311 713 293 | Clamping screw for cable | 1 |
| 25 | N 12 241 2 | Spring washer B 8 x 15 | 1 |
| 26 | N 11 118 1 | Nut, hex. BM 8 | 1 |
| 27 | 311 713 845 A | Spring for selector lever | 1 |



MAIN GROUP 7

FRAME
HAND LEVER SYSTEM
PEDAL CLUSTER

Pedal cluster

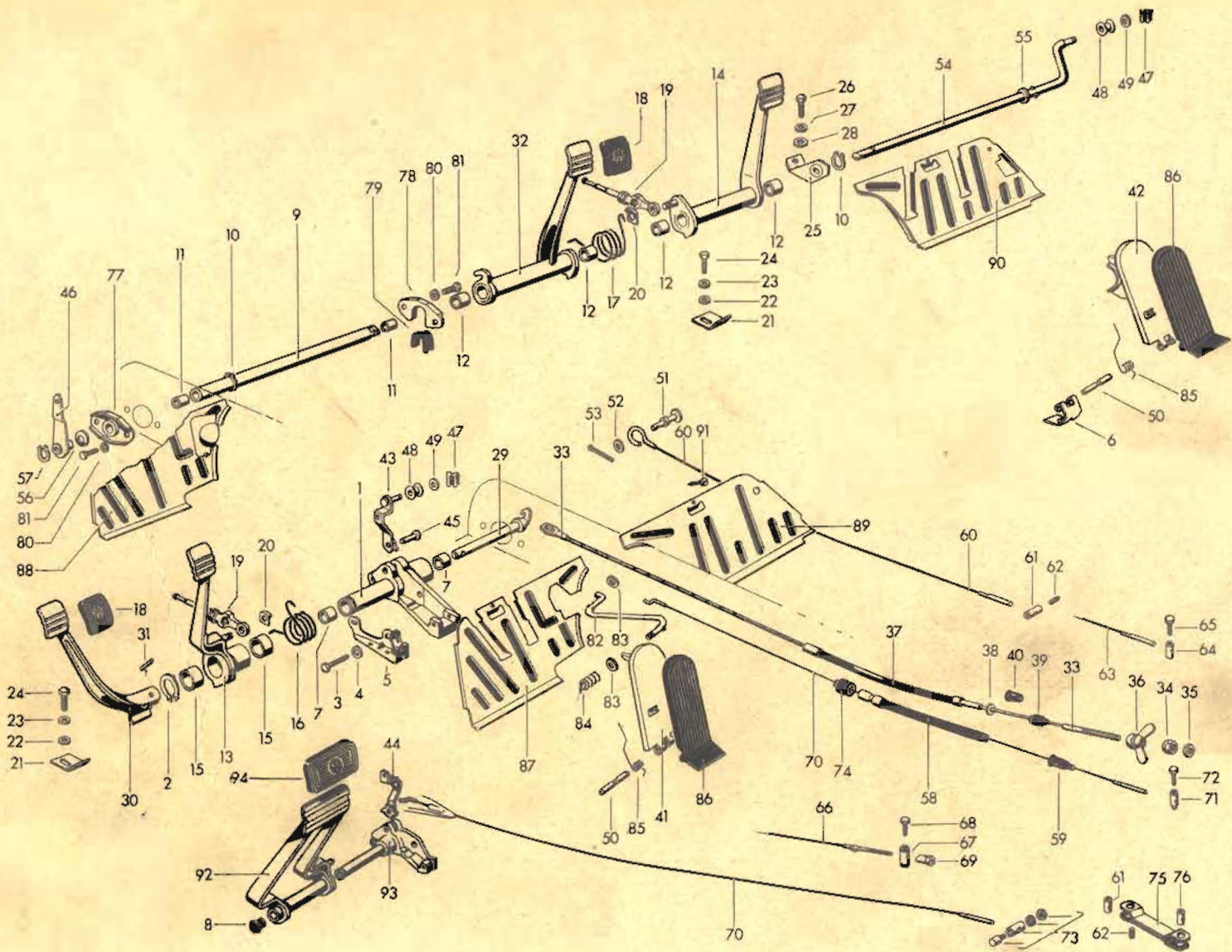

Illustration 31

Type 3

1-20

PEDAL CLUSTER

| Key | Part No. | Description | Qty. | Type and model |
|----------------------|---------------|--|------|---|
| PEDAL CLUSTER | | | | |
| 1 | 113 721 071 C | Pedal bearing | 1 | 311,313,315,317,343, 345,361,363,365,367 |
| 2 | N 12 424 1 | Lockring 24 x 1.2 | 1 | 311,313,315,317,343, 345,361,363,365,367 |
| 3 | N 10 230 3 | Bolt, hex. hd. M 10 x 30 | 2 | |
| 4 | N 12 230 2 | Spring washer B 10 | 2 | 311,313,315,317,343, 345,361,363,365,367 |
| 5 | 311 721 107 | Bracket – Accelerator pedal from Ch. No. 315 048 102 to 316 142 514 | 1 | 311,313,315,317,343, 345,361,363,365,367 |
| – | 312 721 107 | Bracket – Accelerator pedal from Ch. No. 315 048 102 to 316 142 514 | 1 | 312,314,316,318,344, 346,362,364,366,368 |
| 6 | 111 701 535 A | Bracket – Accelerator pedal from Ch. No. 316 142 515 | 1 | 312,314,316,318,344, 346,362,364,366,368 |
| 7 | 311 721 113 | Bush for brake pedal shaft | 2 | 311,313,315,317,343, 345,361,363,365,367 |
| 8 | 113 721 119 | Plug for pedal cluster bearing from Ch. No. 318 015 226 | 2 | M 249 |
| – | 312 721 121 | Mounting tube for pedal cluster to Ch. No. 466 067 | 1 | 312,314,316,318,344, 346,362,364,366,368 |
| 9 | 312 721 121 B | Mounting tube for pedal cluster from Ch. No. 466 068 | 1 | 312,314,316,318,344, 346,362,364,366,368 |
| 10 | N 12 418 1 | Lockring 18 x 1.2 | 2 | 312,314,316,318,344, 346,362,364,366,368 |
| 11 | 312 721 127 | Bush for accelerator pedal shaft | 2 | 312,314,316,318,344, 346,362,364,366,368 |
| 12 | 312 721 137 | Bush for brake and clutch pedals | 4 | 312,314,316,318,344, 346,362,364,366,368 |
| – | 311 721 141 | Pedal – Brake to Ch. No. 483 592 | 1 | 311,313,315,317,343, 345,361,363,365,367 |
| – | 311 721 141 A | Pedal – Brake to Ch. No. 483 592 | 1 | 311,313,315,317,343, 345,361,363,365,367 |
| 13 | 131 721 141 | Pedal – Brake from Ch. No. 315 000 001 to 319 195 256 | 1 | 311,313,315,317,343, 345,361,363,365,367 |
| – | 113 721 141 D | Pedal – Brake from Ch. No. 319 195 257 | 1 | 311,313,315,317,343, 345,361,363,365,367 |
| – | 312 721 141 A | Pedal – Brake to Ch. No. 483 592 | 1 | 312,314,316,318,344, 346,362,364,366,368 |
| 14 | 112 721 141 | Pedal – Brake from Ch. No. 315 000 001 | 1 | 312,314,316,318,344, 346,362,364,366,368 |

| | | | | |
|----|---------------|---|---|---|
| 15 | 311 721 153 | Bush for brake pedal | 2 | 311,313,315,317,343, 345,361,363,365,367 |
| - | 311 721 163 | Return spring for brake pedal to Ch. No. 483 592 | 1 | 311,313,315,317,343, 345,361,363,365,367 |
| 16 | 131 721 163 | Return spring for brake pedal from Ch. No. 315 000 001 | 1 | 311,313,315,317,343, 345,361,363,365,367 |
| - | 312 721 163 | Return spring for brake pedal to Ch. No. 483 592 | 1 | 312,314,316,318,344, 346,362,364,366,368 |
| 17 | 132 721 163 | Return spring for brake pedal from Ch. No. 315 000 001 | 1 | 312,314,316,318,344, 346,362,364,366,368 |
| 18 | 311 721 173 A | Rubber pad for brake and clutch pedals | 2 | |
| - | 113 721 205 J | Push rod for master cylinder to Ch. No. 317 123 354 (only together with 113 611 195 B) | 1 | |
| 19 | 311 721 205 G | Push rod for master cylinder from Ch. No. 317 123 355 | 1 | |
| 20 | N 12 329 1 | Lock washer 9 | 1 | |
| 21 | 113 721 231 D | Stop - Brake pedal to Ch. No. 310 2500 000 | 1 | |
| - | 113 721 231 E | Stop - Brake pedal from Ch. No. 311 2000 001 | 1 | |
| 22 | N 11 654 2 | Washer 9.5 | 1 | |
| 23 | N 12 228 2 | Spring washer B 8 | 1 | |
| 24 | N 10 238 7 | Bolt, hex. hd. M 8 x 15 | 1 | |
| 25 | 312 721 241 | Bracket for pedal cluster | 1 | 312,314,316,318,344, 346,362,364,366,368 |
| 26 | N 10 238 7 | Bolt, hex. hd. M 8 x 15 | 2 | 312,314,316,318,344, 346,362,364,366,368 |
| 27 | 131 821 150 | *Spring washer | 2 | 312,314,316,318,344, 346,362,364,366,368 |
| 28 | N 11 526 2 | Washer B 8.4 | 2 | 312,314,316,318,344, 346,362,364,366,368 |
| - | 113 721 305 A | Shaft - Clutch pedal to Ch. No. 466 067 | 1 | 311,313,315,317,343, 345,361,363,365,367 |
| 29 | 113 721 305 B | Shaft - Clutch pedal from Ch. No. 466 068 to August 1971 | 1 | 311,313,315,317,343, 345,361,363,365,367 |
| | | from Ch. No. September 1971 | 1 | M 263: 361,363,365,367 |
| - | 111 721 305 B | Shaft - Clutch pedal from Ch. No. September 1971 | 1 | 311,313,315,317, 361,363,365,367 |

| | | | | |
|----|---------------|---|---|---|
| 30 | 113 721 315 C | Pedal - Clutch | 1 | 311, 313, 315, 317, 343, 345, 361, 363, 365, 367 |
| 31 | N 12 834 1 | Grooved pin, self-locking 6 x 30 | 1 | 311, 313, 315, 317, 343, 345, 361, 363, 365, 367 |
| - | 312 721 315 | Pedal - Clutch to Ch. No. 466 067 | 1 | 312, 314, 316, 318, 344, 346, 362, 364, 366, 368 |
| - | 312 721 315 A | Pedal - Clutch from Ch. No. 466 068 to 319 195 256 | 1 | 312, 314, 316, 318, 344, 346, 362, 364, 366, 368 |
| 32 | 312 721 315 B | Pedal - Clutch from Ch. No. 319 195 257 to August 1971 | 1 | 312, 314, 316, 318, 344, 346, 362, 364, 366, 368 |
| | | from Ch. No. September 1971 | 1 | M 263: 362, 364, 366, 368 |
| - | 312 721 315 C | Pedal - Clutch from Ch. No. September 1971 | 1 | 312, 314, 316, 318, 362, 364, 366, 368 |
| - | 311 721 335 | Cable - Clutch (length 2333 mm - 91 27/32 in.) to Ch. No. 315 125 560 | 1 | |
| 33 | 311 721 335 A | Cable - Clutch (length 2333 mm - 91 27/32 in.) from Ch. No. 315 125 561 | 1 | |
| 34 | 111 721 349 A | Adjusting nut M 7 for clutch cable to Ch. No. 315 158 979 | 1 | |
| 35 | N 11 007 1 | Nut, hex. M 7 | 1 | |
| 36 | 131 721 349 | Wing nut for clutch cable from Ch. No. 315 158 980 | 1 | |
| 37 | 311 721 361 | Sleeve - Clutch cable | 1 | |
| 38 | 111 513 479 | *Washer 12.1 x 23 | X | |
| 39 | 311 721 363 | Rubber sleeve for clutch cable from Ch. No. 318 000 001 | 1 | |
| 40 | 111 721 365 | Rubber sleeve for clutch cable to Ch. No. 317 500 000 | 1 | |
| - | 311 721 507 | Pedal - Accelerator to Ch. No. 315 048 101 | 1 | 311, 313, 315, 317, 343, 345, 361, 363, 365, 367 |
| 41 | 111 721 507 E | Pedal - Accelerator from Ch. No. 315 048 102 | 1 | 311, 313, 315, 317, 343, 345, 361, 363, 365, 367 |
| - | 111 721 507 B | Pedal - Accelerator to Ch. No. 315 048 101 | 1 | 312, 314, 316, 318, 344, 346, 362, 364, 366, 368 |
| 42 | 112 721 505 A | *Pedal - Accelerator (remove full throttle stop) from Ch. No. 315 048 102 | 1 | 312, 314, 316, 318, 344, 346, 362, 364, 366, 368 |
| - | 311 721 509 | Lever - Accelerator cable connecting to Ch. No. 315 048 101 | 1 | 311, 313, 315, 317, 343, 345, 361, 363, 365, 367 |
| 43 | 311 721 509 A | Lever - Accelerator cable connecting from Ch. No. 315 048 102 | 1 | 311, 313, 315, 317, 343, 345, 361, 363, 365, 367 |
| 44 | 311 721 509 D | Lever - Accelerator cable connecting from Ch. No. 318 015 226 | 1 | M 249: 311, 313, 343, 345, 361, 363 |

| | | | | |
|----|---------------|--|---|--|
| 45 | 111 721 517 | *Pin 8 x 18 for accelerator cable lever | 1 | 311, 313, 315, 317, 343, 345, 345, 361, 363, 365, 367 |
| 46 | 112 721 509 A | Lever - Accelerator cable connecting | 1 | 312, 314, 316, 318, 344, 346, 362, 364, 366, 368 |
| 47 | 311 721 519 | Lock washer - Roller from Ch. No. 315 048 102 | 1 | |
| 48 | 311 721 521 | Roller - Accelerator pedal from Ch. No. 315 048 102 | 1 | |
| 49 | N 11 557 2 | Washer 6.4 | 2 | |
| 50 | 111 721 525 A | Bolt - Accelerator pedal mounting | 1 | |
| 51 | 111 721 529 A | Bolt front for accelerator cable to Ch. No. 315 048 101 | 1 | 312, 314, 316, 318, 344, 346, 362, 364, 366, 368 |
| 52 | N 11 651 1 | Washer 5.8 | 1 | 312, 314, 316, 318, 344, 346, 362, 364, 366, 368 |
| 53 | N 12 512 1 | Cotter pin 2 x 12 | 1 | 312, 314, 316, 318, 344, 346, 362, 364, 366, 368 |
| 54 | 312 721 539 A | Accelerator pedal shaft from Ch. No. 315 048 102 | 1 | 312, 314, 316, 318, 344, 346, 362, 364, 366, 368 |
| - | 312 721 545 A | Accelerator pedal shaft to Ch. No. 315 048 101 | 1 | 312, 314, 316, 318, 344, 346, 362, 364, 366, 368 |
| 55 | N 11 526 2 | Washer B 8.4 | 1 | 312, 314, 316, 318, 344, 346, 362, 364, 366, 368 |
| 56 | 114 721 699 | *Spring washer 13 x 24 for accelerator pedal shaft | 1 | 312, 314, 316, 318, 344, 346, 362, 364, 366, 368 |
| 57 | N 12 408 1 | Lockring 8 x 0.8 | 1 | 312, 314, 316, 318, 344, 346, 362, 364, 366, 368 |
| 58 | 311 721 551 A | Protective tube for accelerator cable | 1 | |
| 59 | 311 721 573 | *Grommet - Protective tube | 1 | |
| 60 | 311 721 555 | Cable - Accelerator (length 2525 mm - 99 13/32 in.) to Ch. No. 315 048 101 | 1 | |
| 61 | 111 129 921 | Bolt, rear for accelerator cable to Ch. No. 315 048 101 | 1 | |
| 62 | N 10 205 2 | Bolt, hex. hd. M 5 x 10 | 1 | |
| 63 | 311 721 555 C | Cable - Accelerator (length 2510 mm - 98 13/18 in.) from Ch. No. 315 048 102 to 315 220 883 | 1 | |
| - | | from Ch. No. 316 000 001 | 1 | 315-318, 365-368: M 3 |
| - | 111 129 921 | Bolt, rear for accelerator cable from Ch. No. 315 048 102 to 315 220 883 | 1 | |
| - | N 10 205 2 | Bolt, hex. hd. M 5 x 10 | 1 | |

| | | | | |
|----|---------------|---|--------|---|
| 64 | 311 129 777 | Bolt, rear for accelerator cable from Ch. No. 316 000 001 | 1 | 315-318, 365-368: M 3 |
| 65 | N 10 205 2 | Bolt, hex. hd. M 5 x 10 | 1 | 315-318, 365-368: M 3 |
| 66 | 311 721 555 F | Cable - Accelerator, 2610 mm end piece with thread from Ch. No. 318 000 001 | 1 | M 236: M 236 / M 249 |
| 67 | 311 133 139 | Pin, rear for accelerator cable from Ch. No. 318 000 001 | 1 | M 236: M 236 / M 249 |
| 68 | N 10 205 2 | Bolt, hex. hd. M 5 x 10 | 1 | M 236 |
| 69 | 311 133 149 | Adjusting nut for accelerator cable from Ch. No. 318 015 226 | 1 | M 236 / M 249 |
| 70 | 311 721 555 G | Accelerator cable 2670 mm from Ch. No. 316 000 001 from Ch. No. 318 015 226 | 1 1 | M 311-314, 343-346, 361-364 M 249 |
| 71 | 311 129 859 | Pin - Accelerator cable from Ch. No. 316 000 001 | 1 | 311-314, 343-346, 361-364 |
| 72 | N 10 205 2 | Bolt, hex. hd. M 5 x 10 | 1 | 311-314, 343-346, 361-364 |
| 73 | 311 798 101 | 1 set of mounting components for accelerator cable from Ch. No. 318 015 226 | 1 | M 249 |
| 74 | 311 721 579 | Grommet for accelerator cable from Ch. No. 318 000 001 | 1 | |
| 75 | 311 129 925 | Link for accelerator cable from Eng. No. 255 340 to 1 100 000 | 1 | 311-314, 343-346, 361-364 |
| 76 | 311 129 929 | Bolt - Link from Eng. No. 255 340 to 1 100 000 | 1 | 311-314, 343-346, 361-364 |
| 77 | 114 721 585 | Bearing for mounting tube | 1 | 312, 314, 316, 318, 344, 346, 362, 364, 366, 368 |
| 78 | 312 721 587 | Cover plate for mounting tube | 1 | 312, 314, 316, 318, 344, 346, 362, 364, 366, 368 |
| 79 | 312 721 591 | Seal for cover plate | 1 | |
| 80 | N 12 230 2 | Spring washer B 10 | 4 | 312, 314, 316, 318, 344, 346, 362, 364, 366, 368 |
| 81 | N 10 249 1 | Bolt, hex. hd. M 10 x 15 | 4 | 312, 314, 316, 318, 344, 346, 362, 364, 366, 368 |
| 82 | 111 721 615 | Push rod for accelerator pedal to Ch. No. 315 048 101 | 1 | |
| 83 | N 11 557 2 | Washer 6.4 | 2 | |

| | | | | |
|----|---------------|---|---|---|
| 84 | 211 721 617 | Spring for accelerator pedal push rod to Ch. No. 315 048 101 | 1 | |
| 85 | 111 721 619 | Return spring for accelerator pedal to Ch. No. 315 048 101 | 1 | |
| | | from Ch. No. 317 000 001 | 1 | |
| - | 311 721 619 | Return spring for accelerator pedal from Ch. No. 315 048 102 to 316 500 000 | 1 | |
| 86 | 113 721 647 A | Rubber pad for accelerator pedal | 1 | |
| 87 | 311 721 671 A | Foot support, left | 1 | 311,313,315,317,343, 345,361,363,365,367 |
| 88 | 312 721 671 A | Foot support, left | 1 | 312,314,316,318,344, 346,362,364,366,368 |
| 89 | 311 721 672 A | Foot support, right | 1 | 311,313,315,317,343, 345,361,363,365,367 |
| - | 312 721 672 A | Foot support, right to Ch. No. 319 195 256 | 1 | 312,314,316,318,344, 346,362,364,366,368 |
| 90 | 312 721 672 B | Foot support, right from Ch. No. 319 195 257 | 1 | 312,314,316,318,344, 346,362,364,366,368 |
| 91 | N 11 380 1 | Tapping screw, cheese hd. B 4.2 x 9.5 | 2 | |
| - | 311 723 053 | Brake pedal from Ch. No. 318 015 226 to 319 111 029 | 1 | M 249: 311,313,343, 345,361,363 |
| 92 | 311 723 053 A | Brake pedal from Ch. No. 319 111 030 to 310 2500 000 | 1 | M 249: 311,313,343, 345,361,363 |
| - | 113 723 053 | Brake pedal from Ch. No. 311 2000 001 | 1 | M 249: 311, 313, 361, 363 |
| - | 312 723 053 | Brake pedal from Ch. No. 318 015 226 | 1 | M 249: 312,314,344, 346,362,364 |
| 93 | 311 723 071 | Pedal cluster bearing from Ch. No. 318 015 226 | 1 | M 249: 311,313,343, 345,361,363 |
| - | 312 723 119 | Mounting tube - Pedal cluster from Ch. No. 318 015 226 | 1 | M 249: 312,314,344, 346,362,364 |
| 94 | 311 723 173 | Rubber pad - Brake pedal from Ch. No. 318 015 226 to 310 2500 000 | 1 | M 249 |
| | | from Ch. No. 311 2000 001 | 1 | M 249: 312, 314, 362, 364 |
| - | 311 723 173 A | Rubber pad - Brake pedal from Ch. No. 311 2000 001 | 1 | M 249: 311, 313, 361, 363 |
| - | 311 723 671 | Foot support, left from Ch. No. 318 015 226 | 1 | M 249: 311,313,343, 345,361,363 |
| - | 312 723 672 | Foot support, right from Ch. No. 318 015 226 | 1 | M 249: 312,314,344, 346,362,364 |

MAIN GROUP 7

| Part No. | Description | Qty. |
|----------------------|---|------|
| REPAIR KITS | | |
| 311 798 001 | 1 set of installation parts | |
| | for frame 311 700 021 AA; 361 700 021 AA | |
| | to Ch. No. 483 592 | |
| | comprising: | |
| 311 255 461 | Heater pipe – Defroster vent, center | 1 |
| 311 255 476 C | Defroster vent, right | 1 |
| 111 701 535 A | Bracket – Accelerator pedal | 1 |
| 113 721 205 L | Push rod – Master cylinder | 1 |
| N 12 329 1 | Lock washer 9 | 1 |
| 113 721 305 B | Shaft – Clutch pedal | 1 |
| 111 857 781 A | Escutcheon – Safety belt mounting on frame | 2 |
| 111 857 785 | Cover bush – Safety belt mounting | 2 |
| 312 798 001 | 1 set of installation parts | |
| | for frame 312 700 021 L; 362 700 021 M | |
| | to Ch. No. 483 592 | |
| | comprising: | |
| 311 255 461 | Heater pipe – Defroster vent, center | 1 |
| 311 255 475 C | Defroster vent, left | 1 |
| 111 701 535 A | Bracket – Accelerator pedal | 1 |
| 312 721 121 B | Mounting tube – Pedal cluster | 1 |
| 113 721 205 L | Push rod – Master cylinder | 1 |
| N 12 329 1 | Lock washer 9 | 1 |
| 312 721 315 A | Pedal – Clutch | 1 |
| 111 857 781 A | Escutcheon – Safety belt mounting on frame | 2 |
| 111 857 785 | Cover bush – Safety belt mounting | 2 |
| 311 798 011 A | 1 set of installation parts for heater operation | |
| | to Ch. No. 316 500 000 | |
| | comprising: | |
| 111 701 309 | Water drain valve – Tunnel plate | 1 |
| 131 711 339 | Ratchet – Hand brake | 1 |
| 131 711 665 | Stop – Lever | 2 |
| 111 711 691 | Plug | 2 |
| 311 711 707 C | Heating control cable | 1 |
| 111 711 711 A | Lever, left | 1 |
| 111 711 712 | Lever, right | 1 |
| 311 711 713 A | Cable – Foot well heating rear | 1 |
| 131 711 741 B | Knob – Lever | 2 |
| | 043 grey-black | |
| 111 711 749 A | Friction plate | 4 |
| 111 863 339 A | Rubber boot – Hand brake lever | 1 |
| | 041 black | |
| N 11 118 1 | Nut, hex. BM 8 | 2 |
| N 12 162 1 | Concave washer B 16 | 2 |
| | replace | |
| | 311 711 707 C by 311 711 707 D | |
| | to Ch. No. 315 048 101 | |

311 798 101

1 set of mounting components for accelerator cable

from Ch. No. 318 015 226: M 249

comprising:

| | | |
|------------|-------------------|---|
| | Bush | 1 |
| | Bolt | 1 |
| N 12 226 2 | Spring washer B 6 | 1 |
| N 11 116 1 | Nut, hex. BM 6 | 1 |